

Environment Publish

Environment=500mm



Environment Computation Specification		
Products Selected		
ATCNSE__0004 - DRAIN PIPE FOR - LAR END-CAP CALORIMETER	NFH__0009 - HS METALLIC STRUCTURE - SIDE USA15 - LEVEL +2,77M EXTENSION	254.8
	VHB__0002 - STANDARD PAIR OF FEET A1 (C1) - DETAILED MODEL FOR STANDARDS	189.8
	VHB__0003 - STANDARD PAIR OF FEET A2 (C2) - DETAILED MODEL FOR STANDARDS	171
	VHB__0004 - STANDARD PAIR OF FEET A3 (C3) - DETAILED MODEL FOR STANDARDS	179

Computation Result:

Products Selected

ATCNSE_0004 - DRAIN PIPE FOR - LAR END-CAP CALORIMETER	VHB_0005 - EXTREMITY PAIR OF FEET A4 (C4) - DETAILED MODEL FOR STANDARDS	101.6
	VHB_0008 - FOOT B WITH BRACKET HOLES - MAIN BOLTS AND WELDINGS	189.8
	ATCVHB_0002 M - STANDARD PAIR OF FEET A1 (C1) - DETAILED MODEL FOR STANDARDS	189.8
	ATCVHB_0003 M - STANDARD PAIR OF FEET A2 (C2) - DETAILED MODEL FOR STANDARDS	171
	ATCVHB_0004 M - STANDARD PAIR OF FEET A3 (C3) - DETAILED MODEL FOR STANDARDS	179
	ATCVHB_0005 M - EXTREMITY PAIR OF FEET A4 (C4) - DETAILED MODEL FOR STANDARDS	101.7
	NH_0001 - HF TRUCK IN ACCESS POSITION SIDE C - SIMPLIFIED 3-D OBJECT	377.6
	NH_0003 - HF TRUCK IN ACCESS POSITION SIDE A - SIMPLIFIED 3D OBJECT	374.7
	NJ_0003 - JD SHIELDING (SIDE C) - WITH TGC MUON CHAMBERS	164
	NMC_0012 - SECTOR 12. BARREL PART. - SIMPLE MUON CHAMBERS	108.3
AT602164MQ - MCB MUON BARREL CHAMBERS DETAILED, SECTOR 12	108.3	
NMC_0017 - MEI, CSC CHAMBERS - SIMPLIFIED 3-D OBJECT	482.7	

Products Selected

ATCNSE_0004 - DRAIN PIPE FOR - LAR END-CAP CALORIMETER	NMC__0018 - SMALL WHEEL (SIDE C) - SIMPLIFIED 3-D OBJECT	482.7
	NMA__0006 - BARREL PROJECTIVE ALIGNMENT. - SIMPLE 3-D MODEL. SECTOR 11.	360.5
	NMA__0009 - END CAP ALIGNMENT SIDE "A". - SIMPLE 3-D MODEL	125.2
	NMA__0010 - END CAP ALIGNMENT SIDE "C" - SIMPLE 3-D MODEL	125.2
	NSB__0007 - BARREL LAR INSULATION LINE - SIMPLIFIED 3D OBJECT	103
	NSE__0005 - LAR END-CAP ELECTRONIC CRATES - SIMPLIFIED 3-D OBJECT	307.7
	NSM__0013 - CONNECTION BOX - FOR TB VACUUM PUMPING SYSTEM	194.3
	NSM__0015 - BT HEATER BOXES AND CABLES - FOR FOOT REGION	157.6
	NSM__0016 - BT HEATER CABLE DISTRIBUTION - FOR FOOT REGION	273.9
	NSR__0009 - CABLE TRAYS IN UX 15 CAVERN - SIDE USA 15	110.8
	NSR__0010 - CABLE TRAY - USA 15 - DISTRIBUTION POINT	348.3
	NSG__0013 - UX 15 - 1/2 CAVERN USA SIDE - COMPRESSED AIR ROUTING	139.9
	ZAE__0001 - AE INDIVIDUAL ENVELOPE SIDE C - AND LOCATION OF INTERFACES	414
	NFX__0010 - N2 EXT TL'S & VBN6 - STANDARD DRAWING	259.8
NFH__0007 - HS METALLIC STRUCTURE - SIDE USA15 - LOWER PART	104.7	



Minimum Distance Publish

Minimum Distance Computation Specification	
Products Selected	
NSE__0004 - DRAIN PIPE FOR - LAR END-CAP CALORIMETER	NMA__0007 - BARREL PROJECTIVE ALIGNMENT. - SIMPLE 3-D MODEL SECTOR 13 - SIDE A-C

Computation Result:

NSE_0004	NMA_0007	Minimum distance	2.2932
----------	----------	------------------	--------

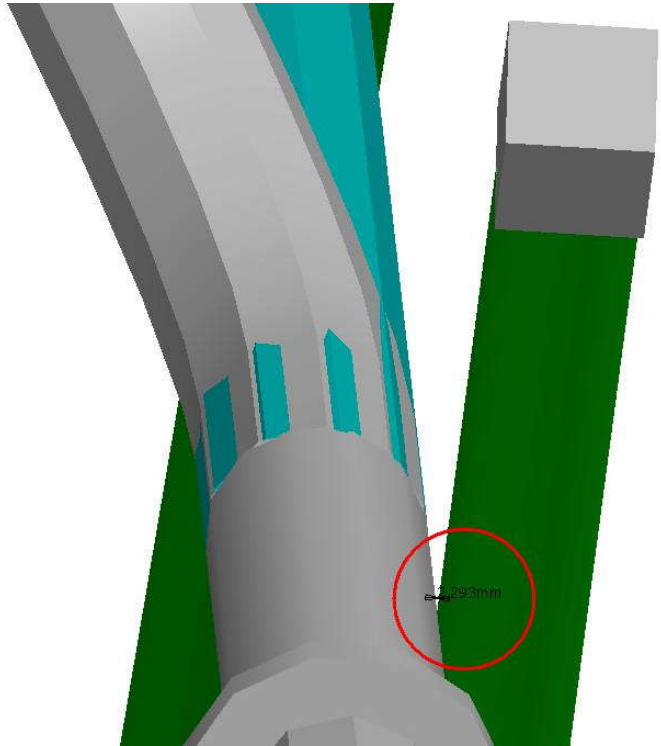
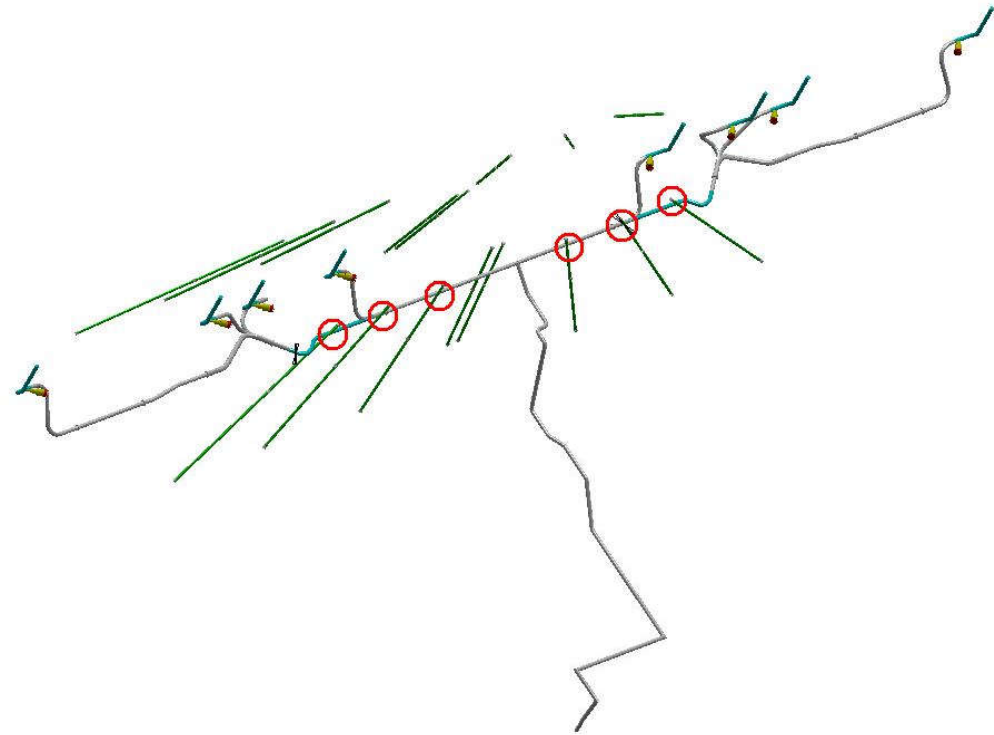

SIDE A-C
Sector 12