



Clearance Publish

Clearance = 50mm

Clearance Computation Specification			
Products Selected		Value	Status
AT732516MQ - FT PIPES (RUN)	NFH_0009 - HS METALLIC STRUCTURE - SIDE USA15 - LEVEL +2,77M EXTENSION	16.8 mm	?
	AT112396MQ - BT HEATER CABLE DISTRIBUTION - FOR FOOT R	30 mm	?
	NLE_0002 - LE END-CAP CALORIMETER - SIDE A	8.6 mm	Not Relevant

Computation Result:

Revised with Denis 27/07/2005

AT732516MQ - FT PIPES (RUN)	NFH_0009 - HS METALLIC STRUCTURE - SIDE USA15 - LEVEL +2,77M EXTENSION	Clearance	16.8 mm			?
			$\Delta X \approx 0$	$\Delta Y \approx 16.8$	$\Delta Z \approx 0$	

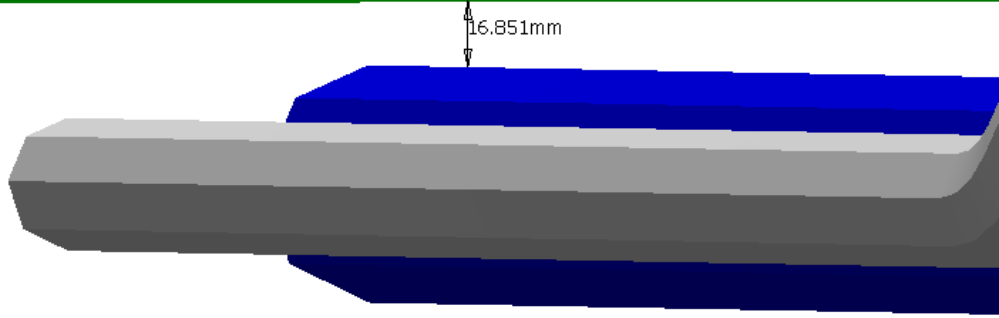
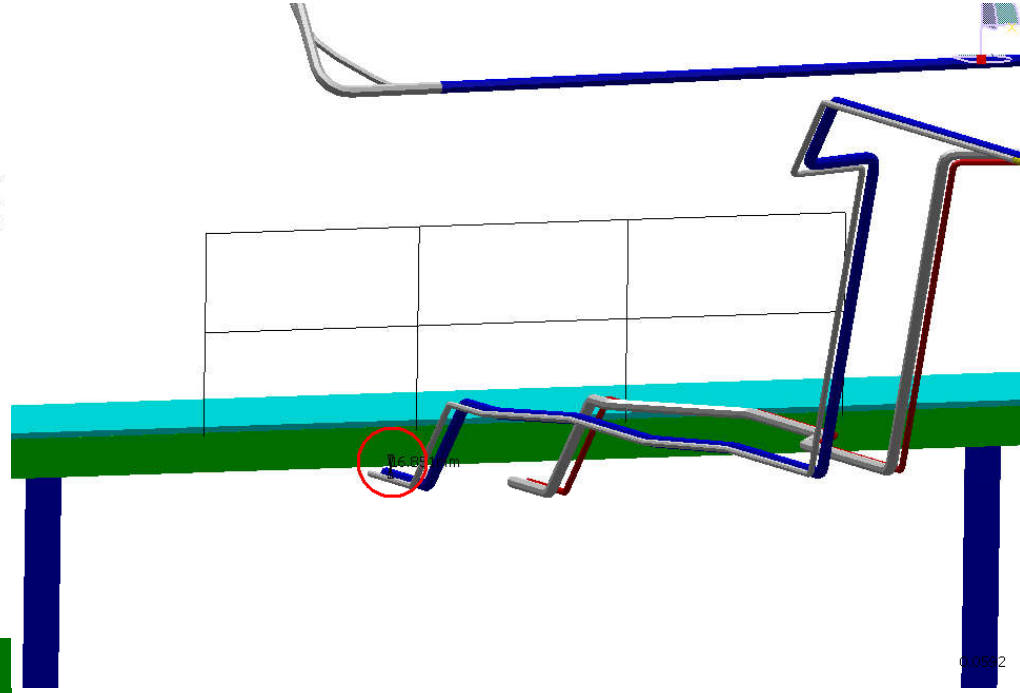
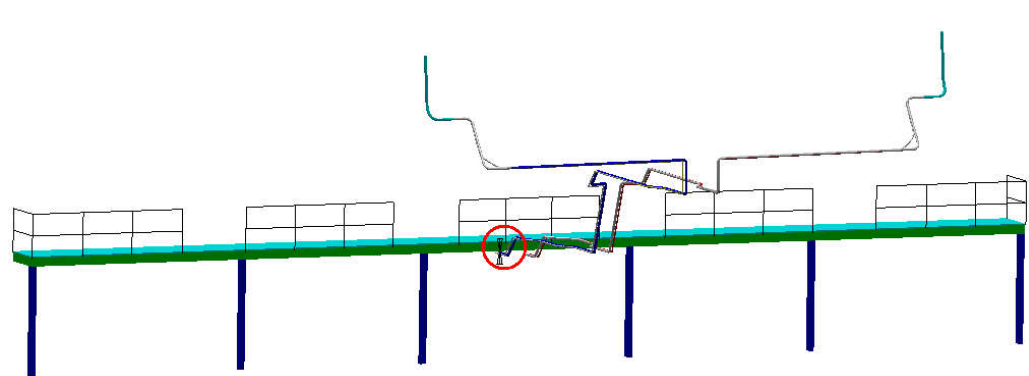

Denis: I don't Know

SIDE A
Sector 11

AT732516MQ - FT PIPES (RUN)	AT112396MQ - BT HEATER CABLE DISTRIBUTION - FOR FOOT R	Clearance	30 mm			Not inspected
			$\Delta X \approx ?$	$\Delta Y \approx ?$	$\Delta Z \approx ?$	

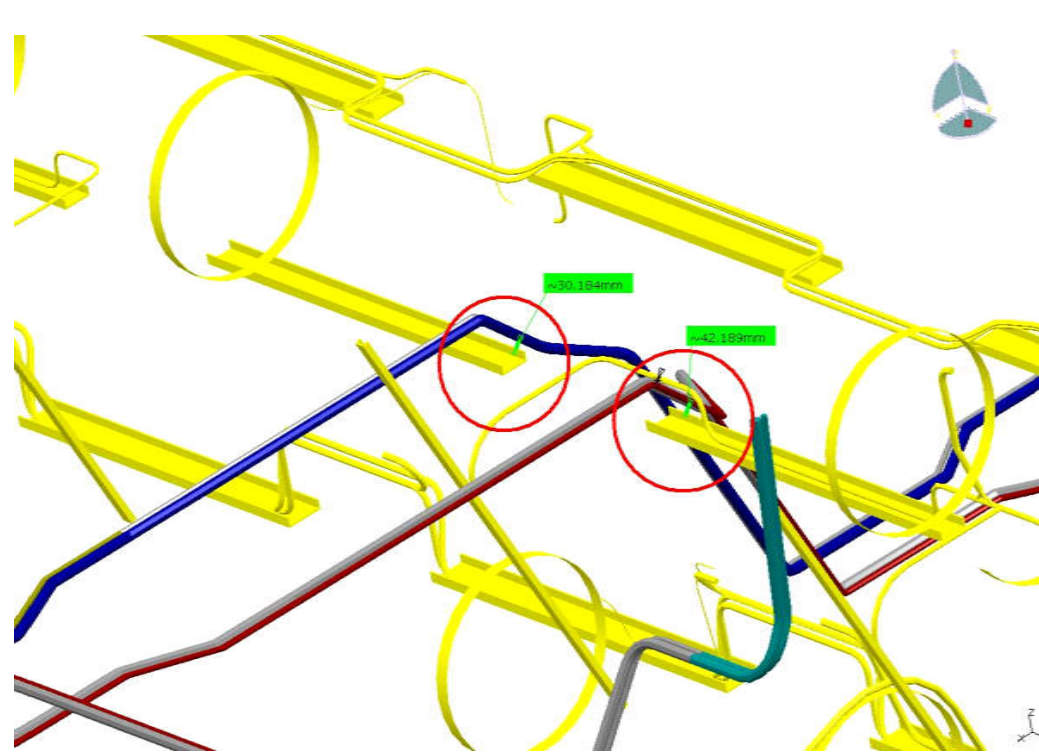
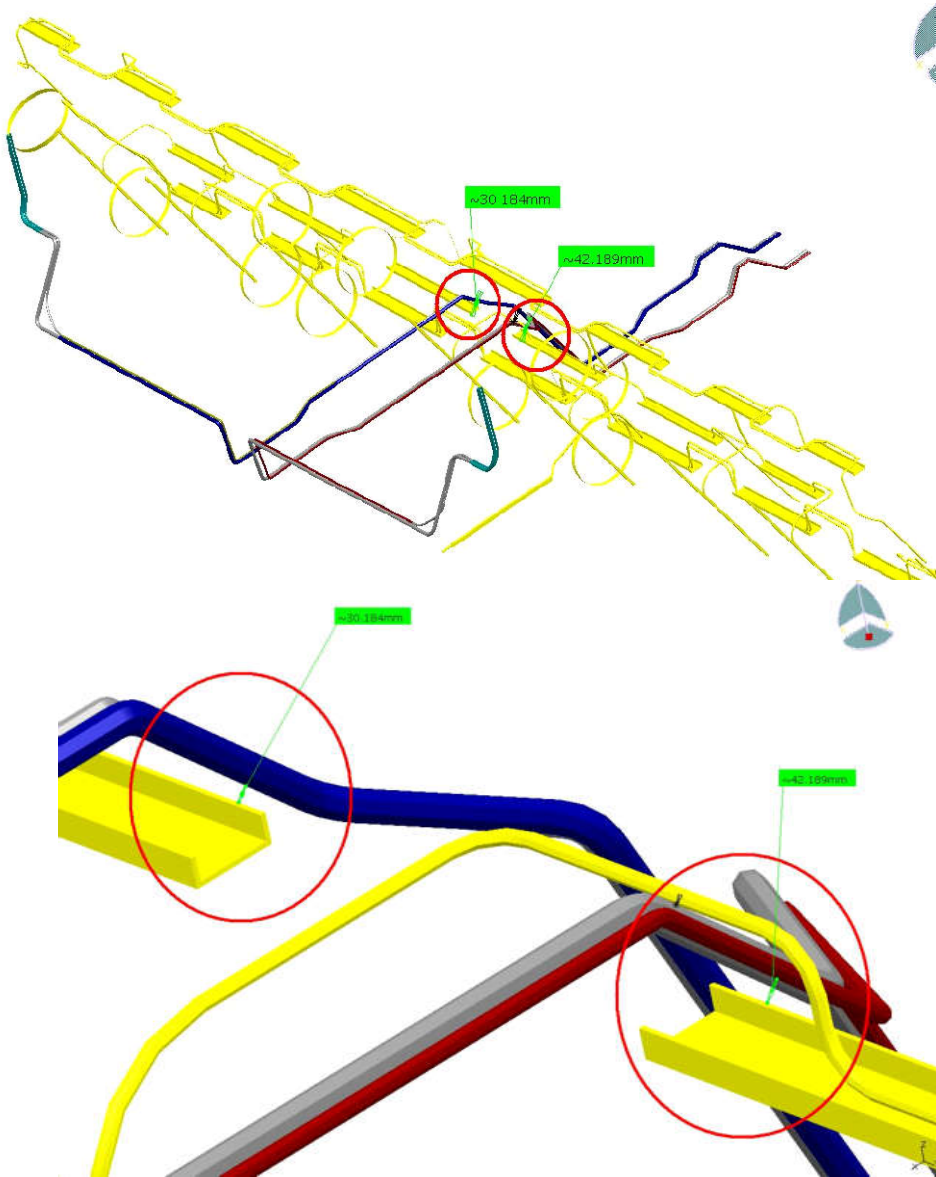

SIDE A
Sector 12

AT732516MQ - FT PIPES
(RUN)

NLE_0002 - LE END-CAP
CALORIMETER - SIDE A

Clearance	8.6 mm		
	$\Delta X \approx 7.7$	$\Delta Y \approx 4$	$\Delta Z \approx 0$

Not Relevant

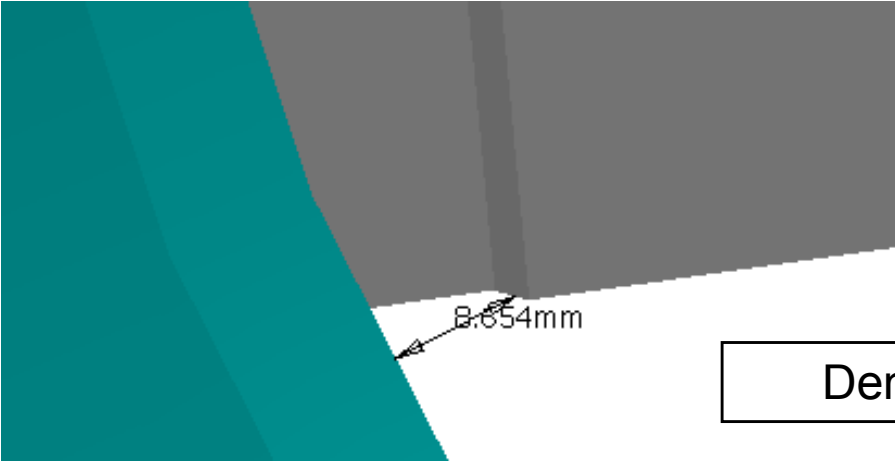
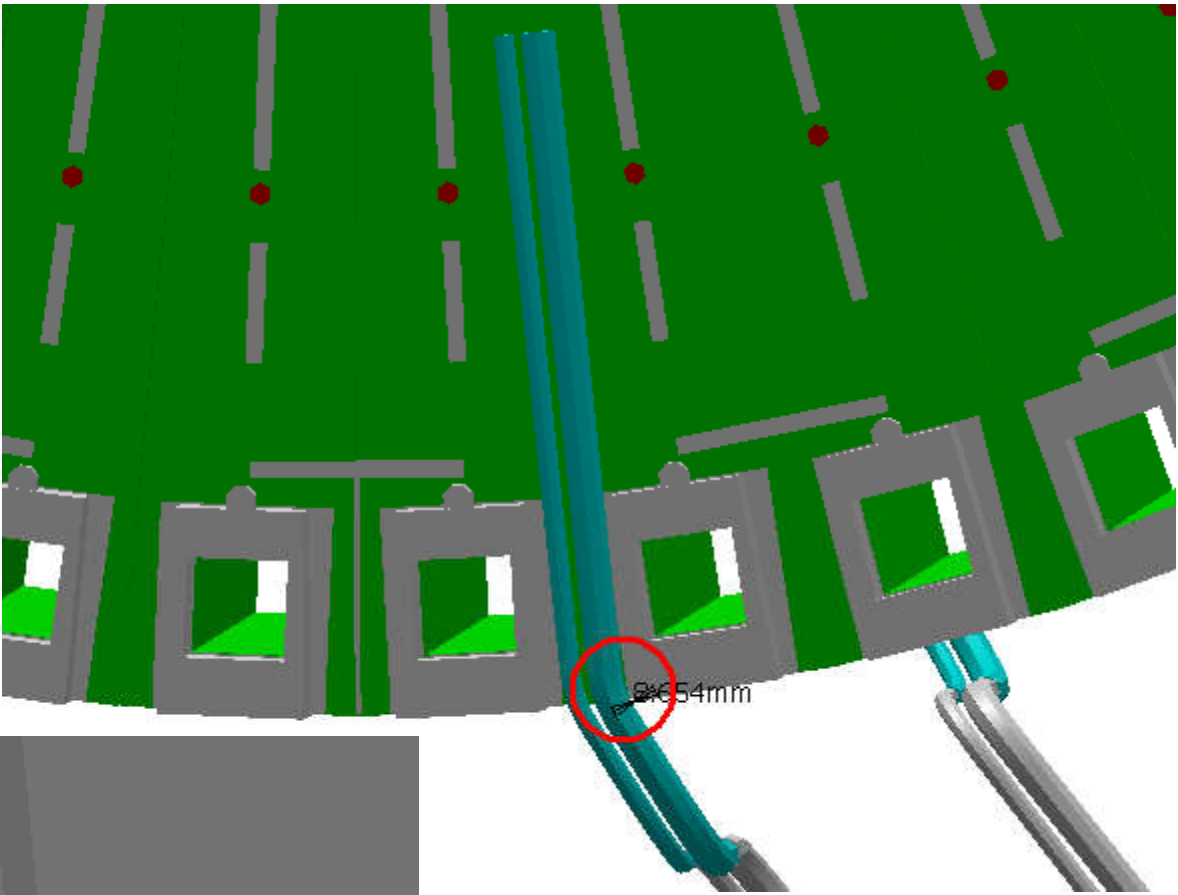
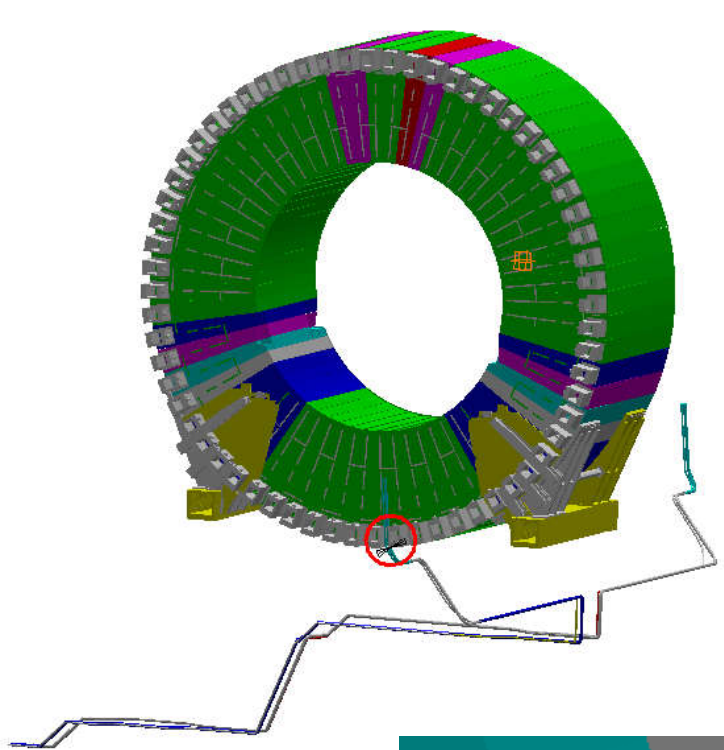

SIDE A
Sector 13

Denis: Pipes fix on calorimeter