



## Clash Publish

Clash Computation Specification			
Products Selected		Value	Status
AT602342MQ - MUON BARREL CHAMBERS DETAILED, SECTOR 16	NMA_0001 - BARREL PROJECTIVE ALIGNMENT. - SIMPLE 3-D MODEL. SECTOR 1	-1.9 mm	Warning
	NMA_0008 - BARREL PROJECTIVE ALIGNMENT. - SIMPLE 3-D MODEL. SECTOR 15	-0.3 mm	Warning
	NMA_0009 - END CAP ALIGNMENT SIDE "A". - SIMPLE 3-D MODEL.	-733.4 mm	Warning
	NMA_0010 - END CAP ALIGNMENT SIDE "C" - SIMPLE 3-D MODEL	-733.8 mm	Warning
	NMA_0018 - SECTOR 16 SIDE C (A) - REFERENCE ALIGNMENT SYSTEM AND	-166.3 mm	Warning
	Z5_0002 - Z5 GLOBAL ENVELOPE (SIDE A) - AND LOCATION INTERFACES	-123.6 mm	Not Relevant
	Z5_0001 - Z5 GLOBAL ENVELOPE (SIDE C) - AND LOCATION INTERFACES *	-123.6 mm	Not Relevant

### Computation Result:

\* Working on new version

# WARNING

AT602342MQ - MUON BARREL  
CHAMBERS DETAILED, SECTOR 16

NMA\_0001 - BARREL PROJECTIVE ALIGNMENT. -  
SIMPLE 3-D MODEL. SECTOR 1

Clash

-1.9 mm

Warning

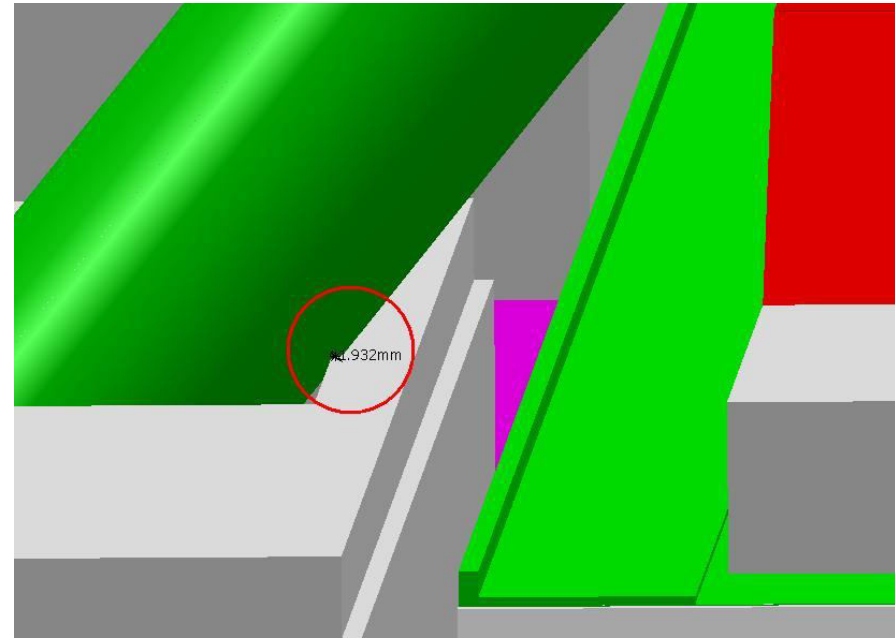
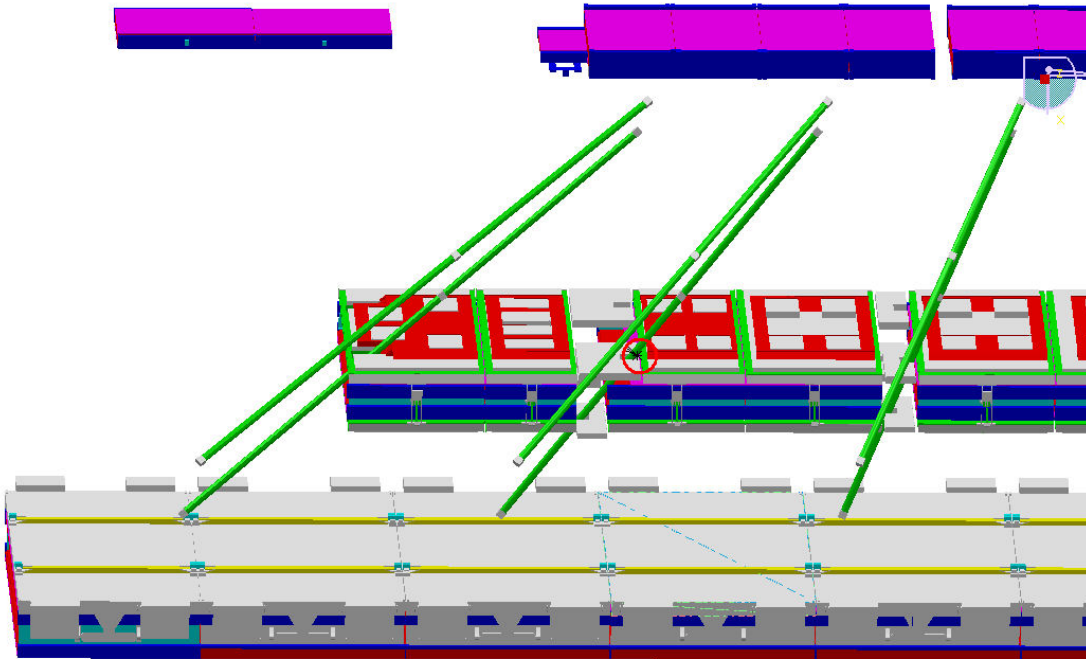

Clash value: ~ 1.9 mm

SIDE A-C

Sector 16

The identical clash exists on the other side

Igor: Clash exists with cable envelope  
(25mm for S2/S3)

# Clash View:

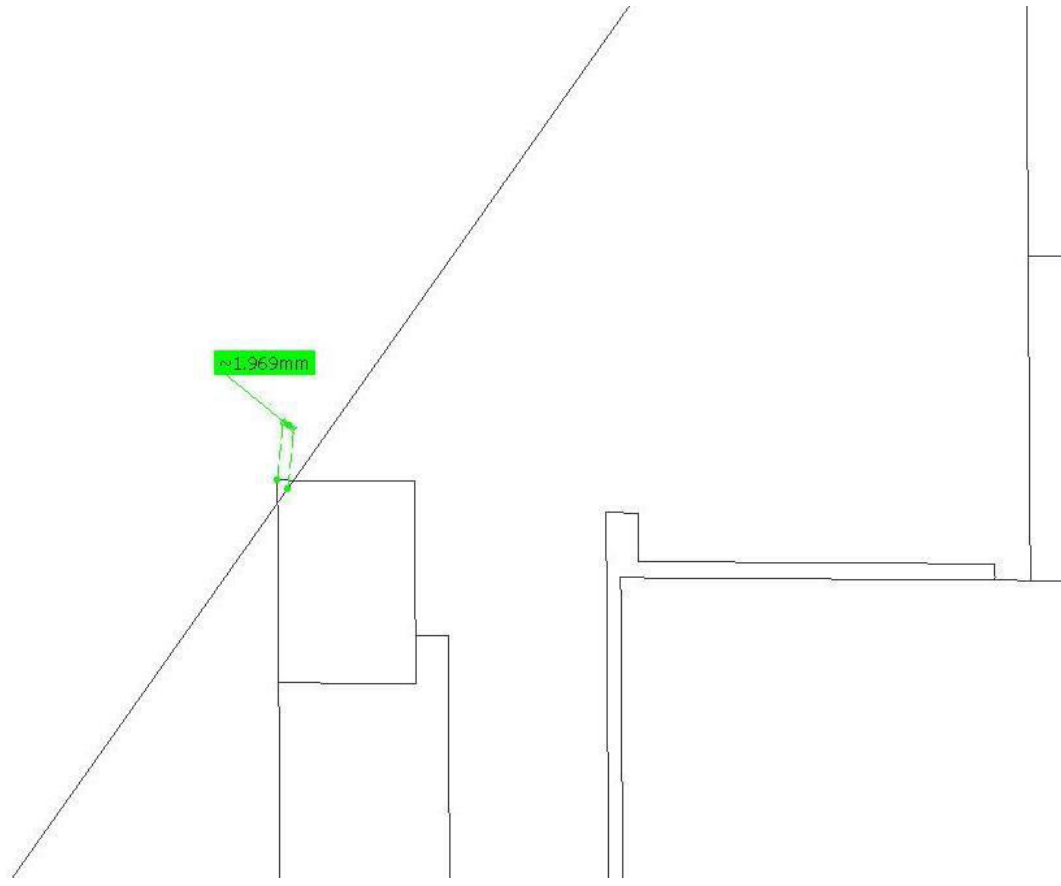
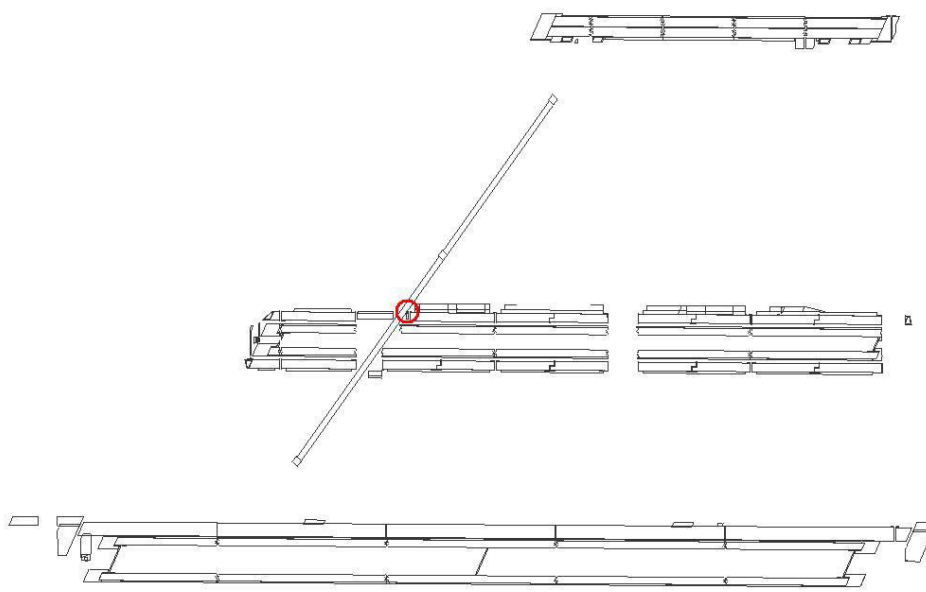
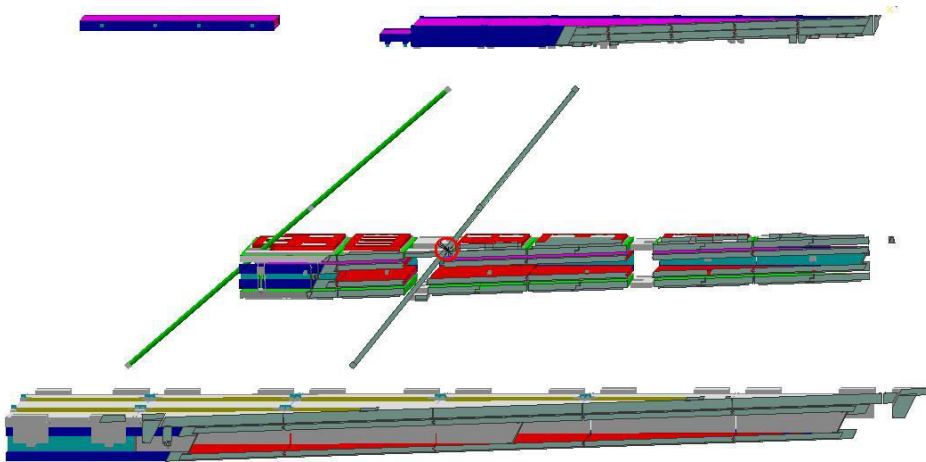

AT602342MQ - MUON BARREL  
CHAMBERS DETAILED, SECTOR 16

NMA\_0008 - BARREL PROJECTIVE ALIGNMENT. -  
SIMPLE 3-D MODEL. SECTOR 15

Clash

-0.3 mm

Warning

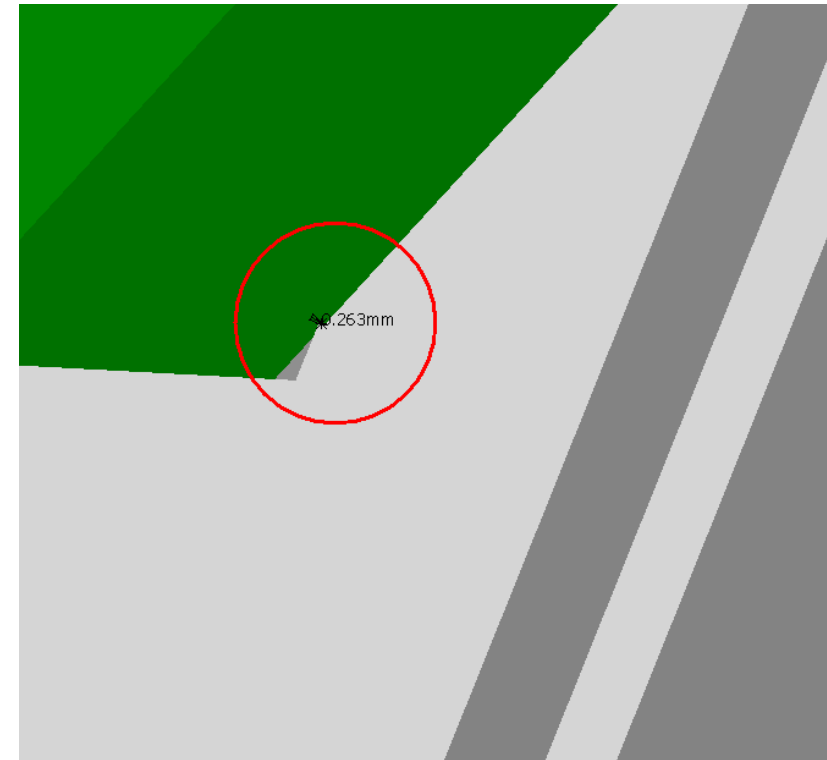
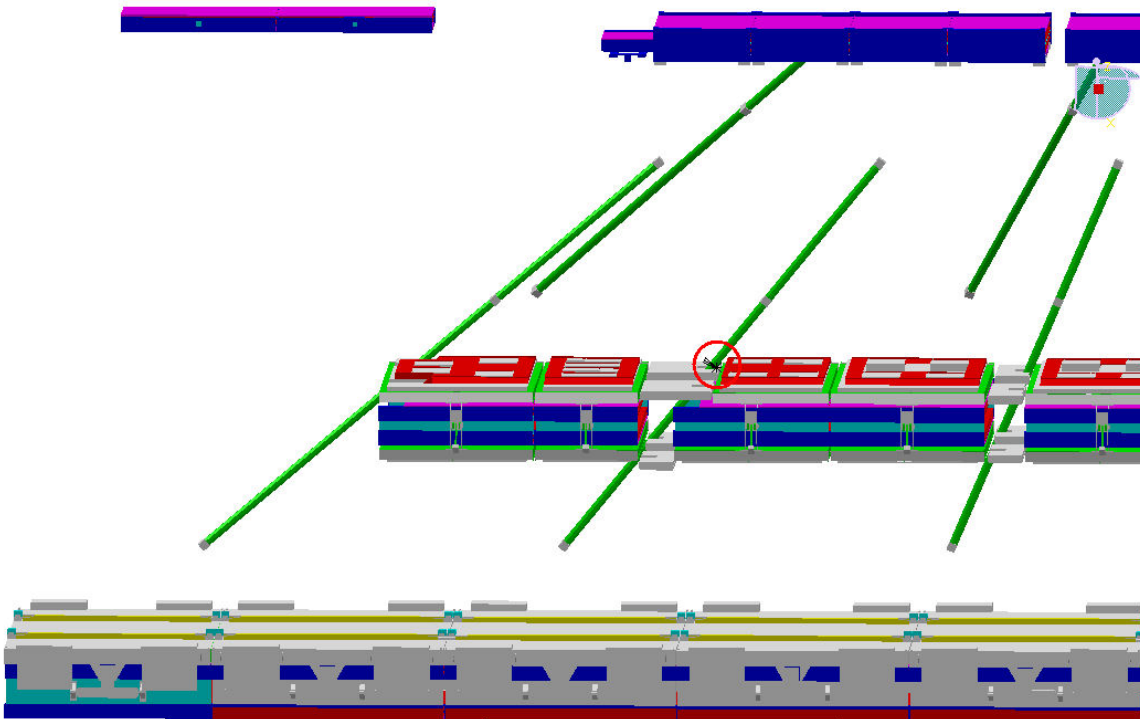

Clash value: ~ 0.3 mm

SIDE A-C

Sector 16

The identical clash exists on the other side

Igor: Clash exists with cable envelope  
(25mm for S2/S3)

# Clash View:

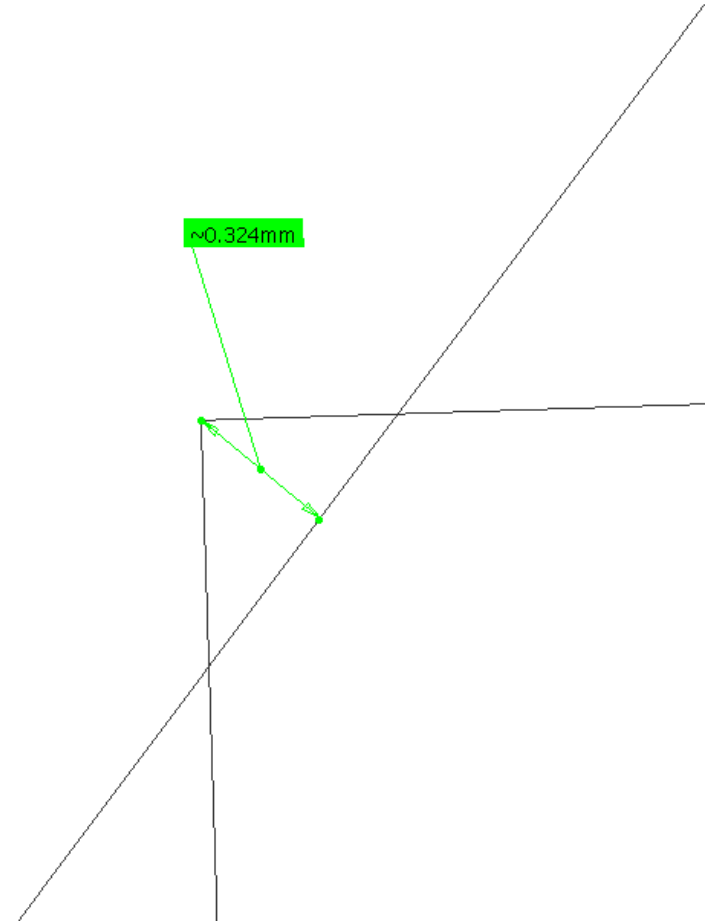
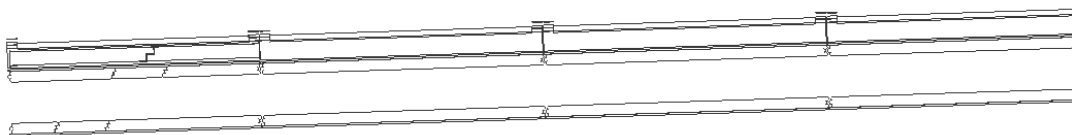
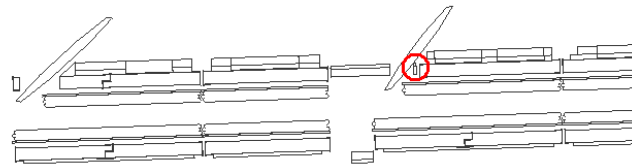
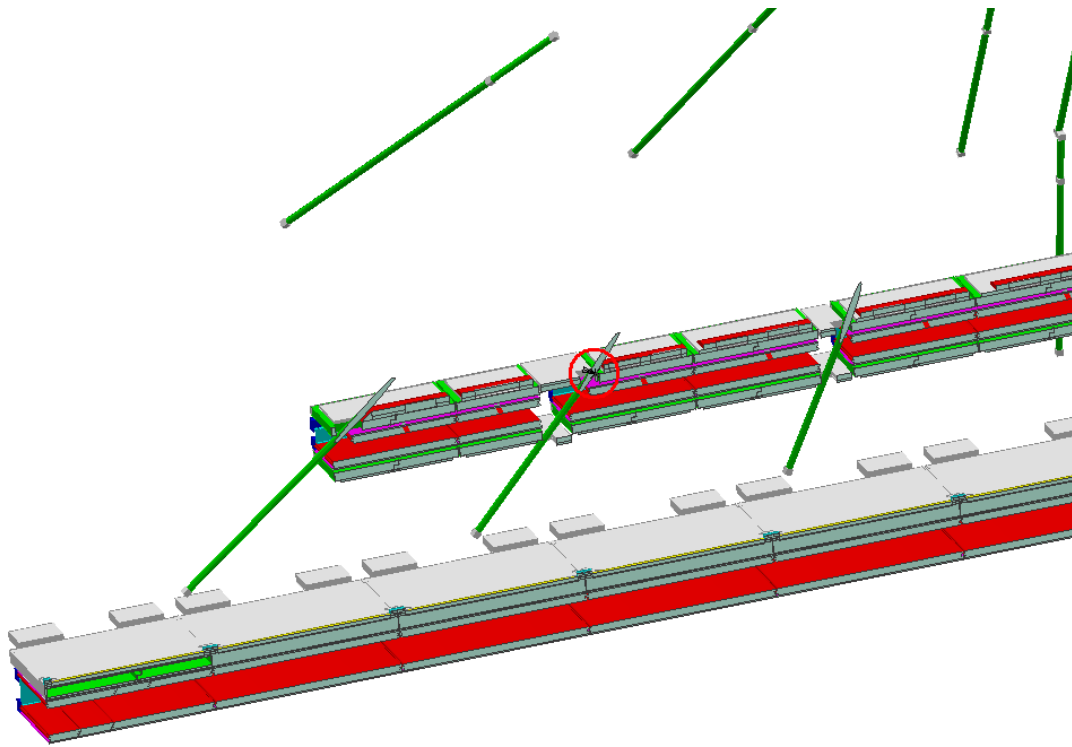

<p>AT602342MQ - MUON BARREL CHAMBERS DETAILED, SECTOR 16</p>	<p>NMA_0009 - END CAP ALIGNMENT SIDE "A". - SIMPLE 3-D MODEL</p>	<p>Clash</p>	<p>-733.4 mm</p>	<p>Warning</p>
--	--	--------------	------------------	----------------

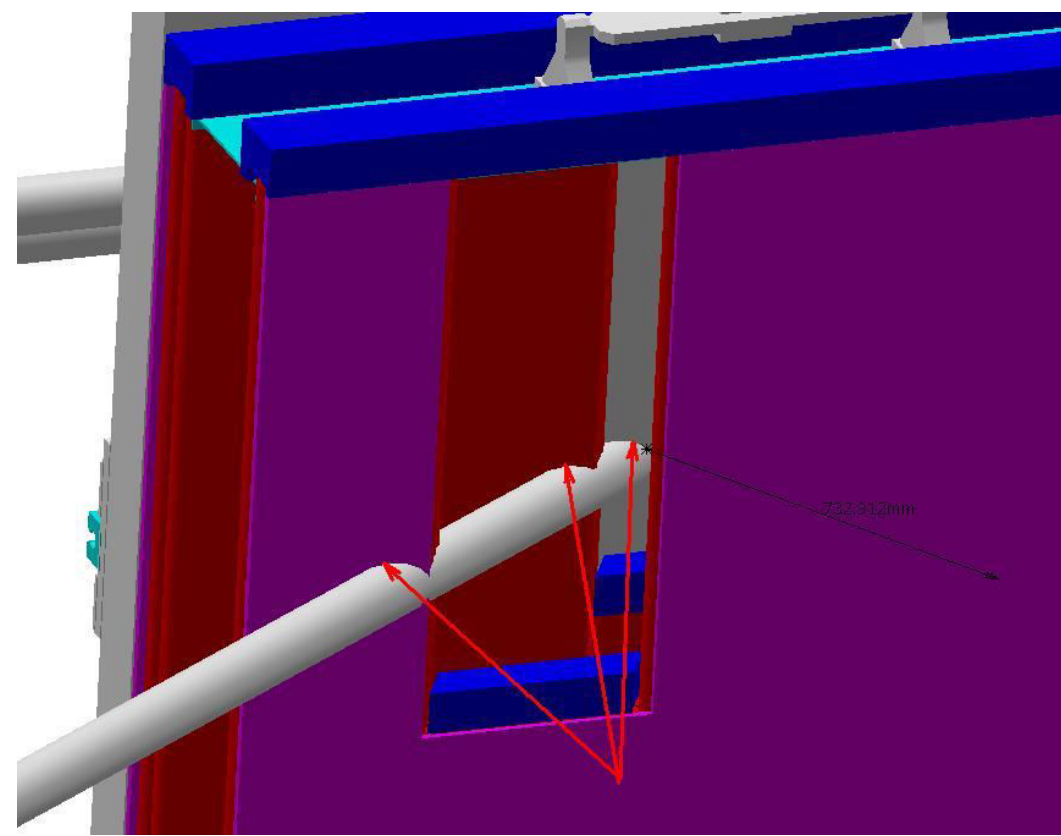
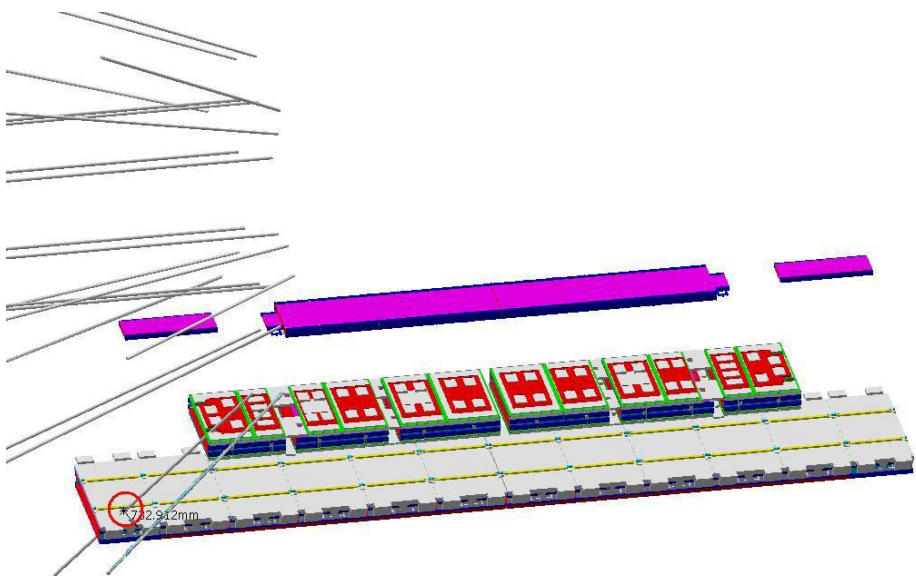

Clash value: ~ 733.4 mm

SIDE A

Sector 16

Olga: Relevant holes defined in parameter book  
– BOS model to be updated

# Clash View:

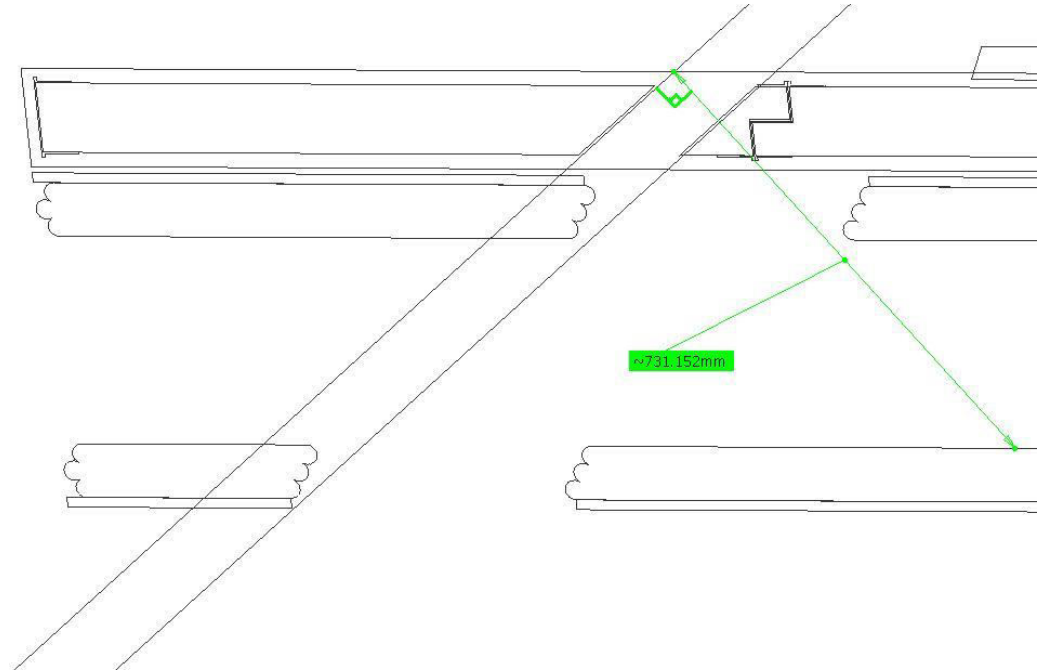
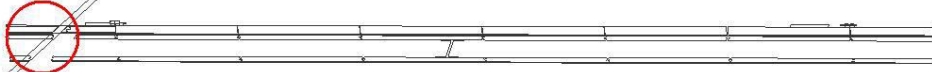
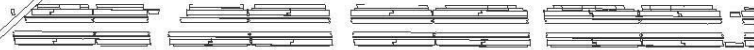
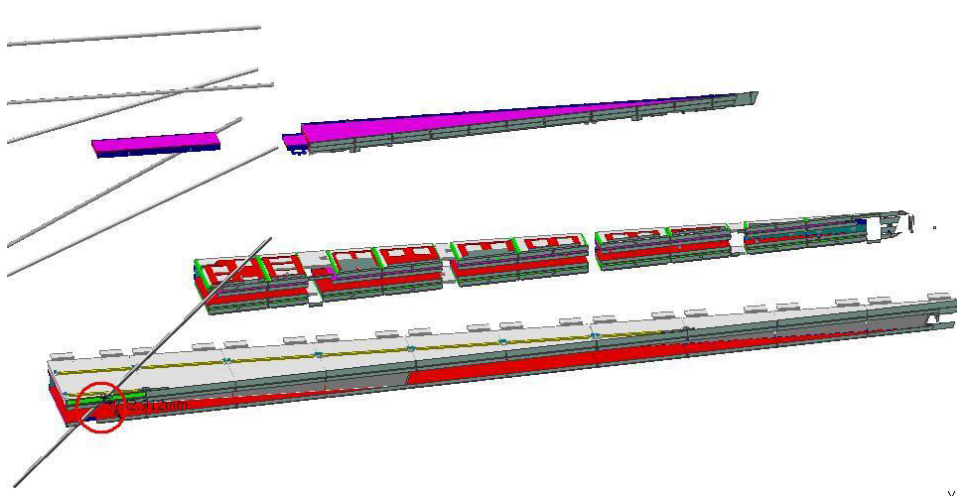

WARNING

AT602342MQ - MUON BARREL CHAMBERS DETAILED, SECTOR 16	NMA_0010 - END CAP ALIGNMENT SIDE "C" - SIMPLE 3-D MODEL	Clash	-733.8 mm	Warning
--	---	-------	-----------	---------

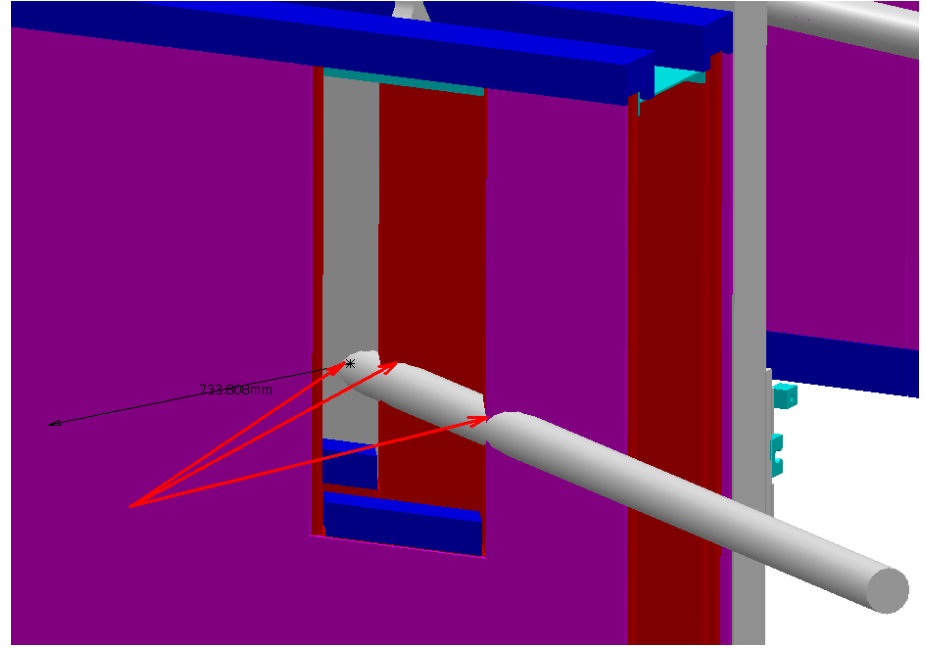
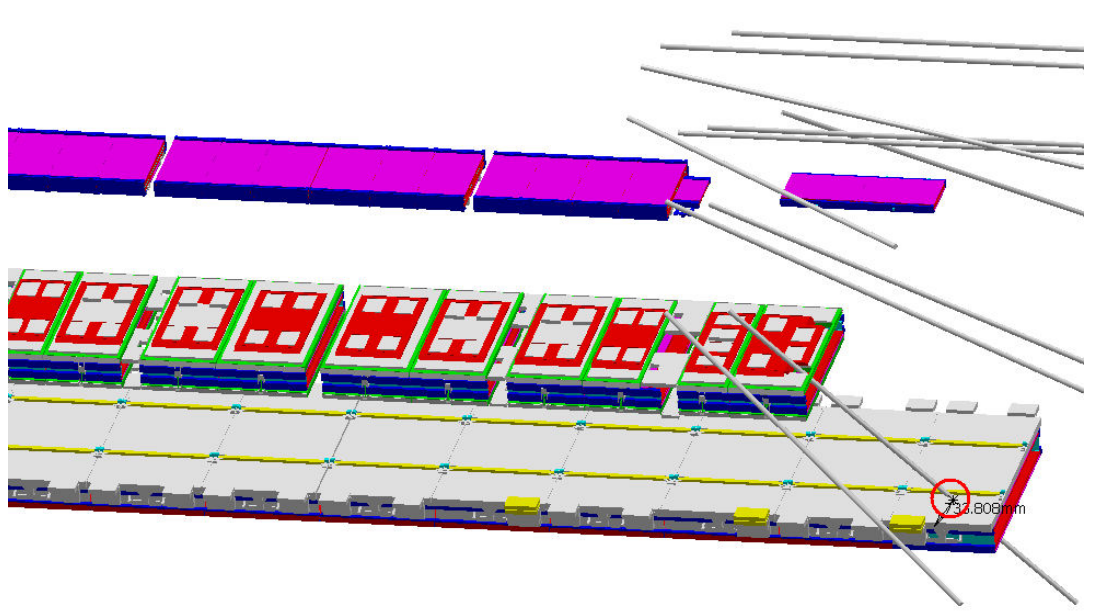

Clash value: ~ 733.8 mm  
SIDE C  
Sector 16

Olga: Relevant holes defined in parameter book  
– BOS model to be updated



# Clash View:

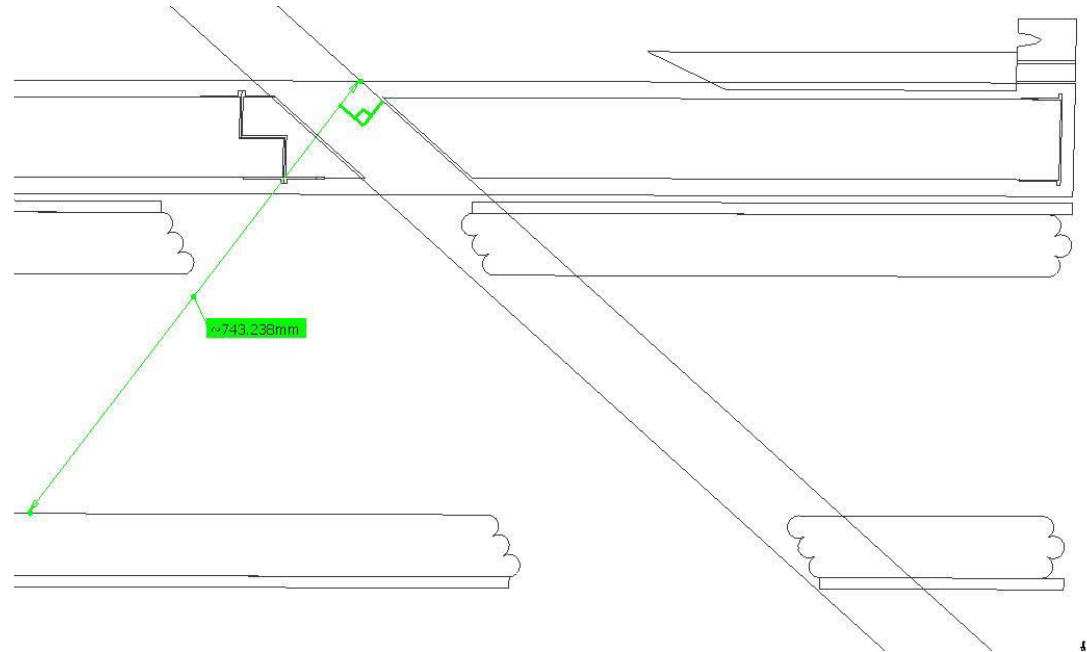
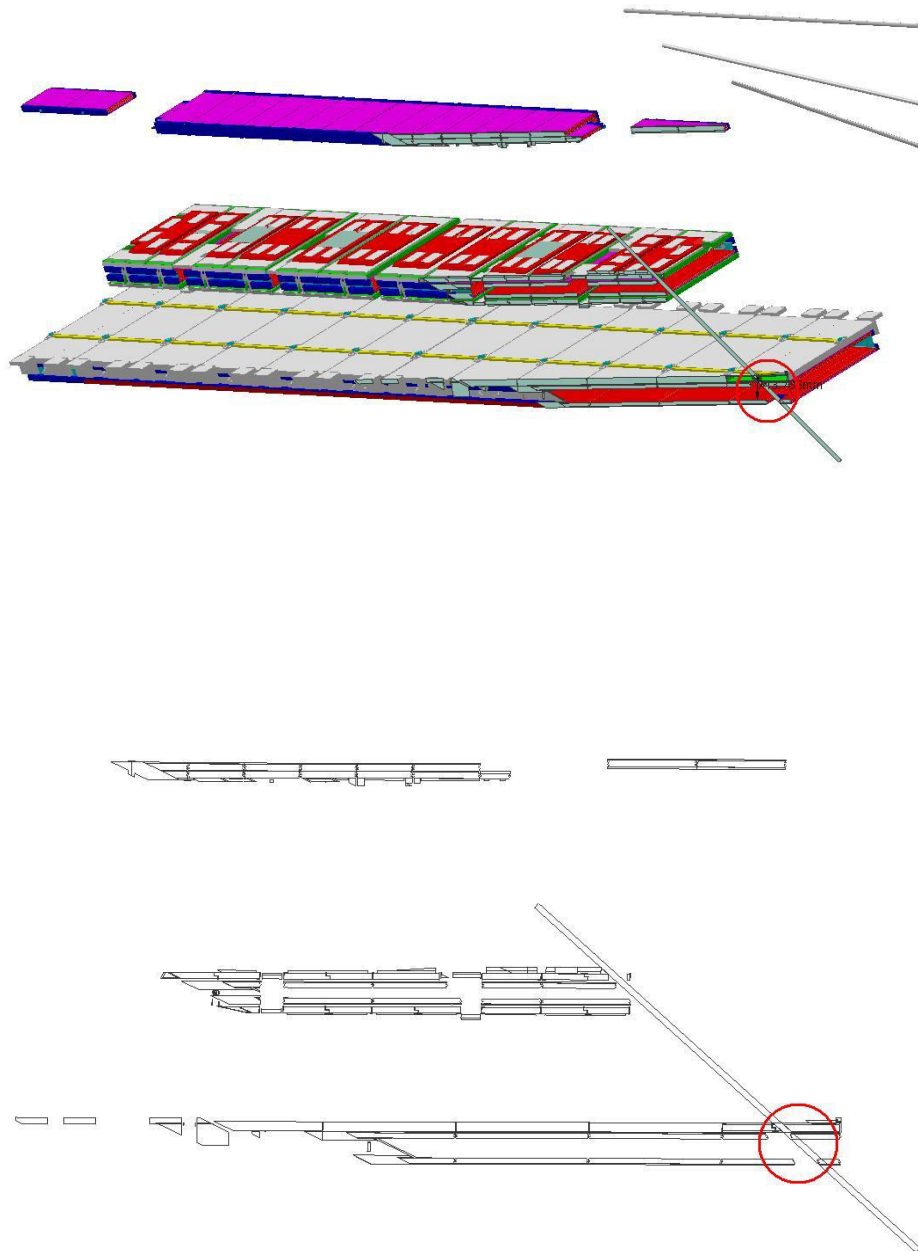

AT602342MQ - MUON BARREL CHAMBERS DETAILED, SECTOR 16	NMA_0018 - SECTOR 16 SIDE C (A) - REFERENCE ALIGNMENT SYSTEM AND	Clash	-166.3 mm	Warning
---	--	-------	-----------	---------

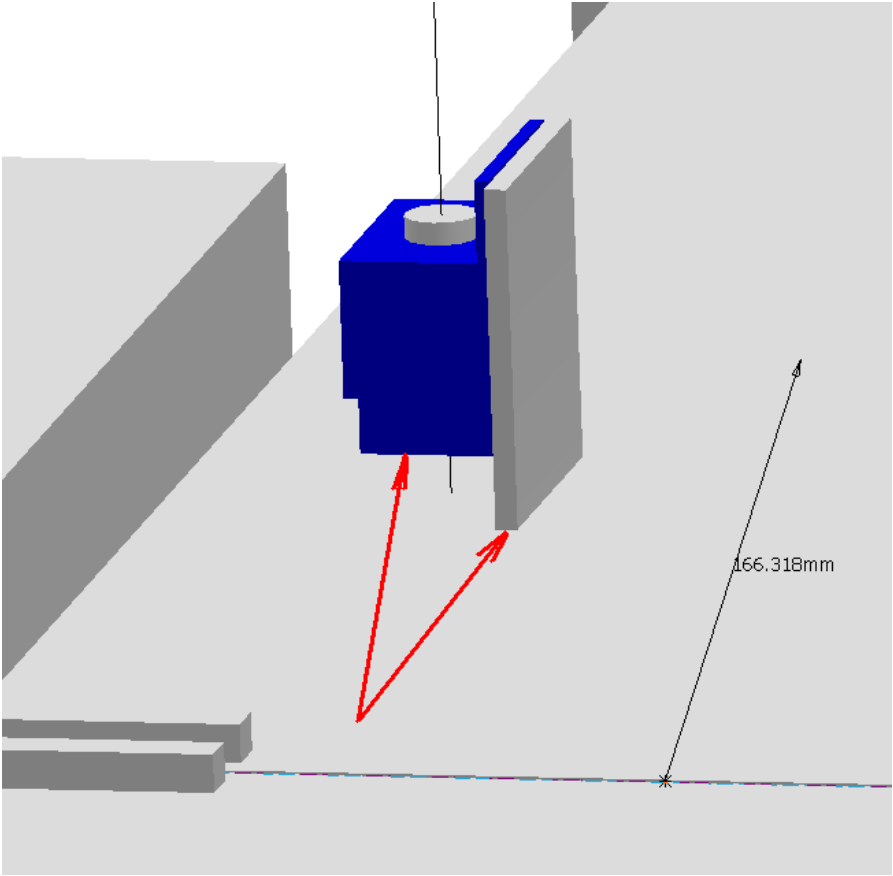
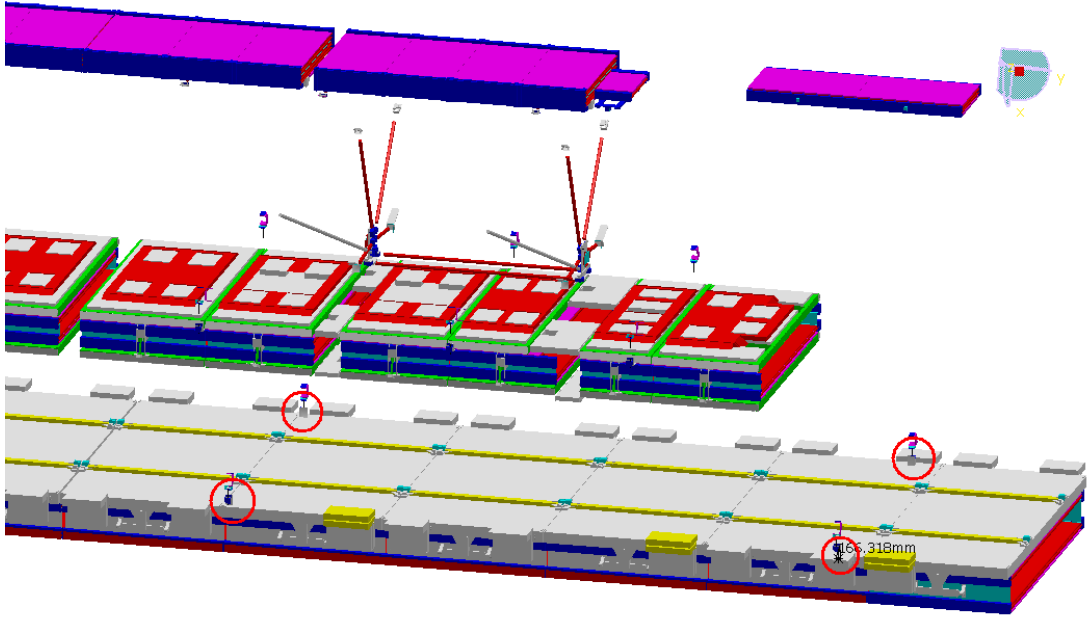

Clash value: ~166.3 mm  
SIDE C  
Sector 16

Olga: Warning for Muon Team

# Clash View:

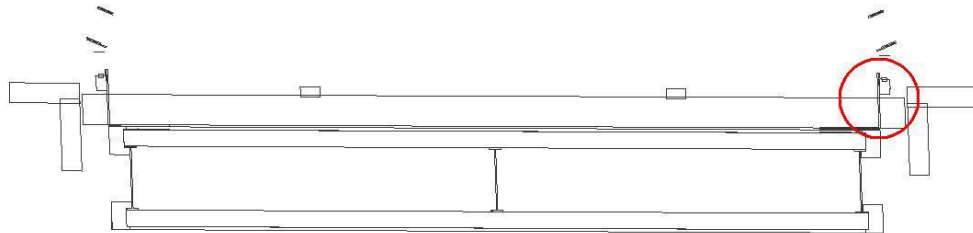
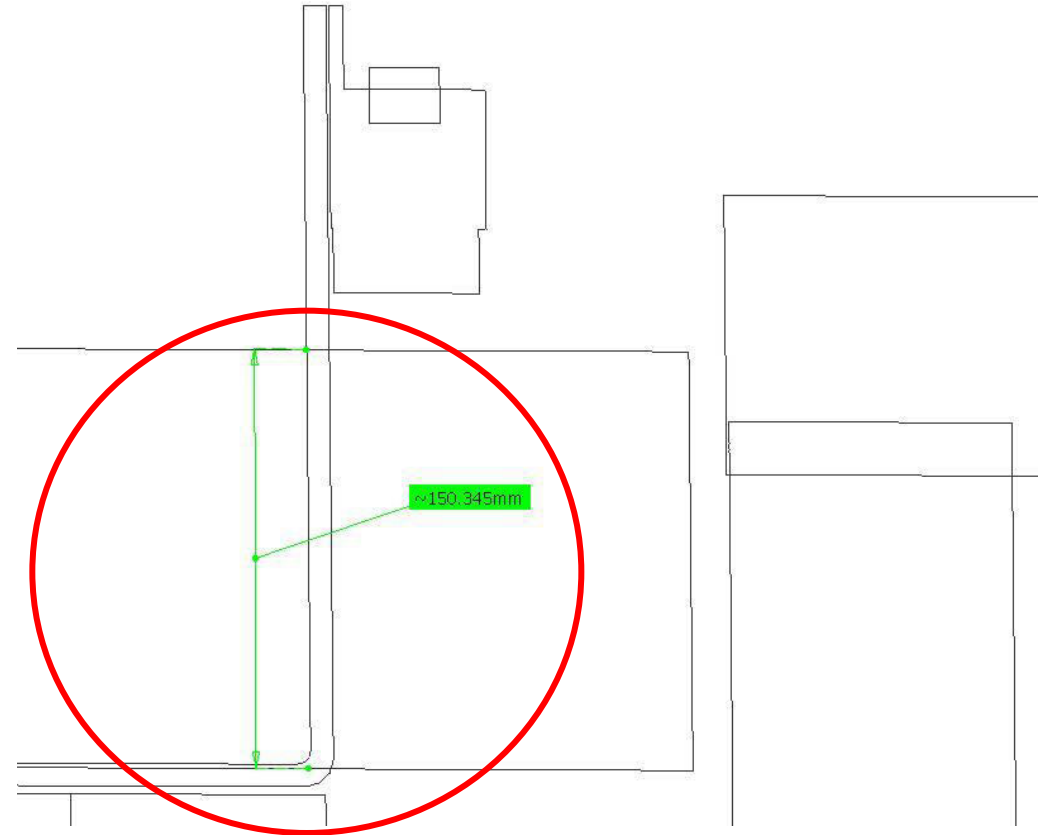
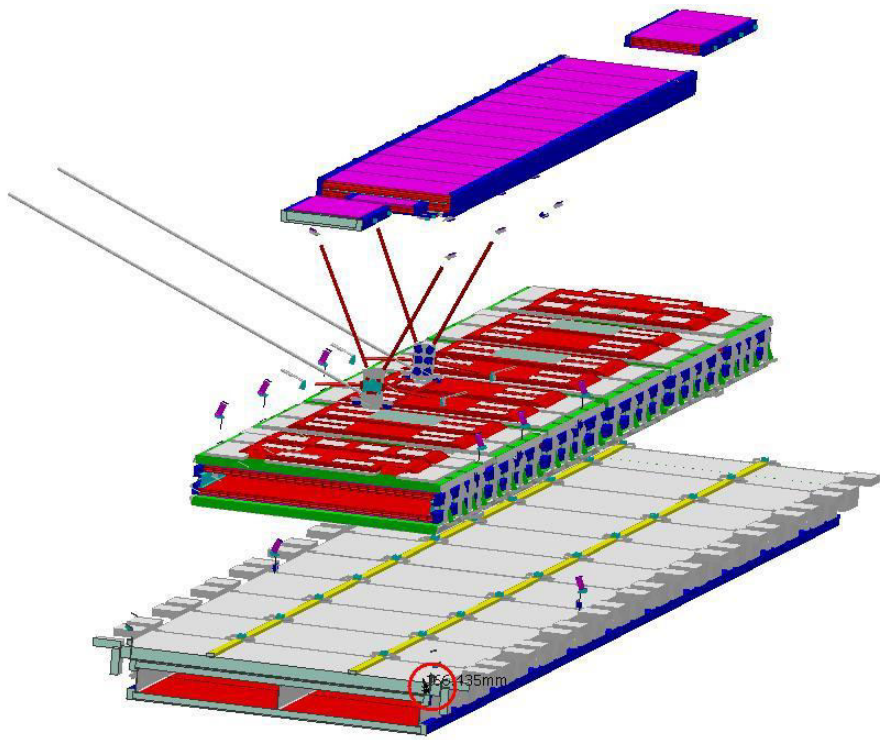

AT602342MQ - MUON BARREL  
CHAMBERS DETAILED, SECTOR 16

Z5\_0002 - Z5 GLOBAL ENVELOPE (SIDE A) - AND  
LOCATION INTERFACES

Clash

-123.6 mm

Not Relevant

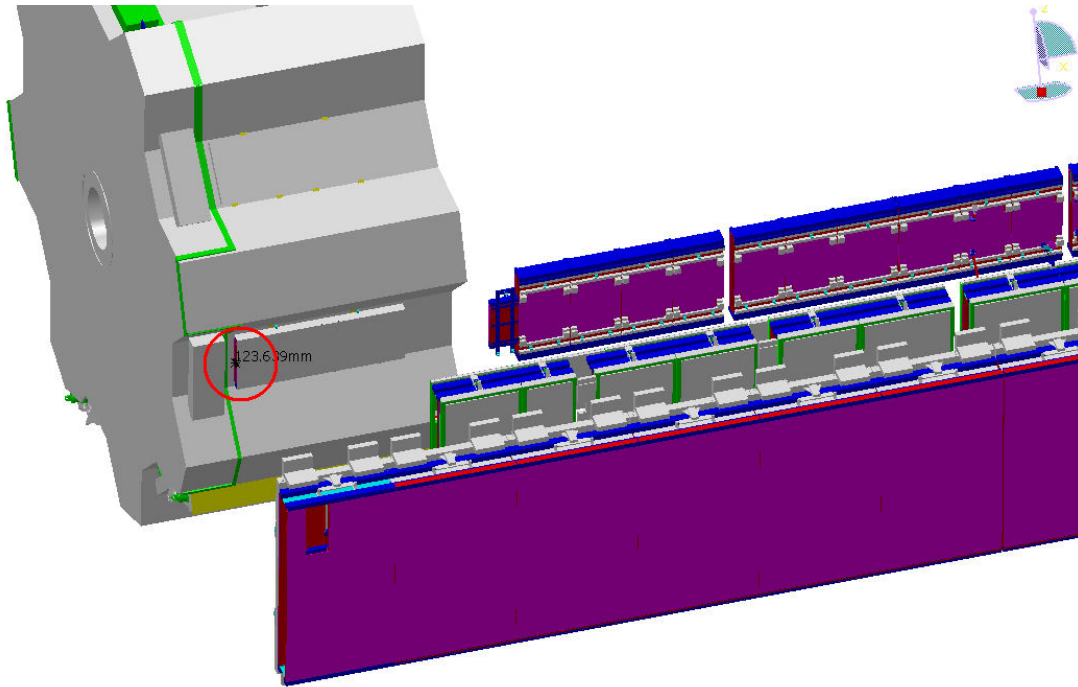

Clash value: ~ -123.6 mm

SIDE A

Sector 16

Lasha: This is Interface