



# Clash Publish

Clash Computation Specification			
Products Selected		Value	Status
AT602166MQ - MUON BARREL CHAMBERS DETAILED, SECTOR 14	VHB_0001 - CENTRAL PAIR OF FEET B - DETAILED MODEL FOR STANDARDS	-3.5 mm	Not inspected
	VHB_0008 - FOOT B WITH BRACKET HOLES - MAIN BOLTS AND WELDINGS	-3.5 mm	Not inspected
	NMA_0008 - BARREL PROJECTIVE ALIGNMENT. - SIMPLE 3-D MODEL. SECTOR 15	-6.7 mm	Not inspected
	NMA_0009 - END CAP ALIGNMENT SIDE "A". - SIMPLE 3-D MODEL	-548 mm	Not inspected

## Clash Computation Specification

Products Selected		Value	Status
AT602166MQ - MUON BARREL CHAMBERS DETAILED, SECTOR 14	NMA_0010 - END CAP ALIGNMENT SIDE "C" - SIMPLE 3-D MODEL	-547.9 mm	Not inspected
	NMA_0017 - SECTOR 14 SIDE C (A) - REFERENCE ALIGNMENT SYSTEM AND	-80.9 mm	Not inspected
	NSE_0008 - EXTENDED TILE AIR-PAD CHAIN - IN DIFFERENT POSITIONS	-45.4 mm	Not inspected
	NSE_0010 - SMALL WHEEL AIR-PAD CHAIN - IN 2 POSITIONS	-24.6 mm	Not inspected
	Z5_0002 - Z5 GLOBAL ENVELOPE (SIDE A) - AND LOCATION INTERFACES	-123.6 mm	Not inspected
	Z5_0001 - Z5 GLOBAL ENVELOPE (SIDE C) - AND LOCATION INTERFACES *	-123.7 mm	Not inspected

### Computation Result:

\* Working on new version

AT602166MQ - MUON BARREL  
CHAMBERS DETAILED, SECTOR 14

VHB\_0001 - CENTRAL PAIR OF FEET B -  
DETAILED MODEL FOR STANDARDS

Clash

-3.5 mm

Not inspected

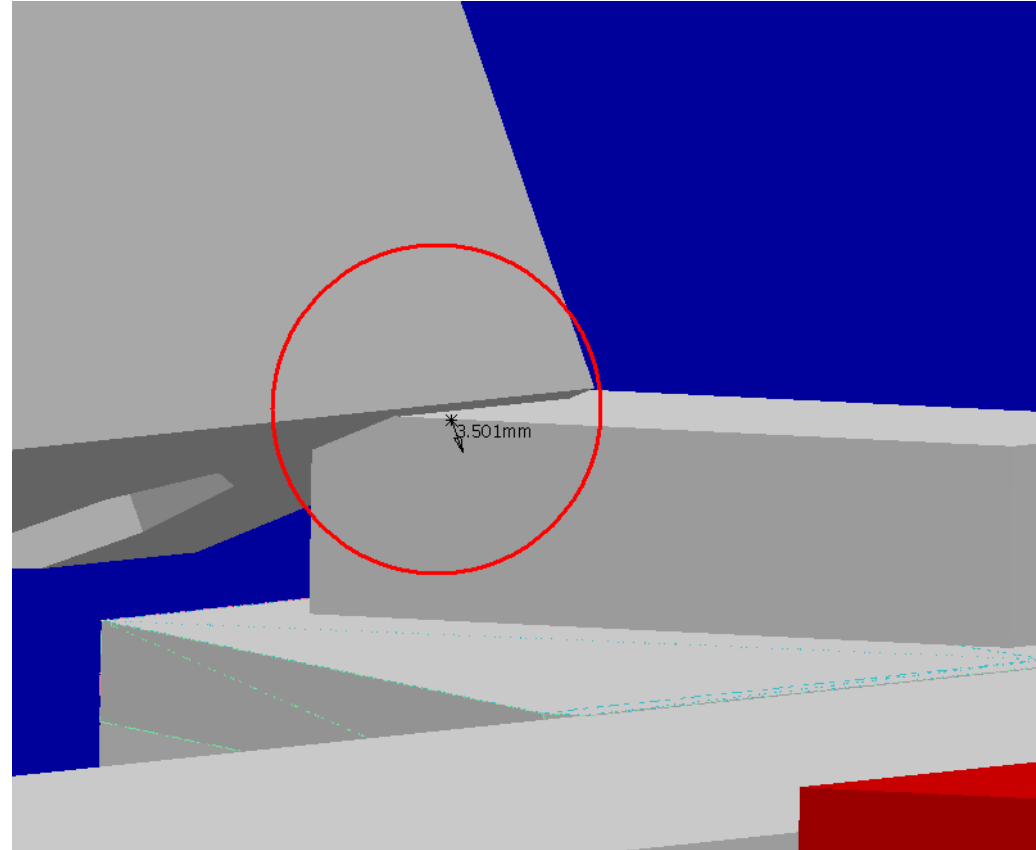
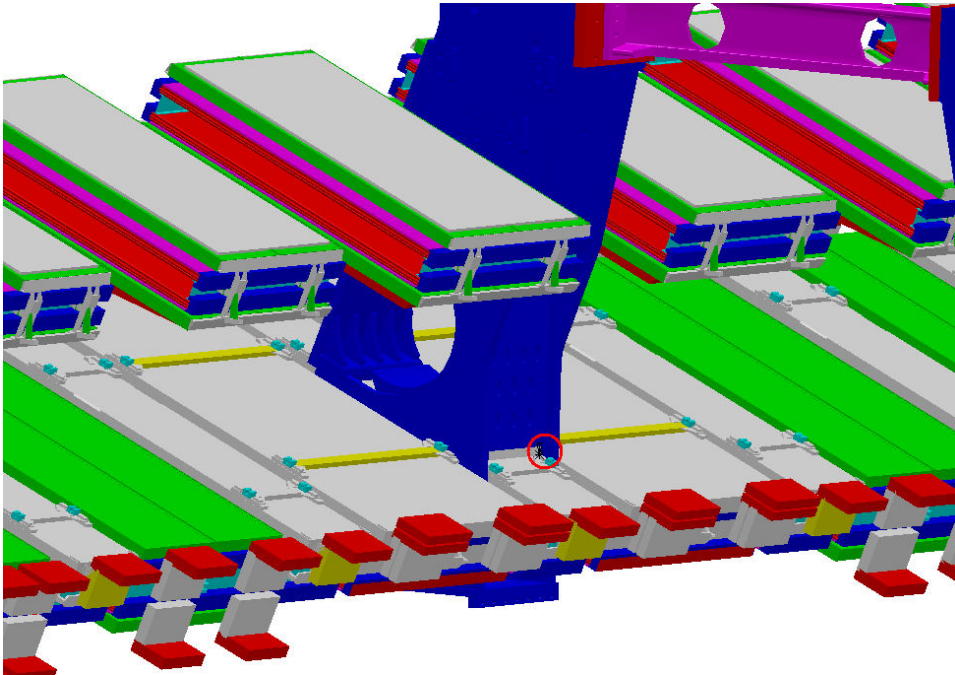

Clash value: ~ 3.5 mm

SIDE A-C

Sector 14

The identical clash exists on the opposite side

# Clash View:

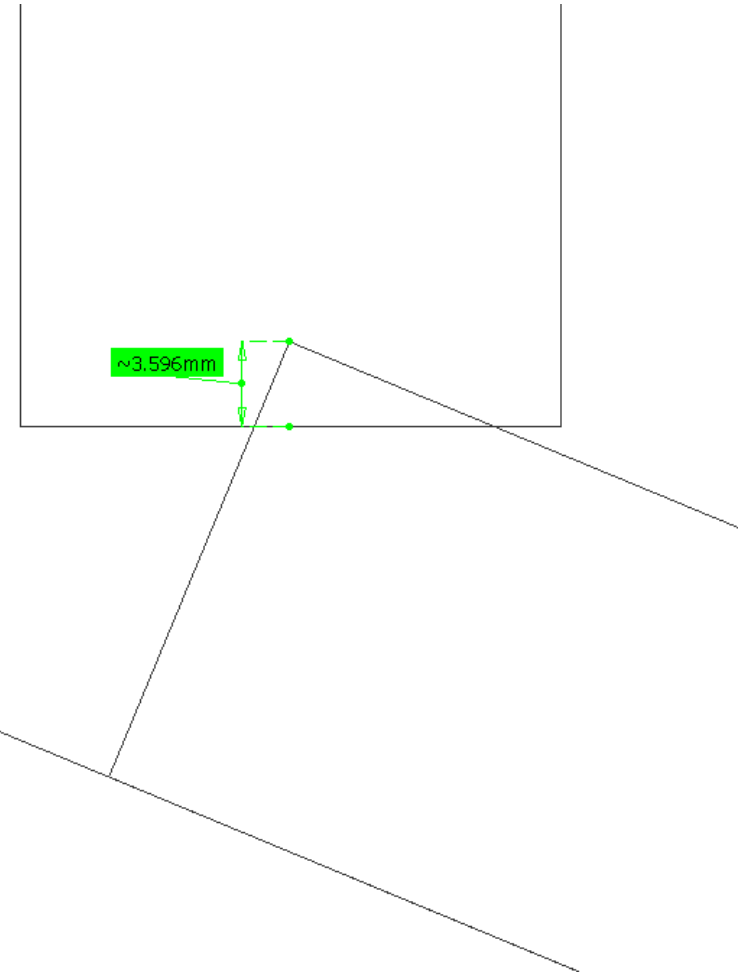
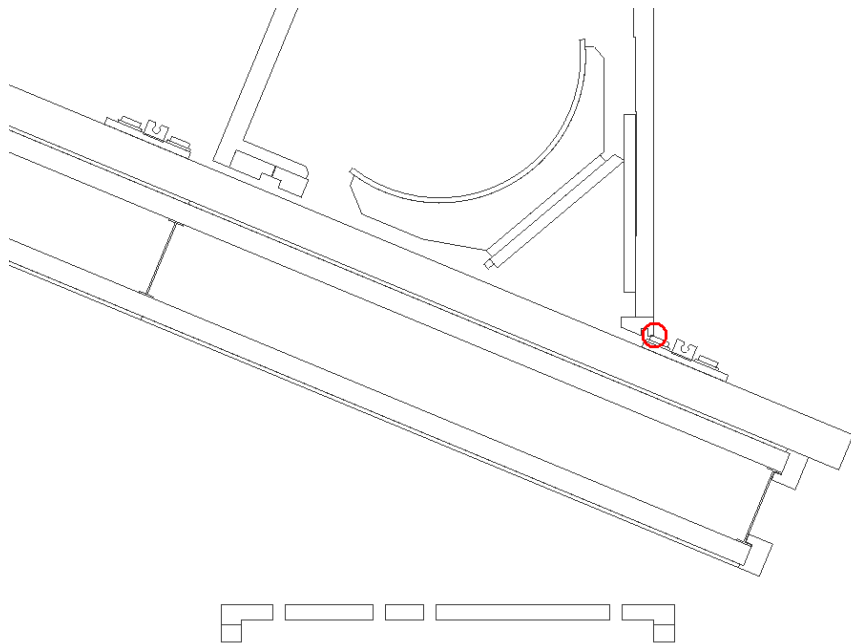
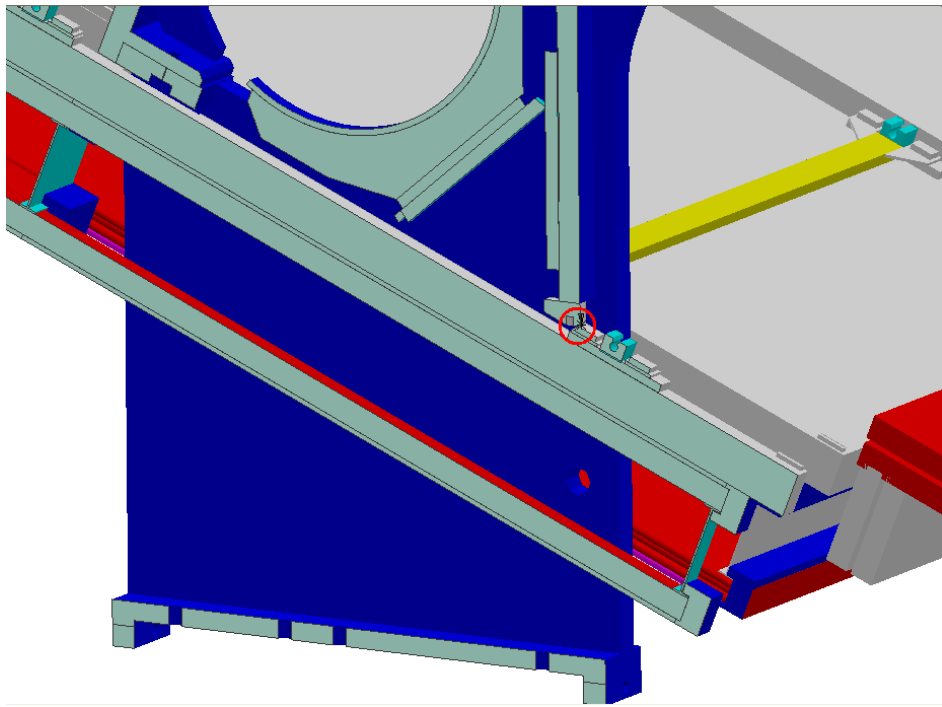

AT602166MQ - MUON BARREL  
CHAMBERS DETAILED, SECTOR 14

VHB\_0008 - FOOT B WITH BRACKET HOLES -  
MAIN BOLTS AND WELDINGS

Clash

3.5 mm

Not inspected

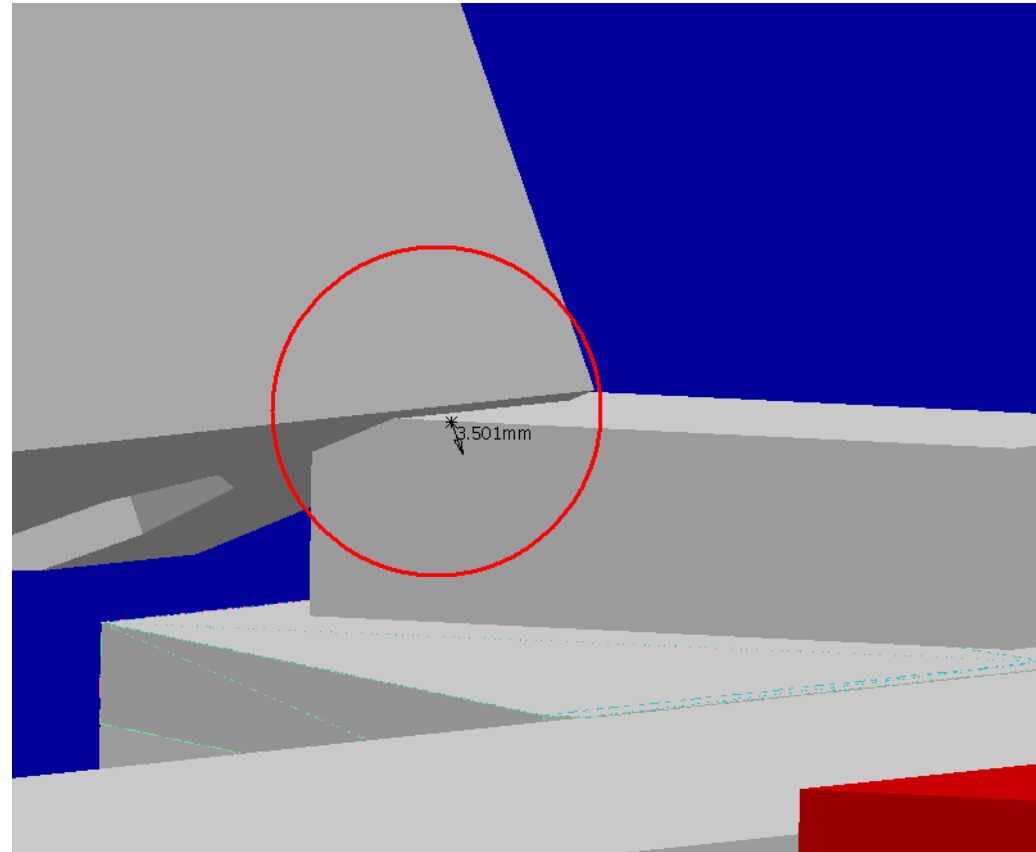
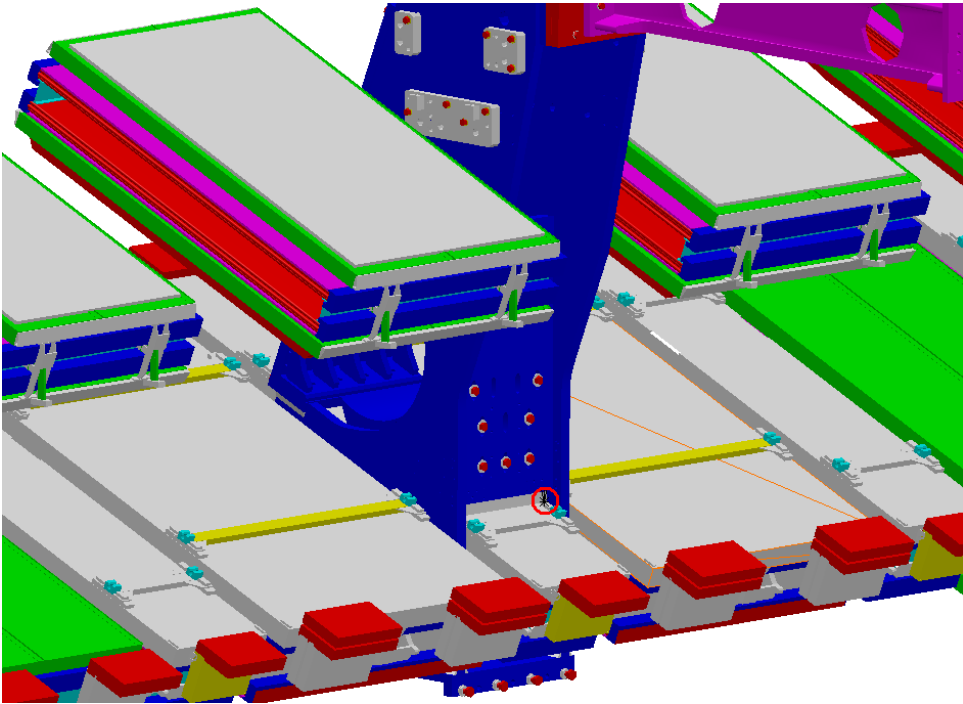

Clash value: ~ 3.5 mm

SIDE A-C

Sector 14

The identical clash exists on the opposite side

# Clash View:

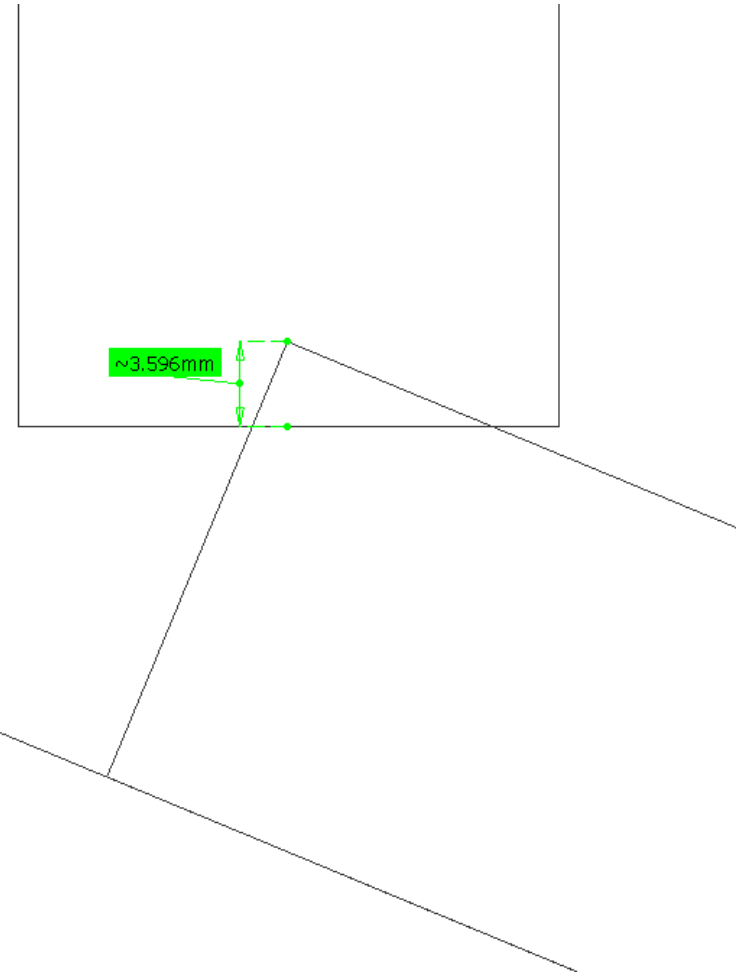
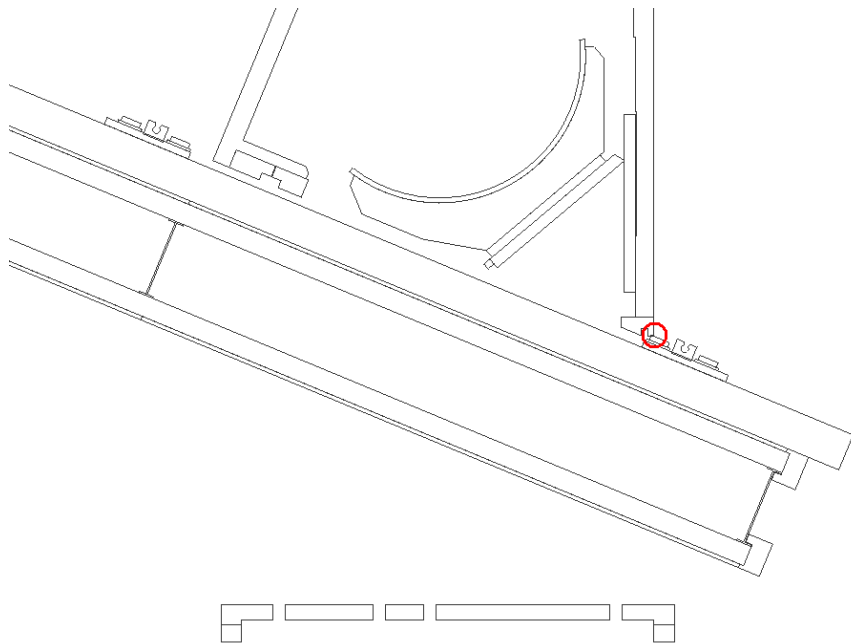
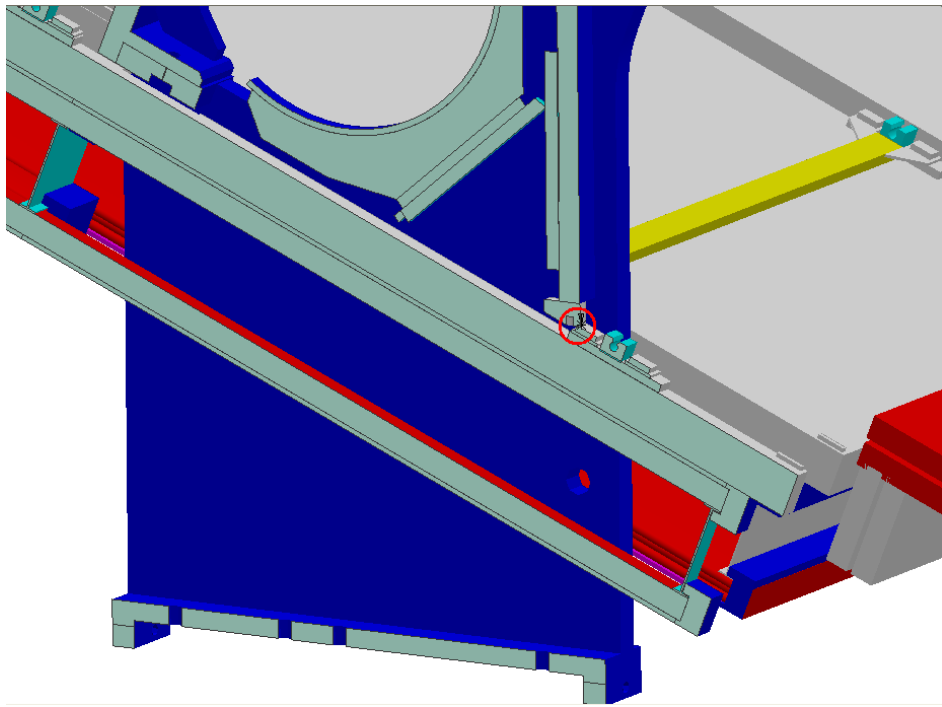

AT602166MQ - MUON BARREL  
CHAMBERS DETAILED, SECTOR 14

NMA\_0008 - BARREL PROJECTIVE ALIGNMENT.  
- SIMPLE 3-D MODEL. SECTOR 15

Clash

-6.7 mm

Not inspected

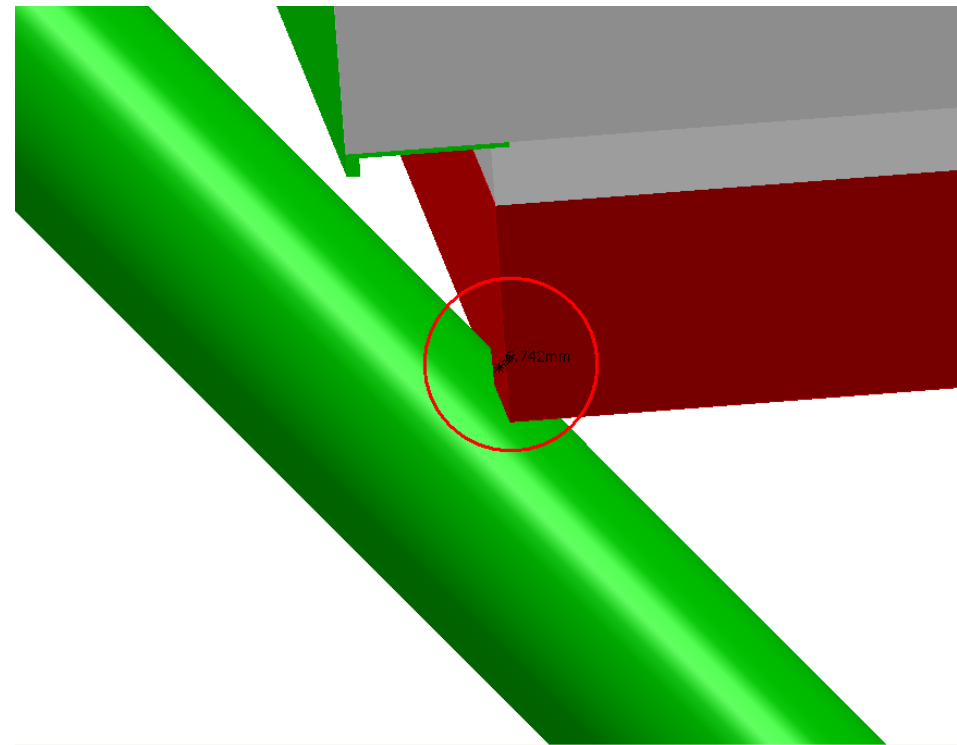
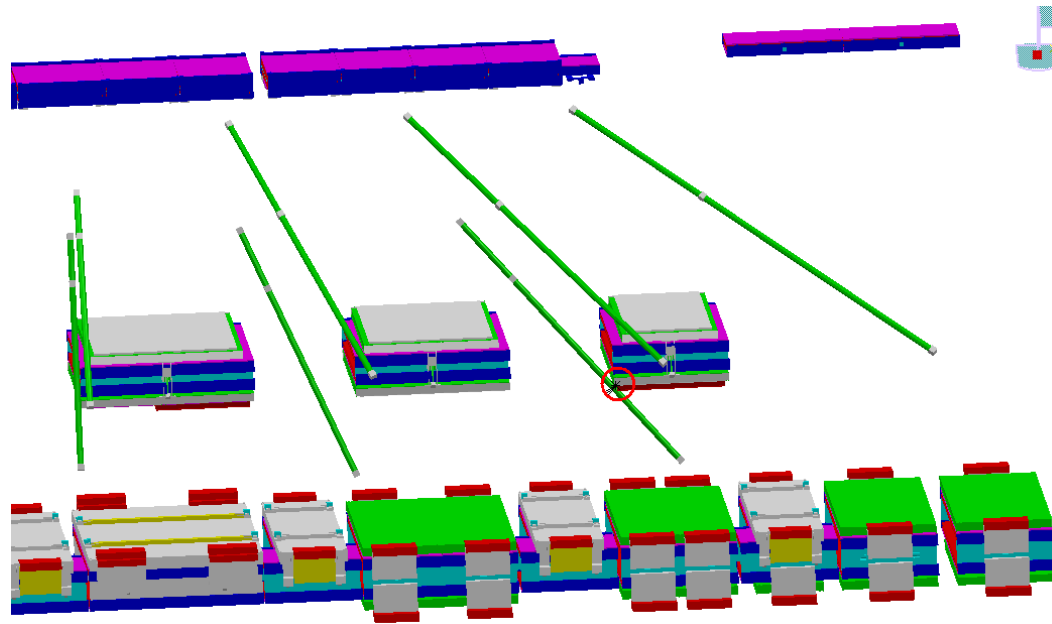

Clash value: ~ 6.7 mm

SIDE A-C

Sector 14

The identical clash exists on the other side

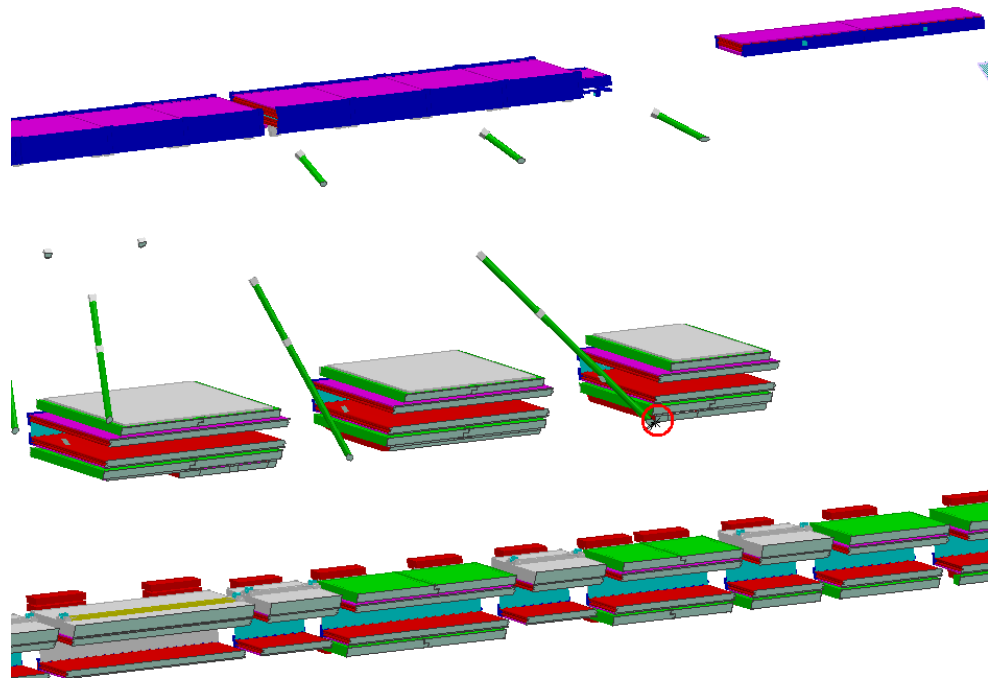

# Clash View:

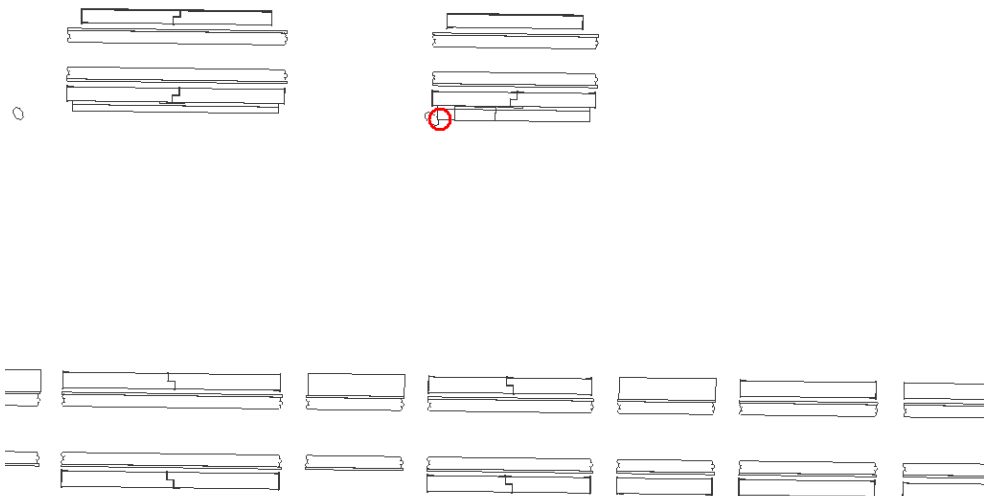
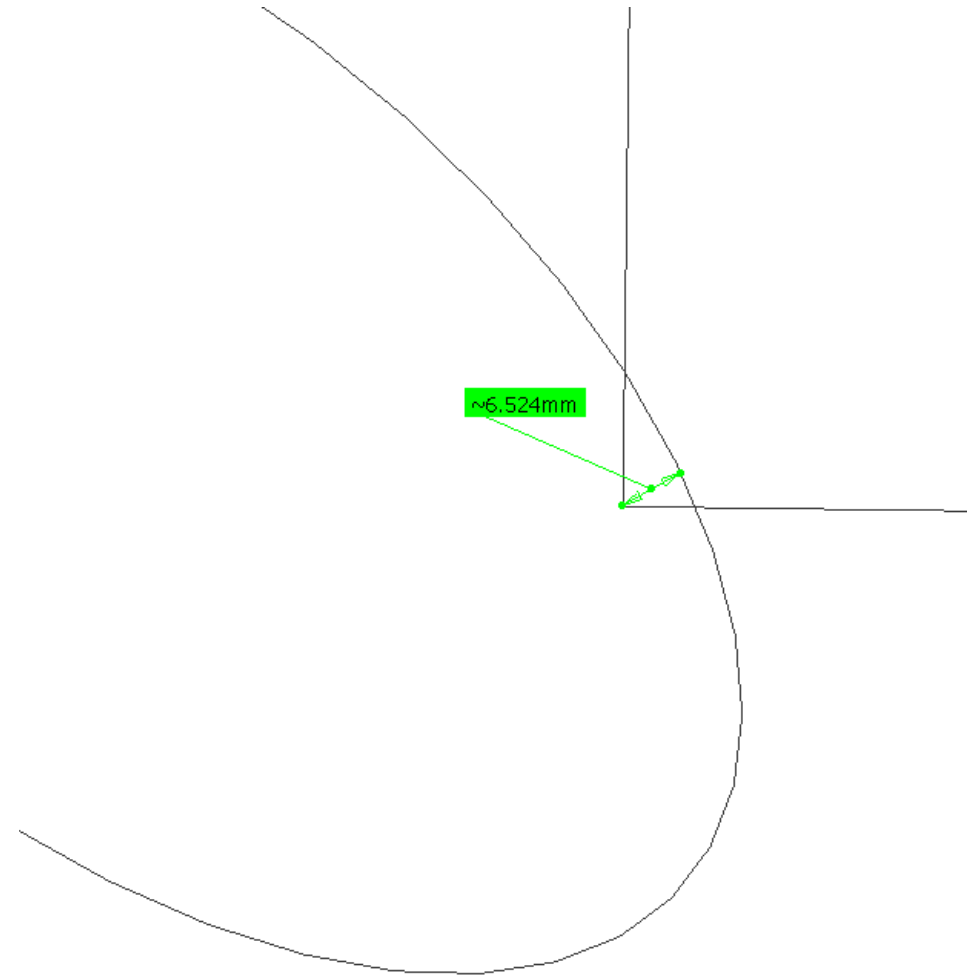



AT602166MQ - MUON BARREL  
CHAMBERS DETAILED, SECTOR 14

NMA\_0009 - END CAP ALIGNMENT SIDE "A". -  
SIMPLE 3-D MODEL

Clash

-548 mm

Not inspected

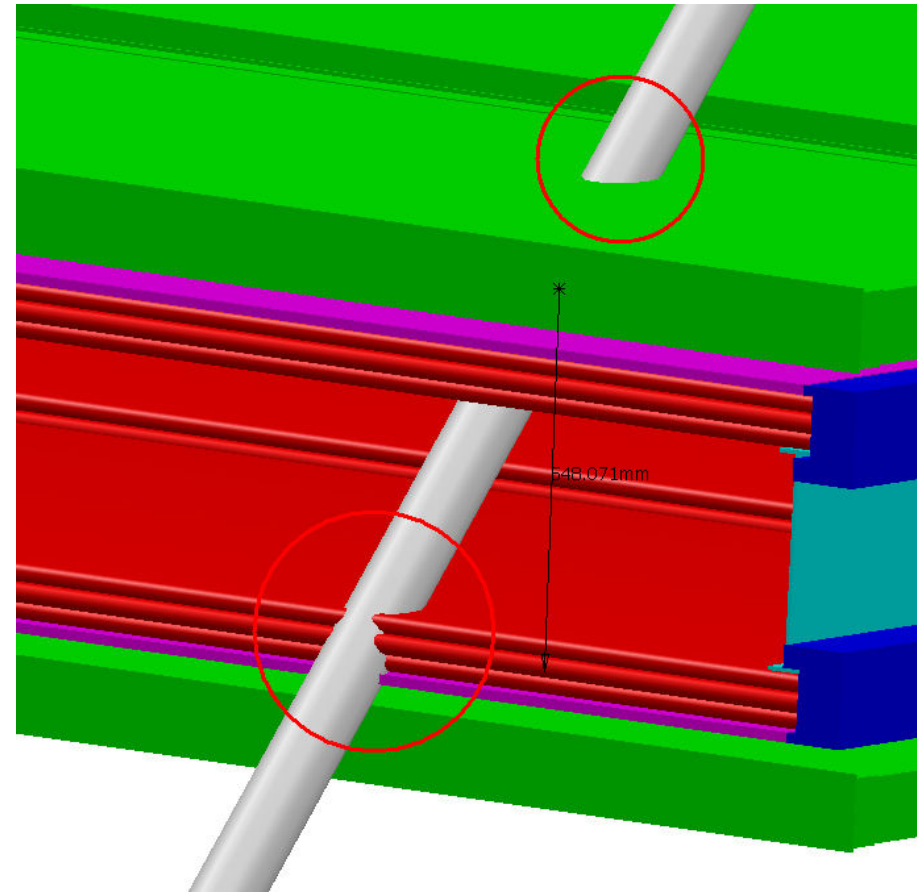
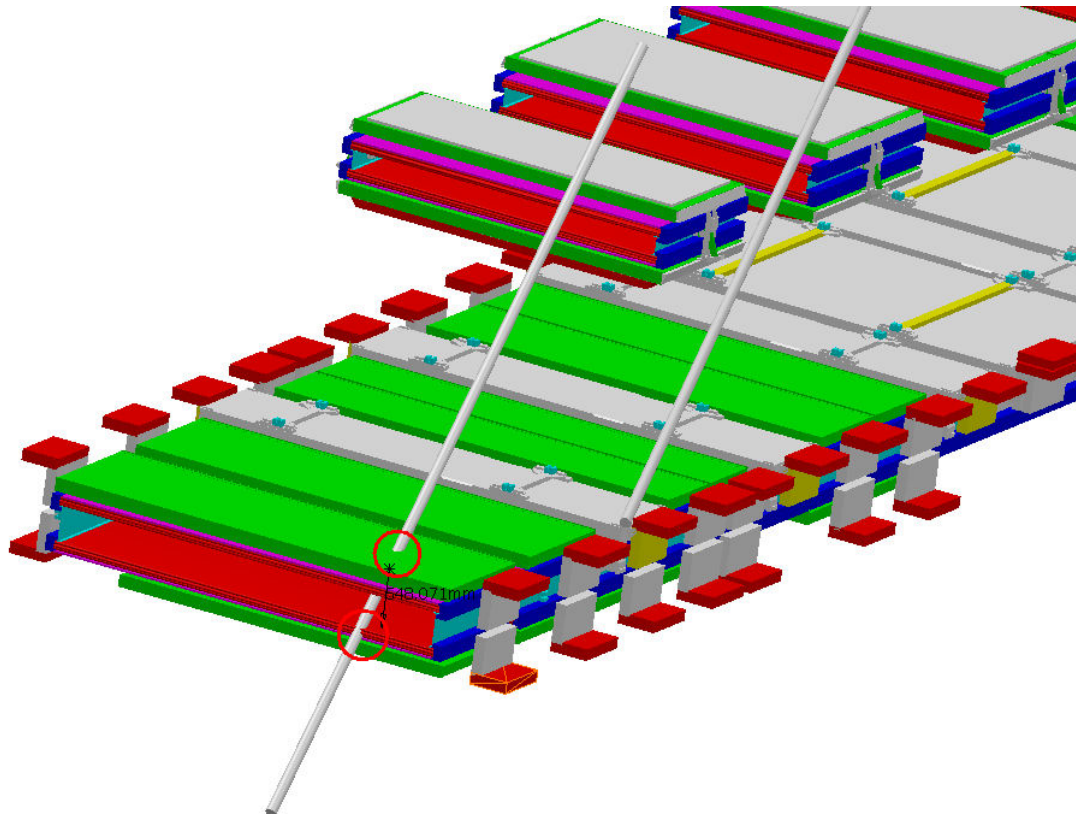

Clash value: ~ 548 mm

SIDE A

Sector 14

# Clash View:

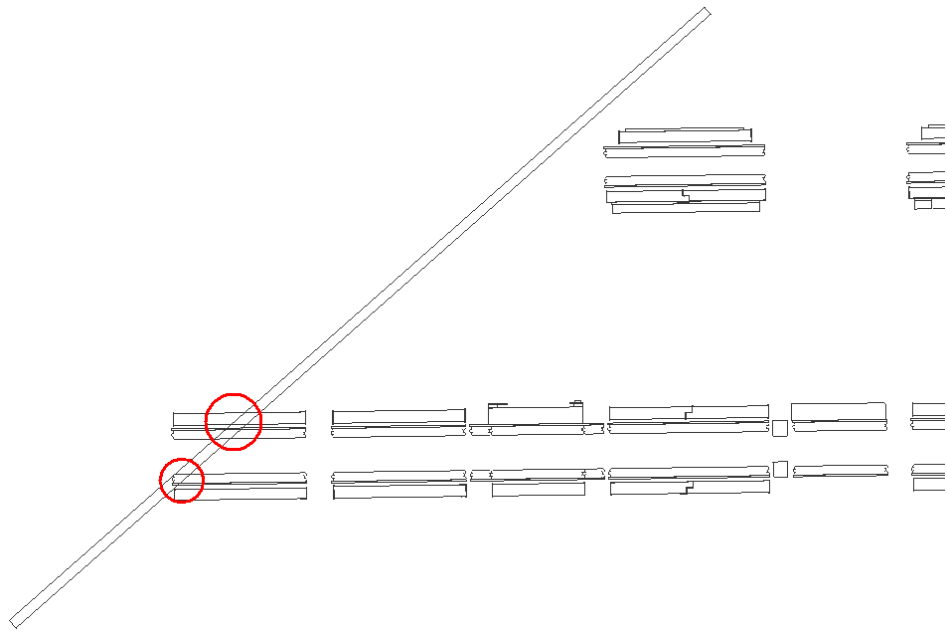
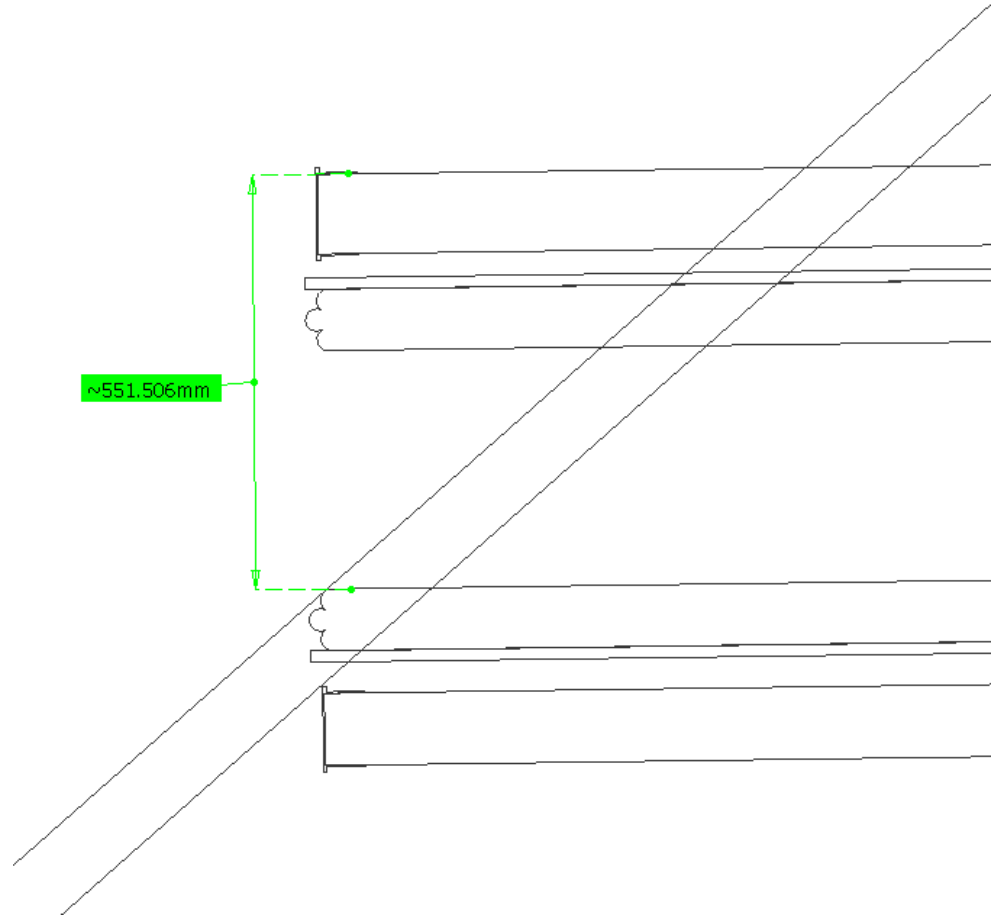
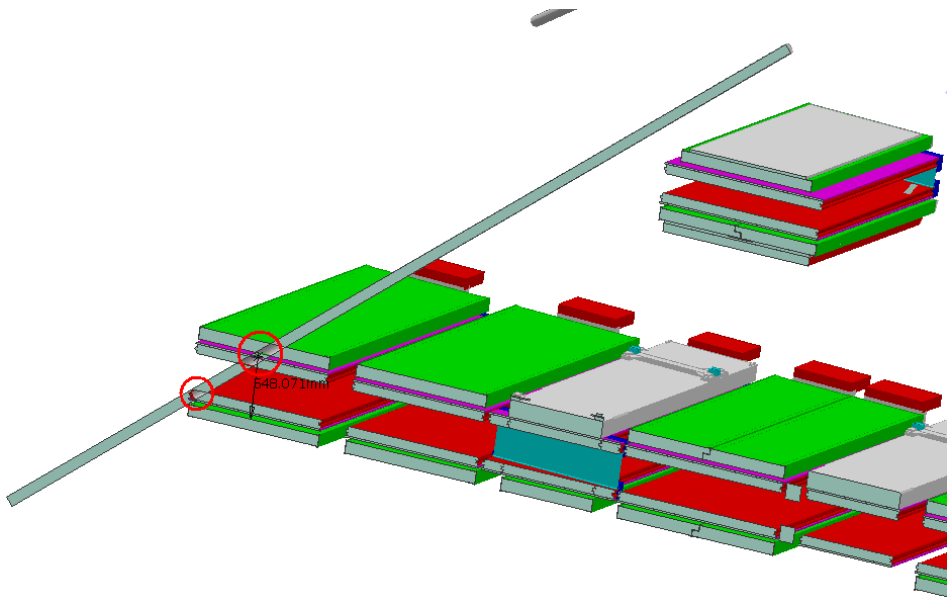

AT602166MQ - MUON BARREL  
CHAMBERS DETAILED, SECTOR 14

NMA\_0010 - END CAP ALIGNMENT SIDE "C" -  
SIMPLE 3-D MODEL

Clash

-547.9 mm

Not inspected

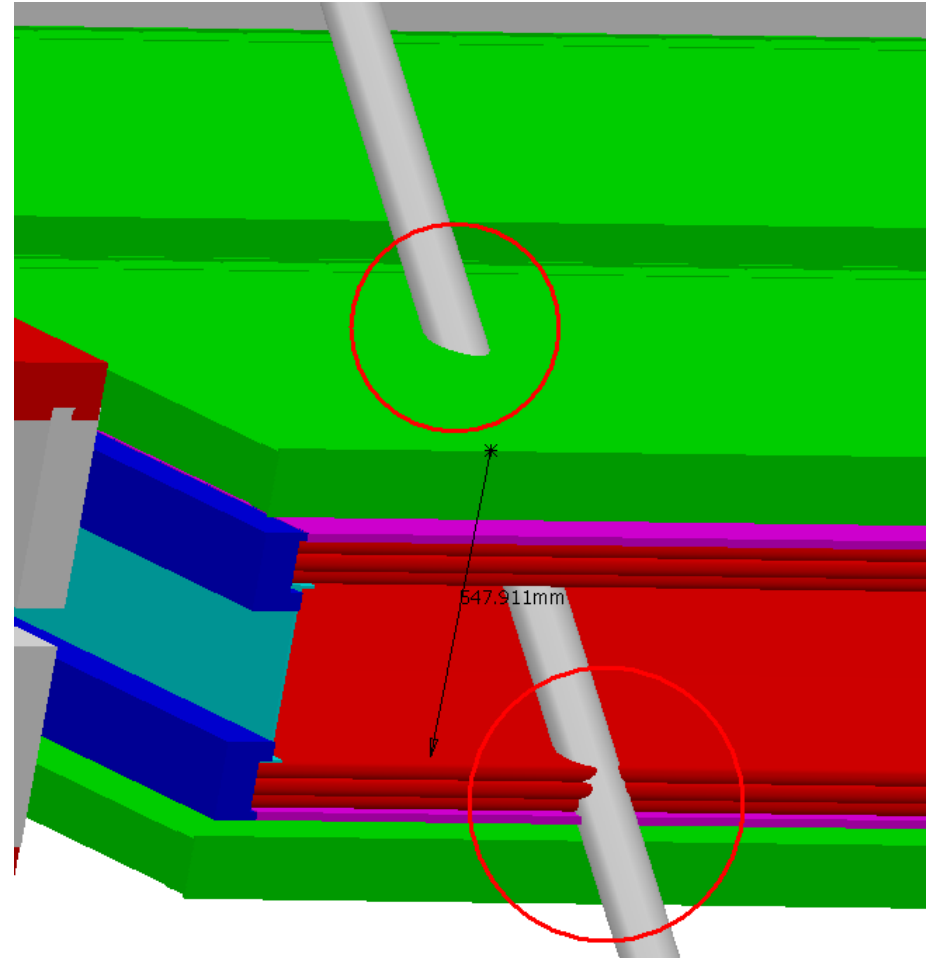
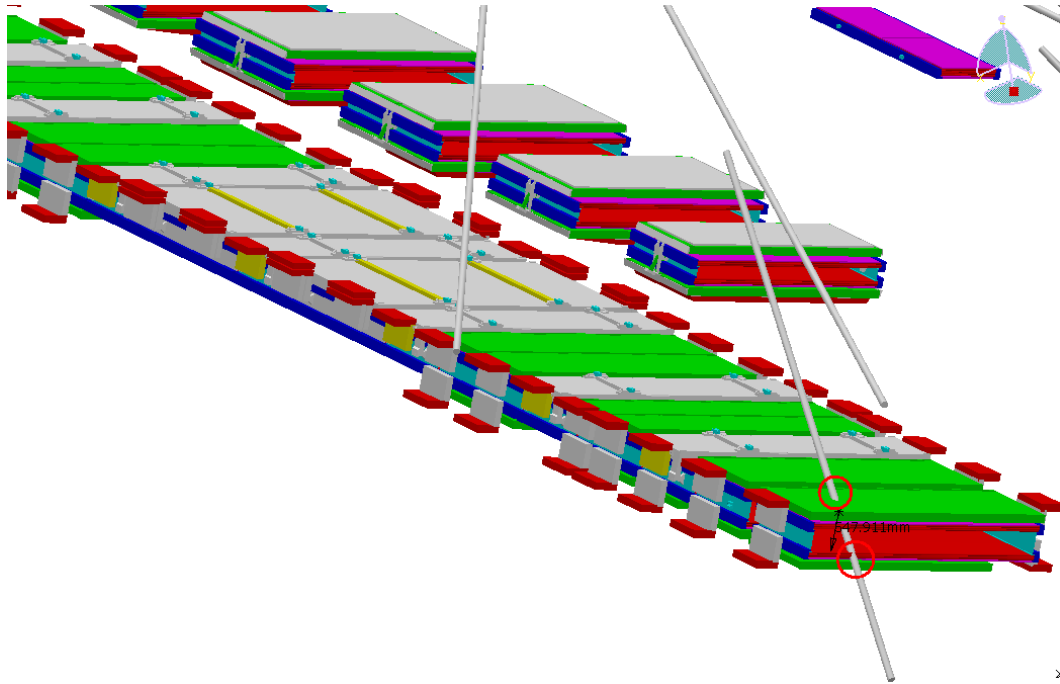

Clash value: ~ 547.9 mm

SIDE C

Sector 14

# Clash View:

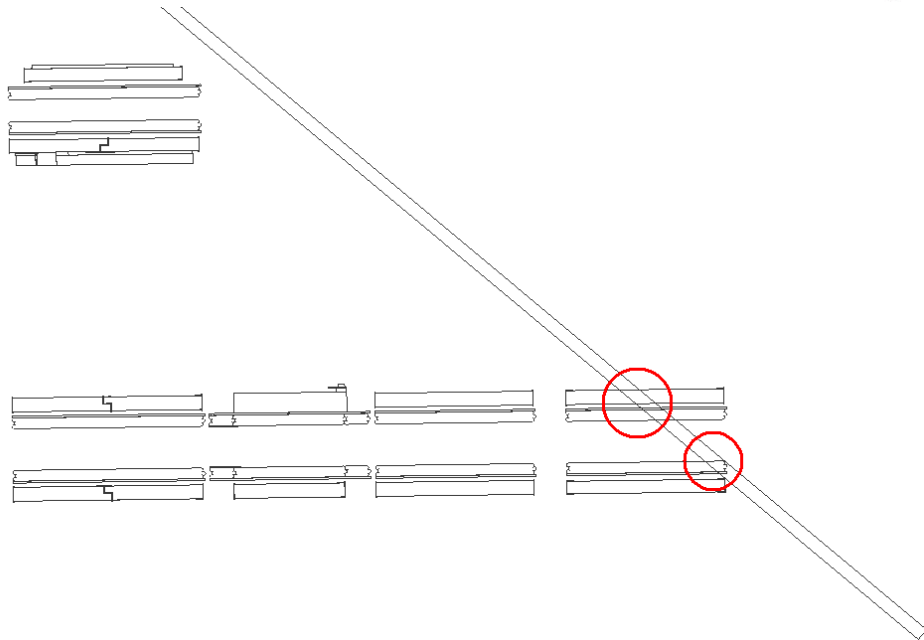
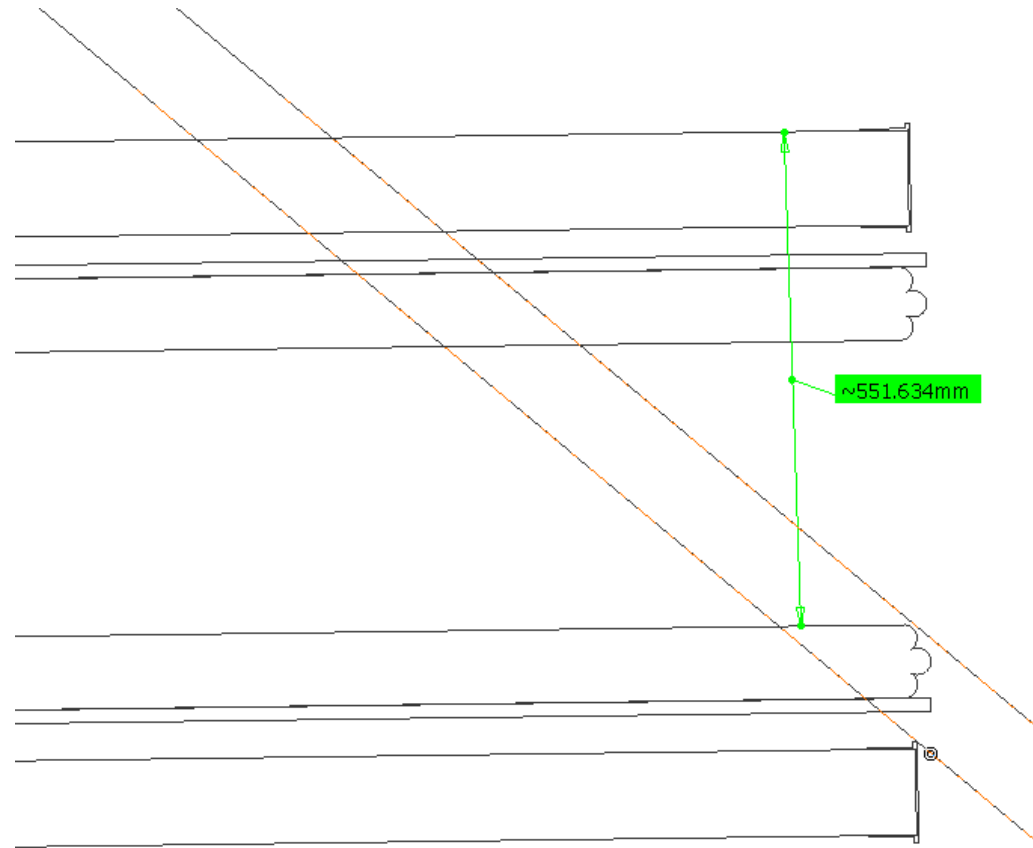
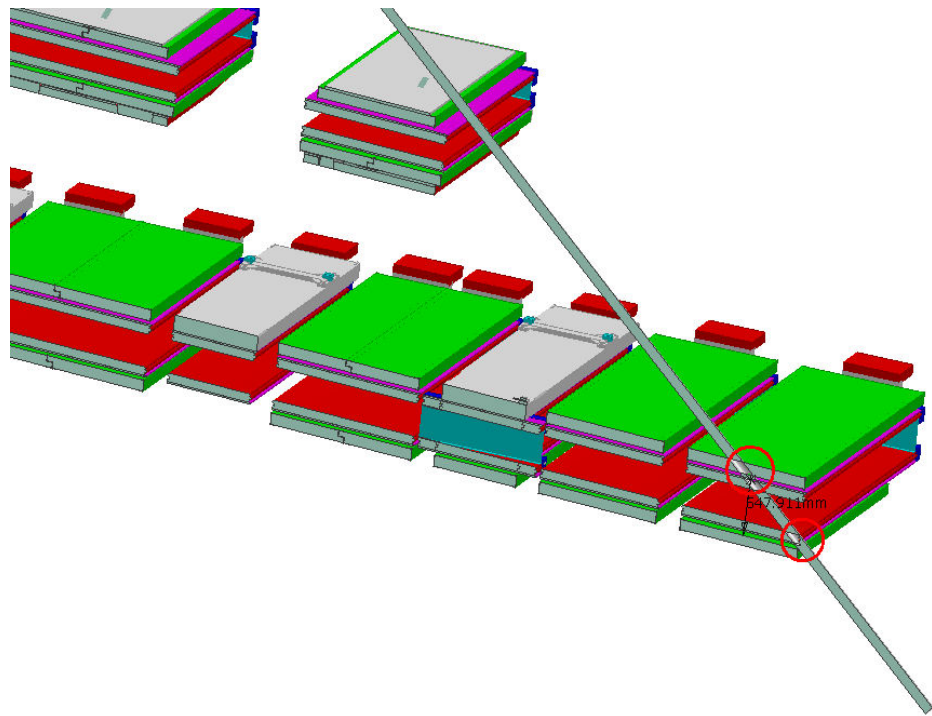

AT602166MQ - MUON BARREL  
CHAMBERS DETAILED, SECTOR 14

NMA\_0017 - SECTOR 14 SIDE C (A) - REFERENCE  
ALIGNMENT SYSTEM AND

Clash

-80.9 mm

Not inspected

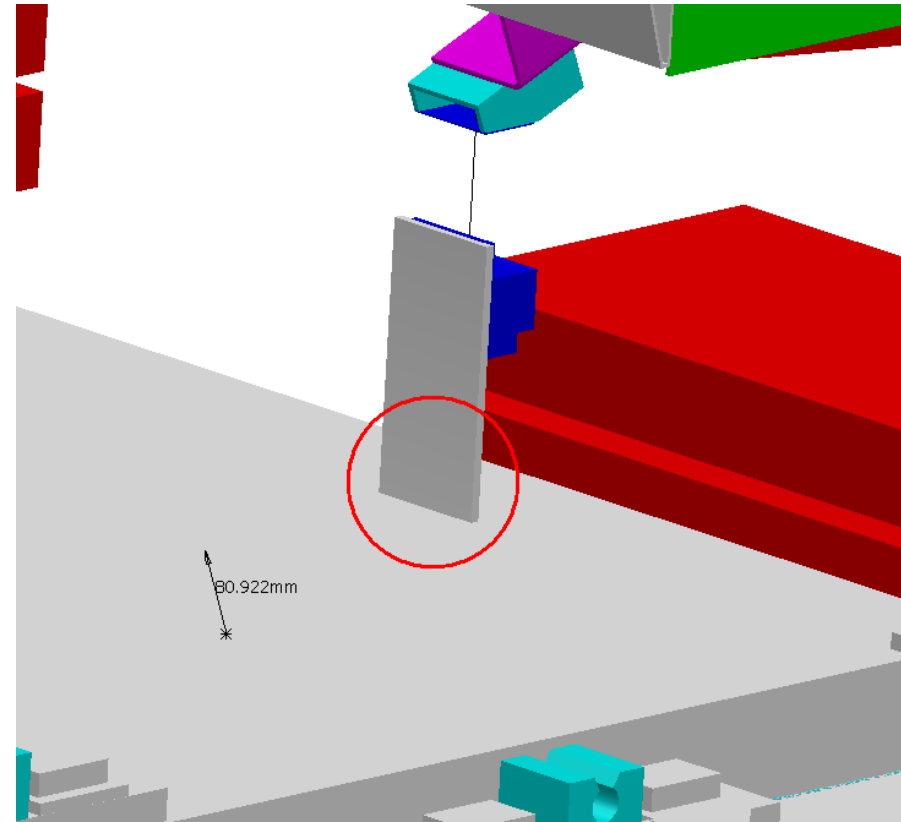
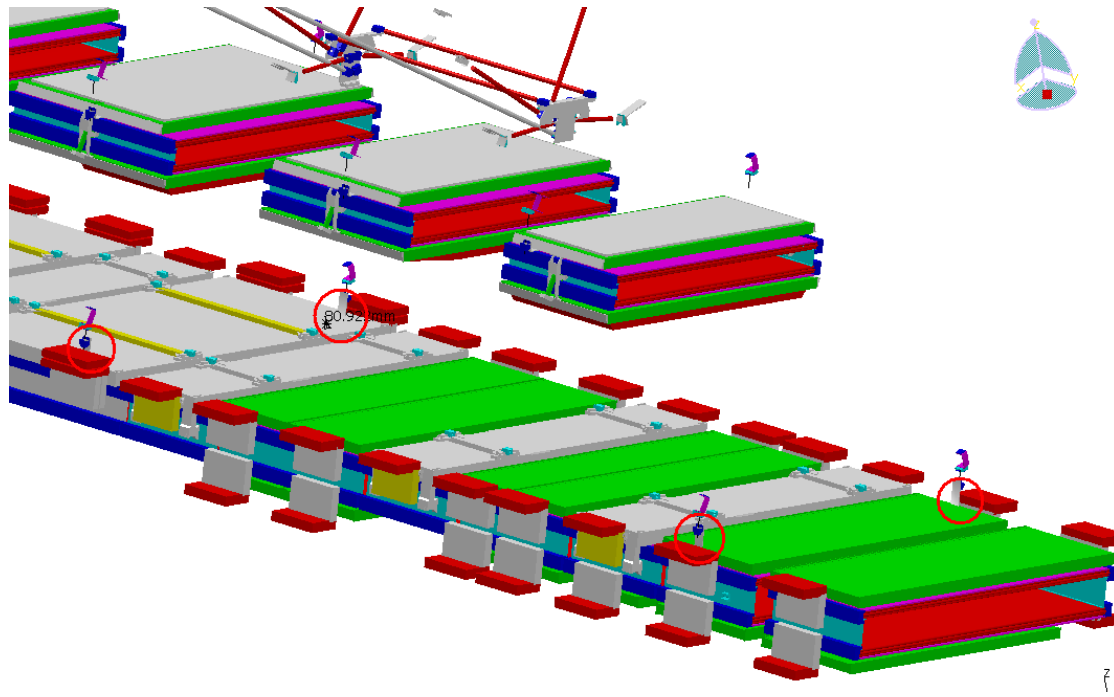

Clash value: ~ 80.9 mm

SIDE C

Sector 14

# Clash View:

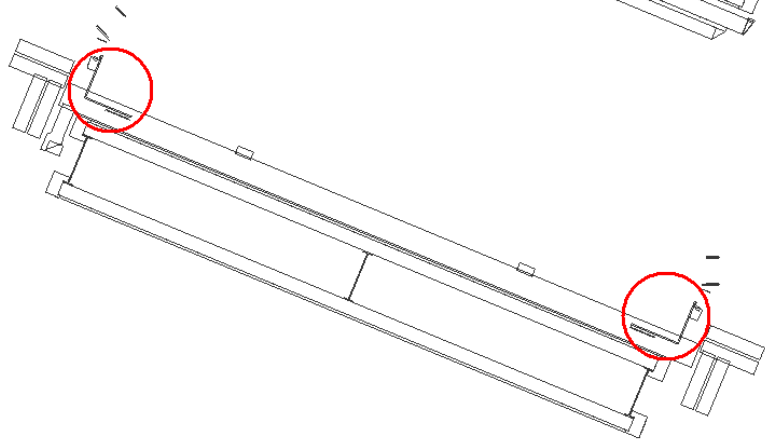
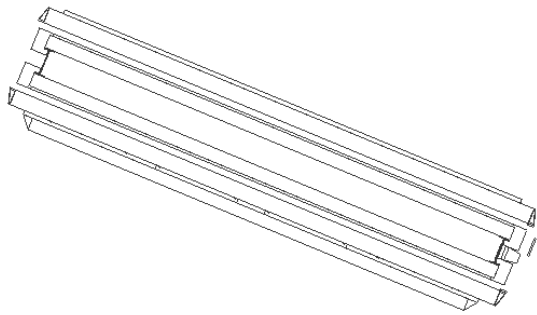
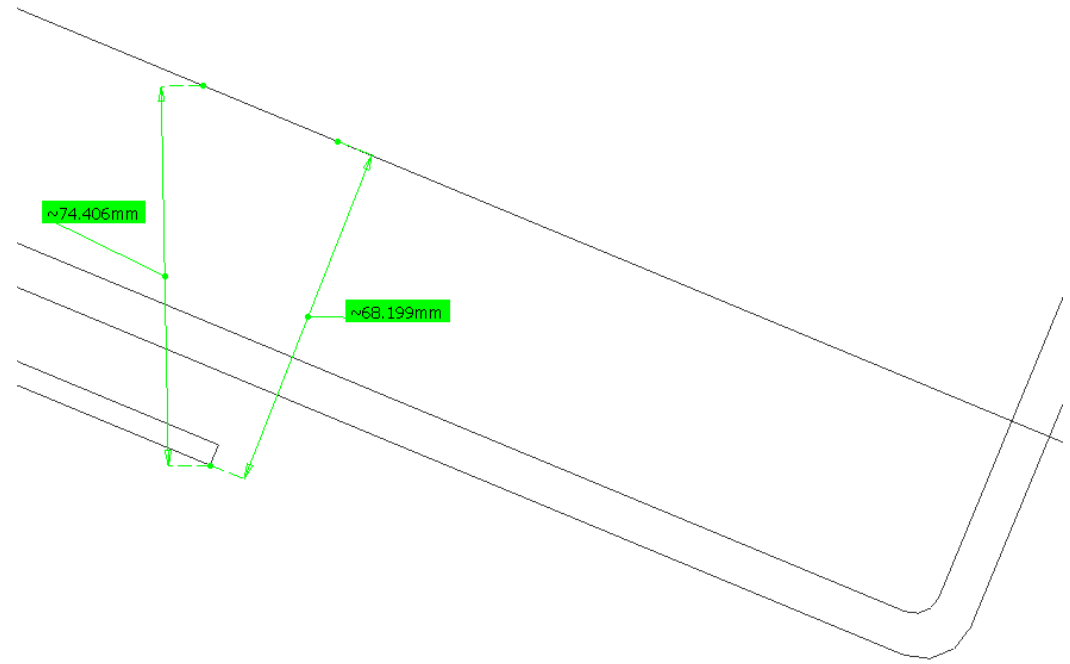
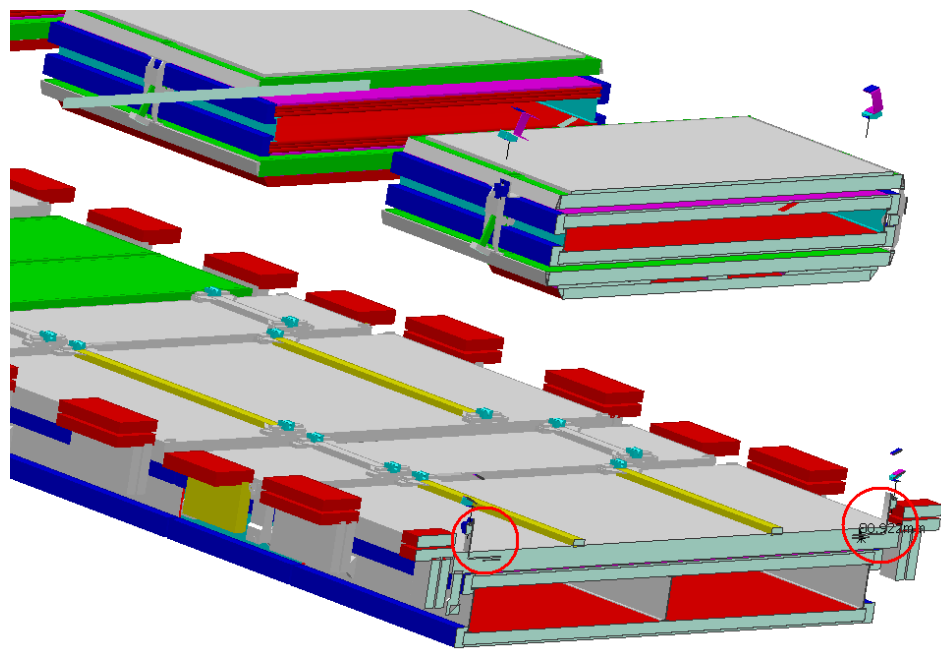

AT602166MQ - MUON BARREL  
CHAMBERS DETAILED, SECTOR 14

NSE\_0008 - EXTENDED TILE AIR-PAD CHAIN -  
IN DIFFERENT POSITIONS

Clash

-45.4 mm

Not inspected

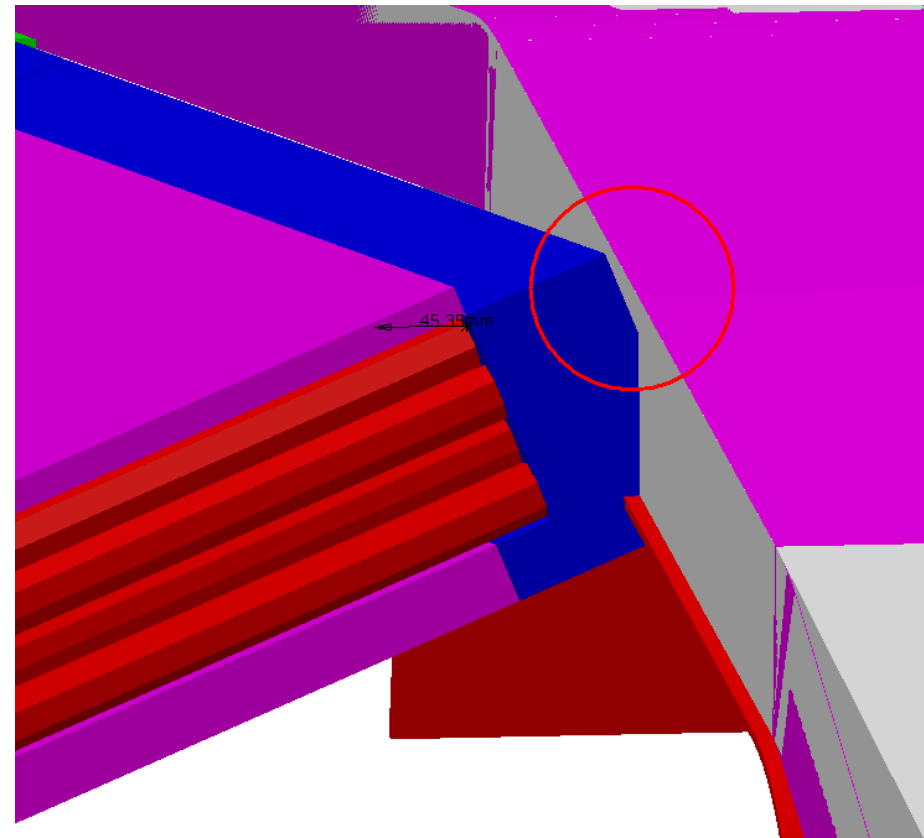
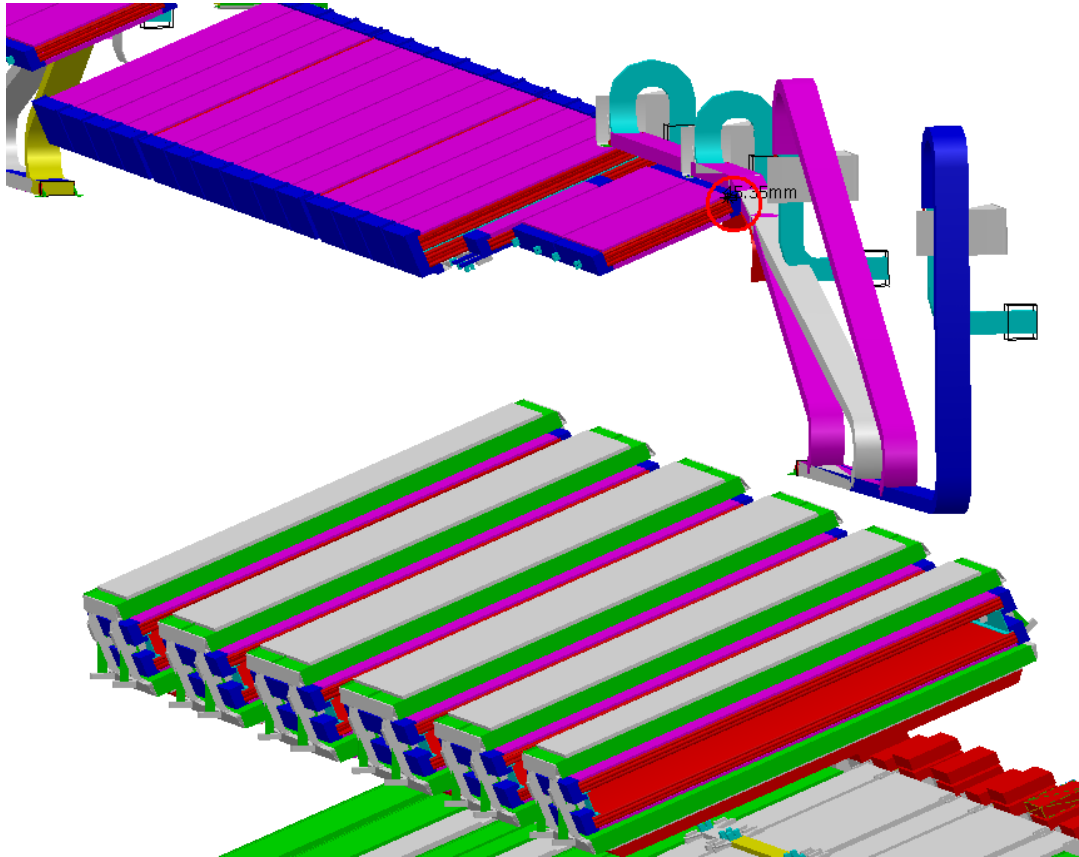

Clash value: ~ 45.4 mm

SIDE A-C

Sector 14

The identical clash exists on the opposite side

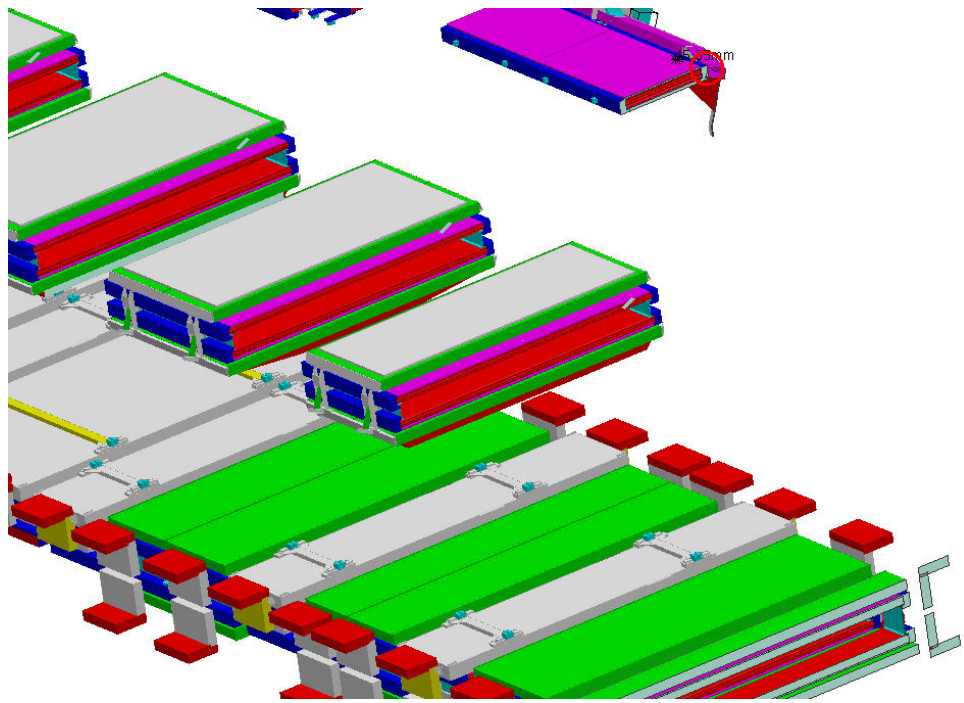

# Clash View:

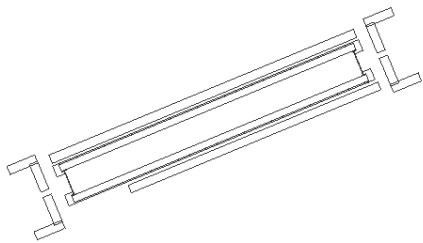
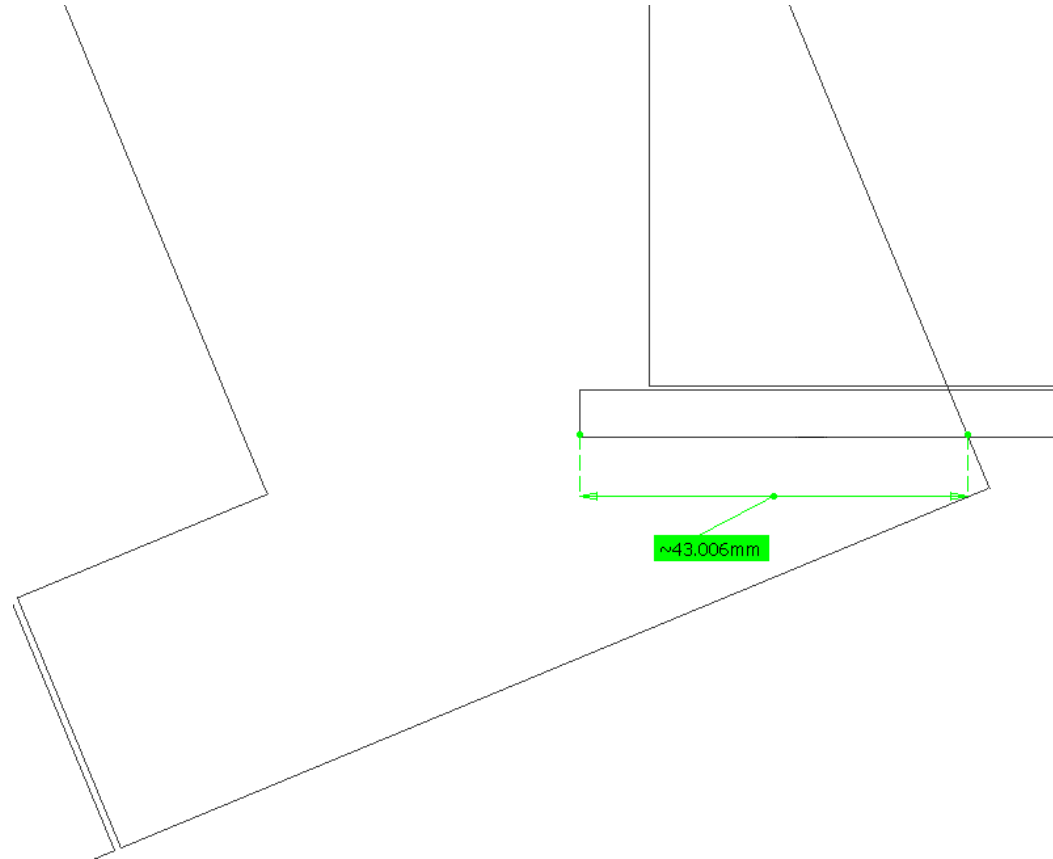



AT602166MQ - MUON BARREL  
CHAMBERS DETAILED, SECTOR 14

NSE\_0010 - SMALL WHEEL AIR-PAD CHAIN - IN  
2 POSITIONS

Clash

-24.6 mm

Not inspected

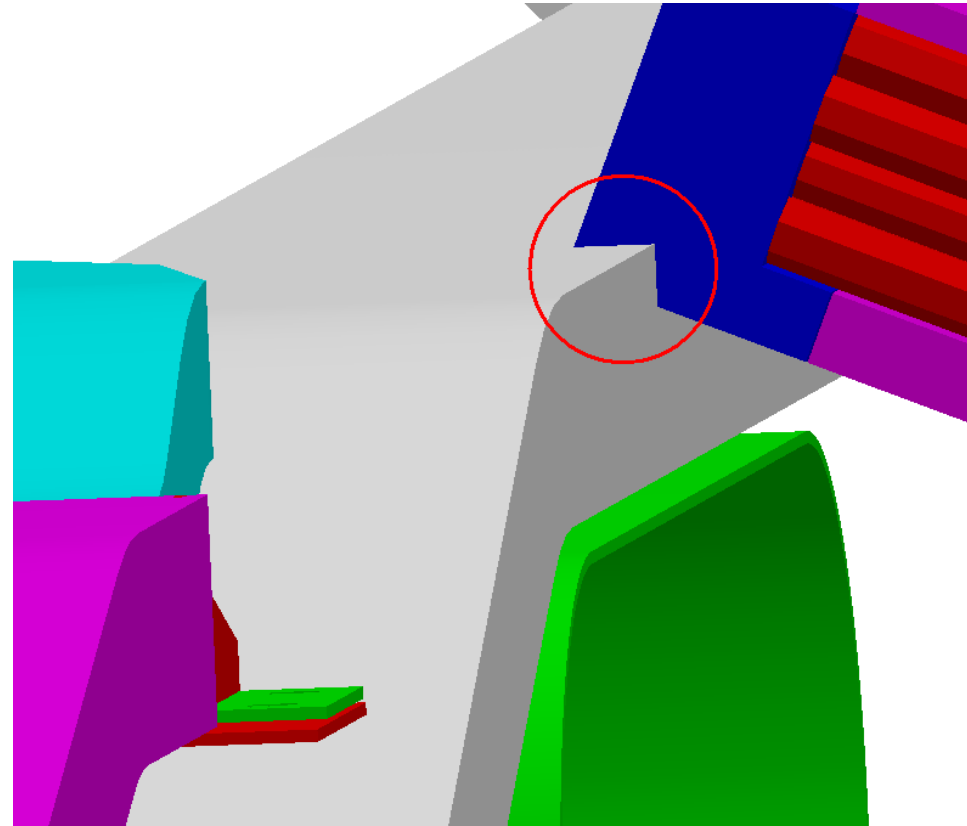
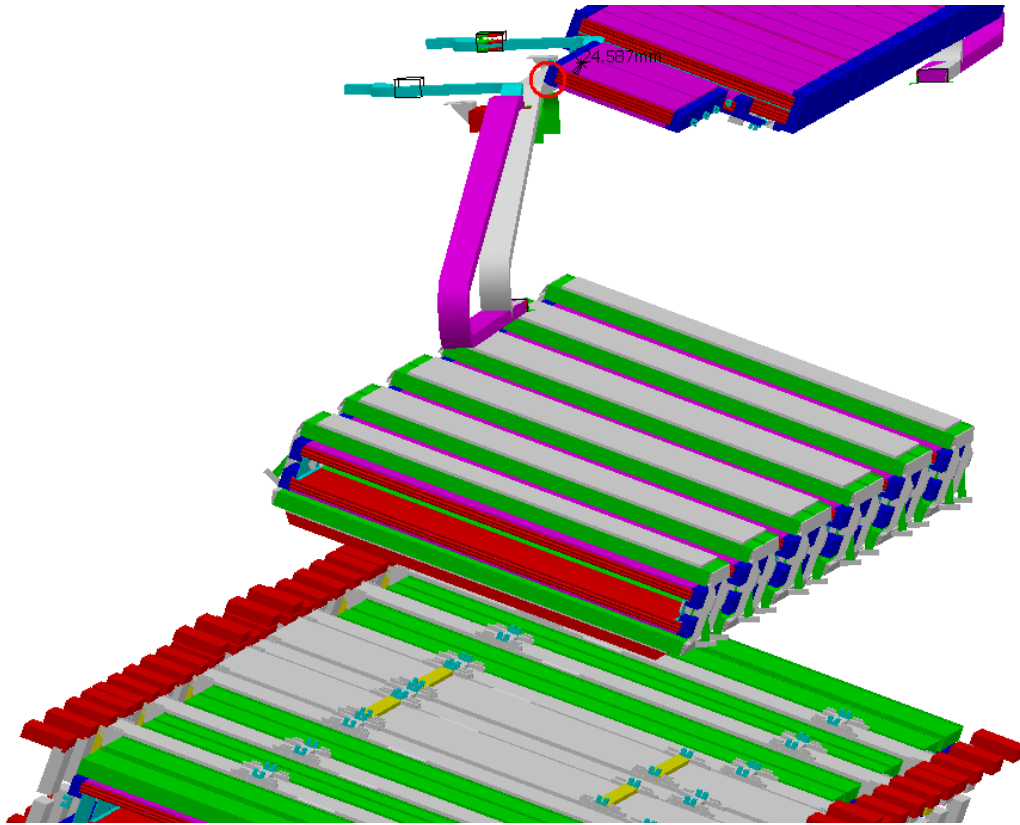

Clash value: ~ 24.6 mm

SIDE A-C

Sector 14

The identical clash exists on the opposite side

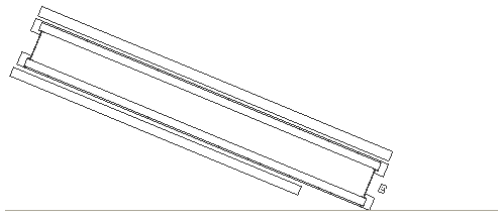
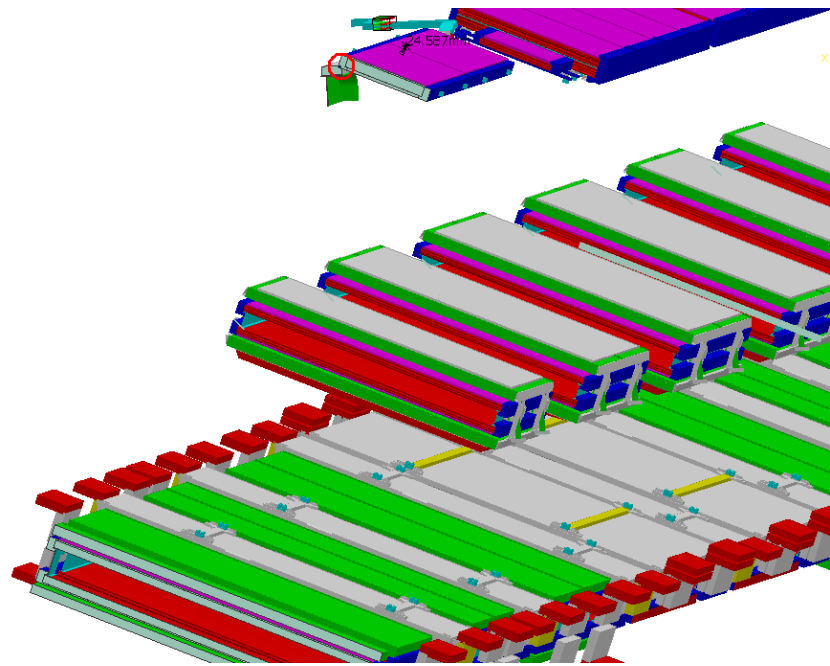

# Clash View:

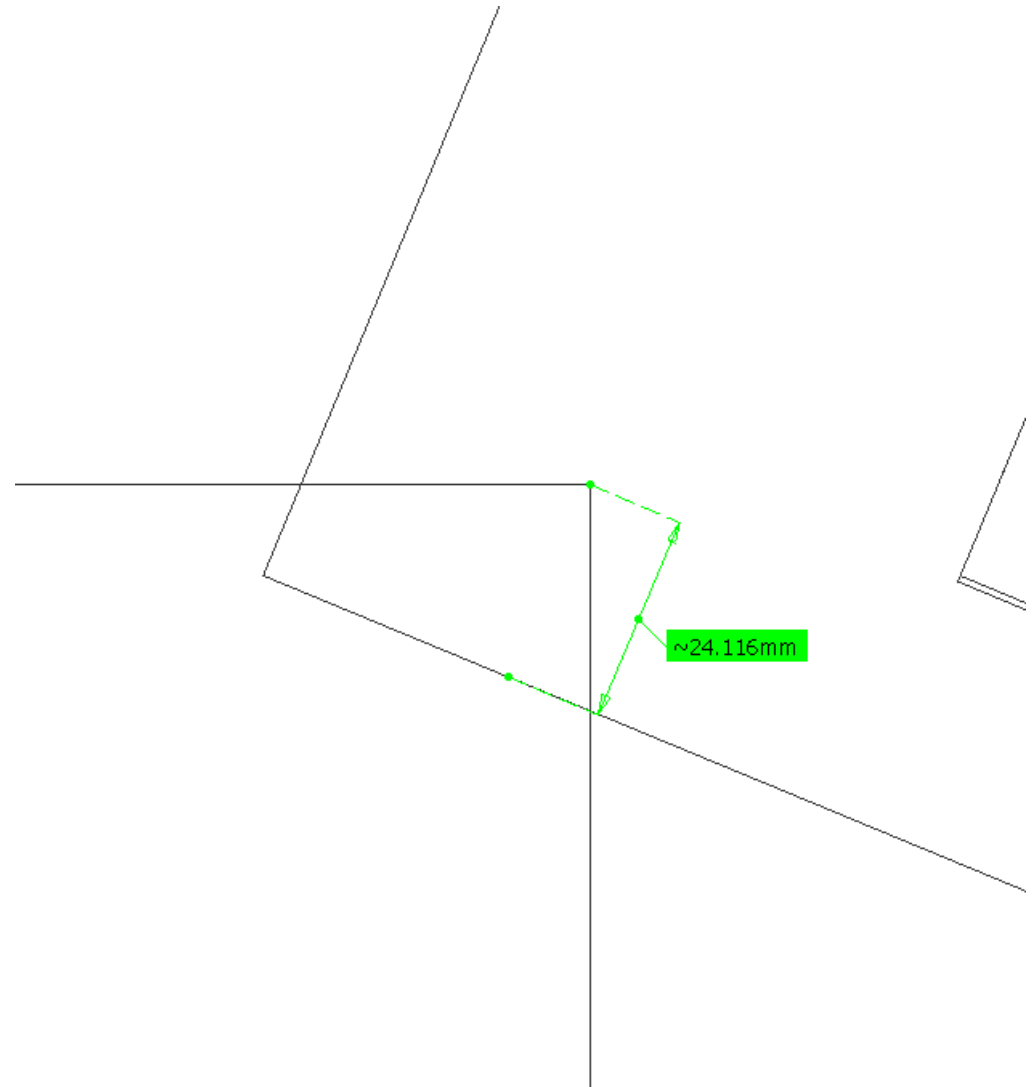

AT602166MQ - MUON BARREL  
CHAMBERS DETAILED, SECTOR 14

Z5\_0002 - Z5 GLOBAL ENVELOPE (SIDE A) - AND  
LOCATION INTERFACES

Clash

-123.7 mm

Not inspected

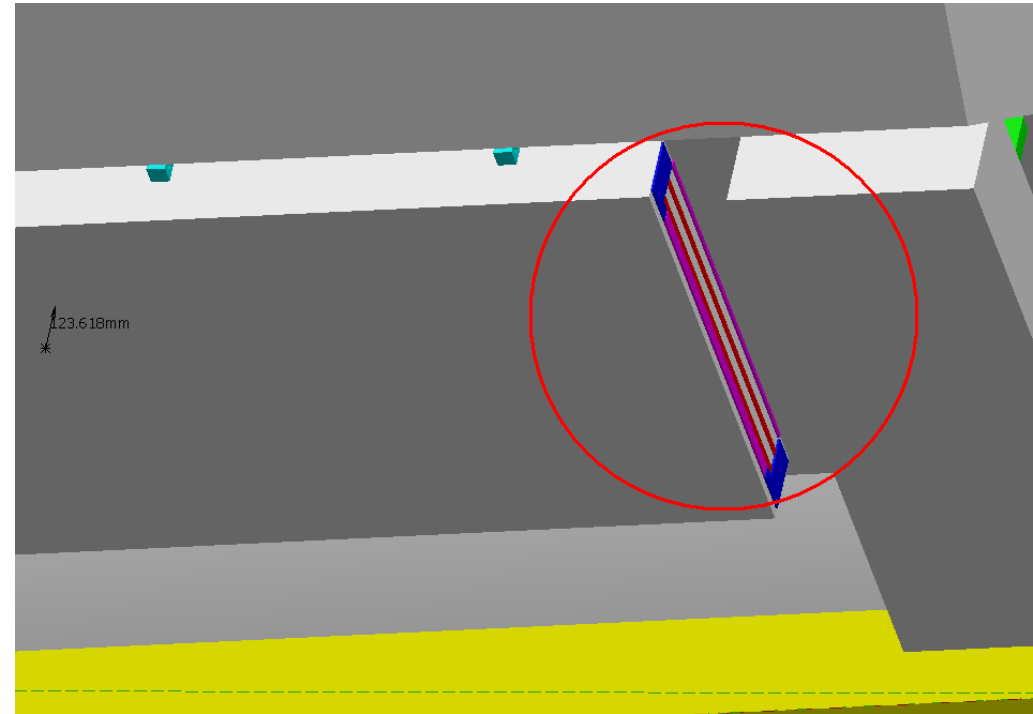
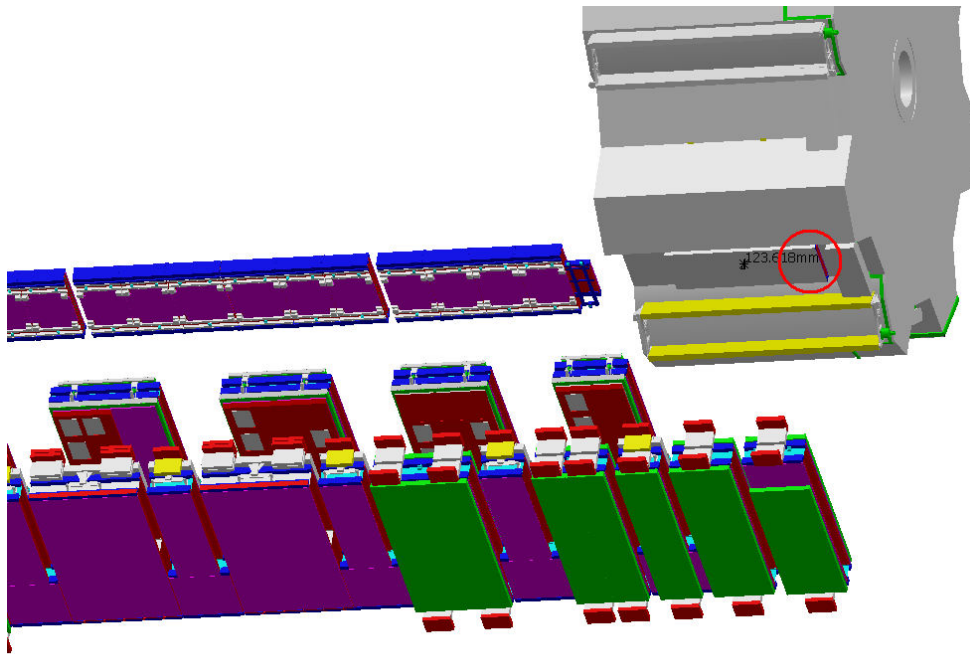

Clash value: ~ 123.7 mm

SIDE A

Sector 14

# Clash View:

