

Clearance Publish

Clearance = 50mm



Clearance Computation Specification

Clearance Computation Specification			
Products Selected		Value	Status
AT392112MQ - INNER DETECTOR PP2 + SERVICES	AT602154MQ Sec4 - MUON BARREL CHAMBERS DETAILED, SECTOR 4	30.4 mm	Not inspected
	AT602154MQ Sec6 - MUON BARREL CHAMBERS DETAILED, SECTOR 6	42.5 mm	Not inspected
	AT602154MQ - MUON BARREL CHAMBERS DETAILED, SECTOR 2	21.8 mm	Not inspected
	AT602155MQ - MUON BARREL CHAMBERS DETAILED, SECTOR 1	4.3 mm	Not inspected
	AT602159MQ - MUON BARREL CHAMBERS DETAILED, SECTOR 8	3.3 mm	Not inspected
	AT602160MQ - MUON BARREL CHAMBERS DETAILED, SECTOR 9	16.1mm	Not inspected

Products Selected		Value	Status
AT392112MQ - INNER DETECTOR PP2 + SERVICES	AT602164MQ - MUON BARREL CHAMBERS DETAILED, SECTOR 12	4 mm	Not inspected
	AT602166MQ - MUON BARREL CHAMBERS DETAILED, SECTOR 13	4 mm	Not inspected
	AT602168MQ - MUON BARREL CHAMBERS DETAILED, SECTOR 10	1.6 mm	Not inspected
	AT602342MQ - MUON BARREL CHAMBERS DETAILED, SECTOR 16	16.3 mm	Not inspected
	NMA_0014 - SECTOR 08 SIDE C (A) - REFERENCE ALIGNMENT SYSTEM AND	34.7 mm	Not inspected
	NMA_0015 - SECTOR 10 SIDE C (A) - REFERENCE ALIGNMENT SYSTEM AND	34.3 mm	Not inspected
	NMA_0018 - SECTOR 16 SIDE C (A) - REFERENCE ALIGNMENT SYSTEM AND	37.6 mm	Not inspected
	NSB_0002 - BARREL PROJECTIVE ALIGNMENT. - SIMPLE 3-D MODEL. SECTOR 3	4.6 mm	Not inspected
	NSB_0007 - BARREL PROJECTIVE ALIGNMENT. - SIMPLE 3-D MODEL. SECTOR 13	12.5 mm	Not inspected
	NTB_0001 BT2 - TB STANDARD COIL - SECTOR 2	42.6 mm	Not inspected
	NTB_0001 BT8 - TB STANDARD COIL - SECTOR 8	42.6 mm	Not inspected
	NTB_0001 BT10 - TB STANDARD COIL - SECTOR 10	41.4 mm	Not inspected

Computation Result:

AT392112MQ - INNER DETECTOR PP2 + SERVICES	AT602154MQ Sec4 - MUON BARREL CHAMBERS DETAILED, SECTOR 4	Clearance	30.4 mm			Not inspected
			$\Delta X \approx -15.7$	$\Delta Y \approx 26$	$\Delta Z \approx 0$	

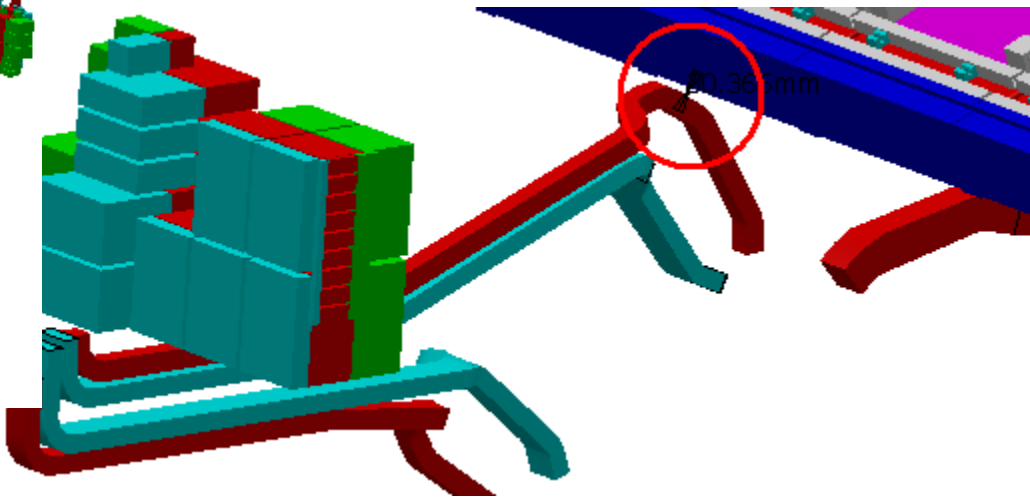
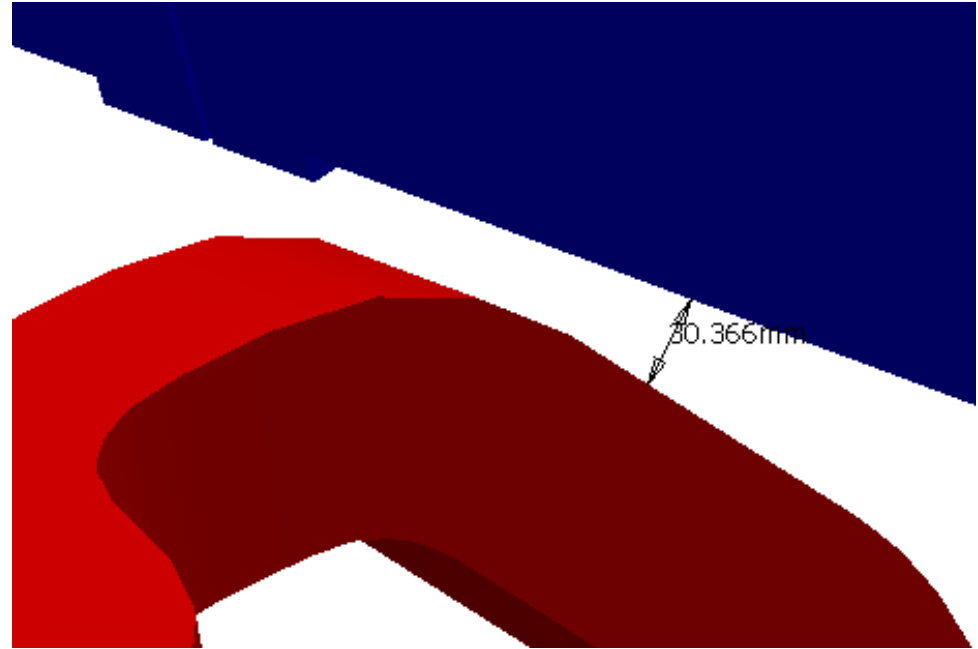
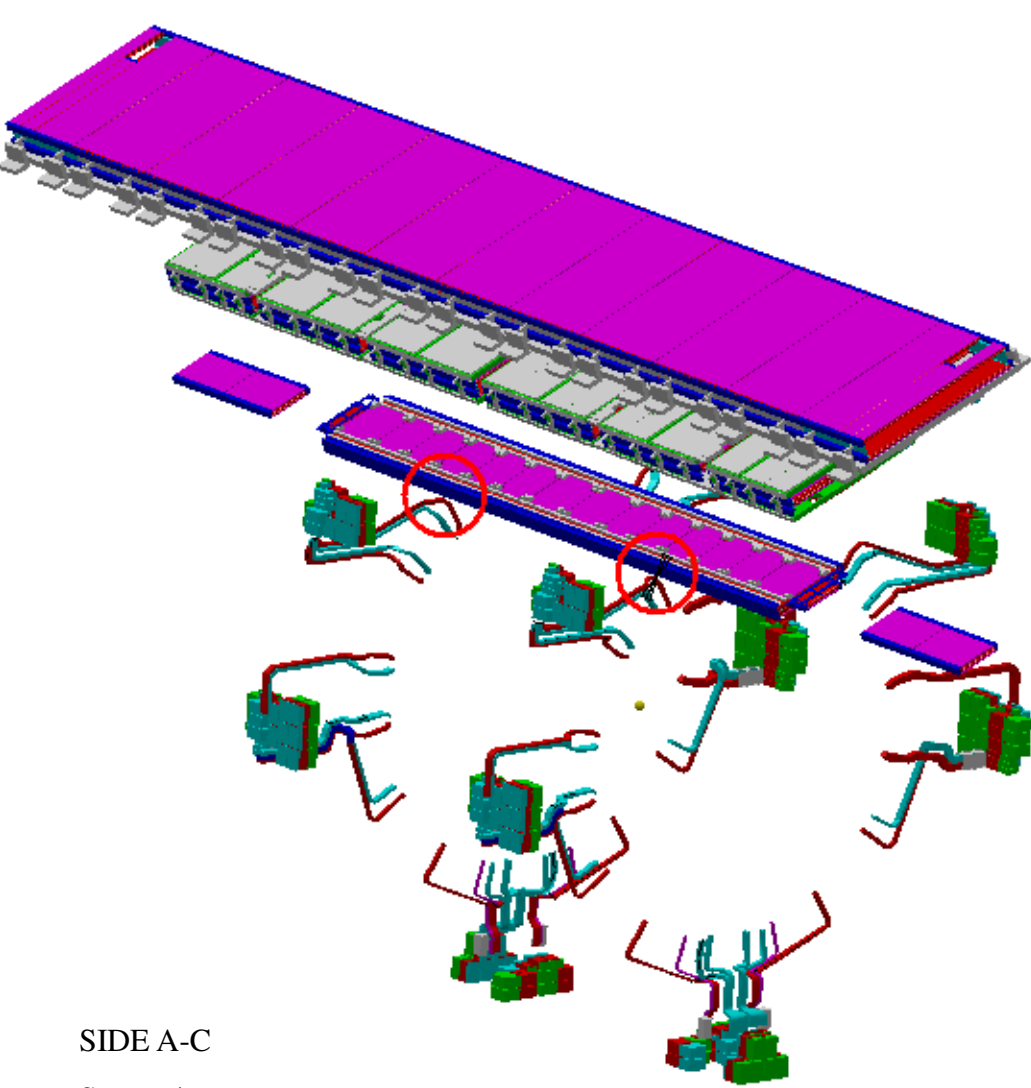

SIDE A-C
Sector 4

AT392112MQ - INNER DETECTOR PP2 + SERVICES	AT602154MQ Sec6 - MUON BARREL CHAMBERS DETAILED, SECTOR 6	Clearance	42.5 mm			Not inspected
			$\Delta X \approx 22$	$\Delta Y \approx 36$	$\Delta Z \approx 0$	

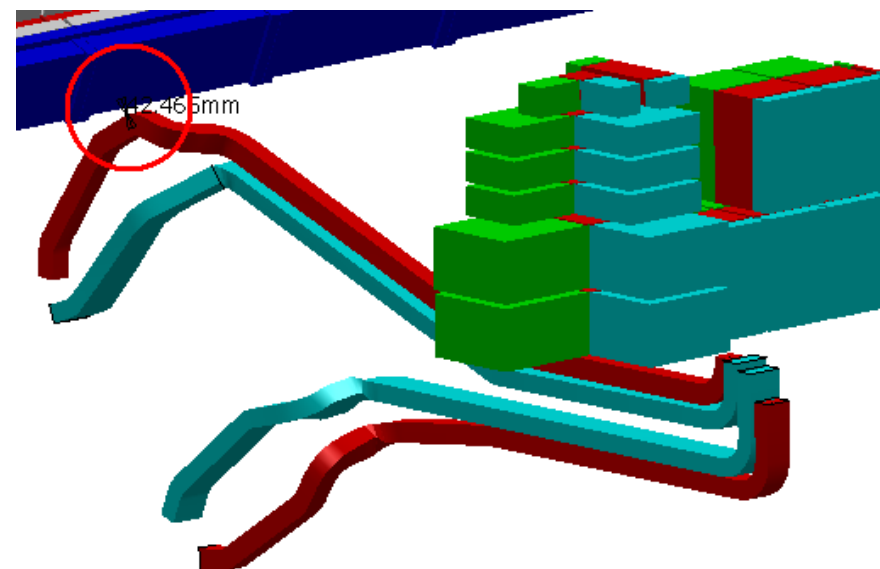
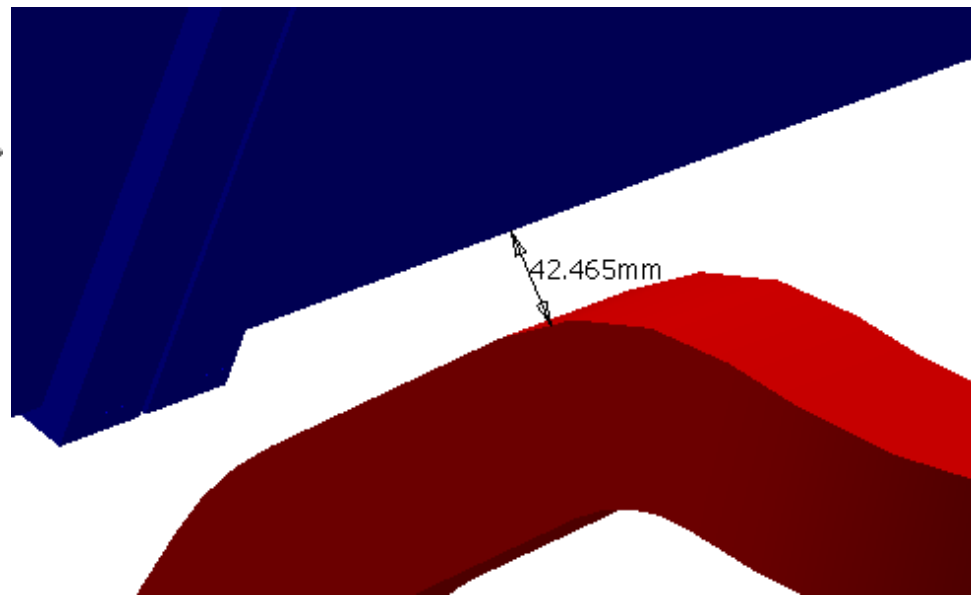
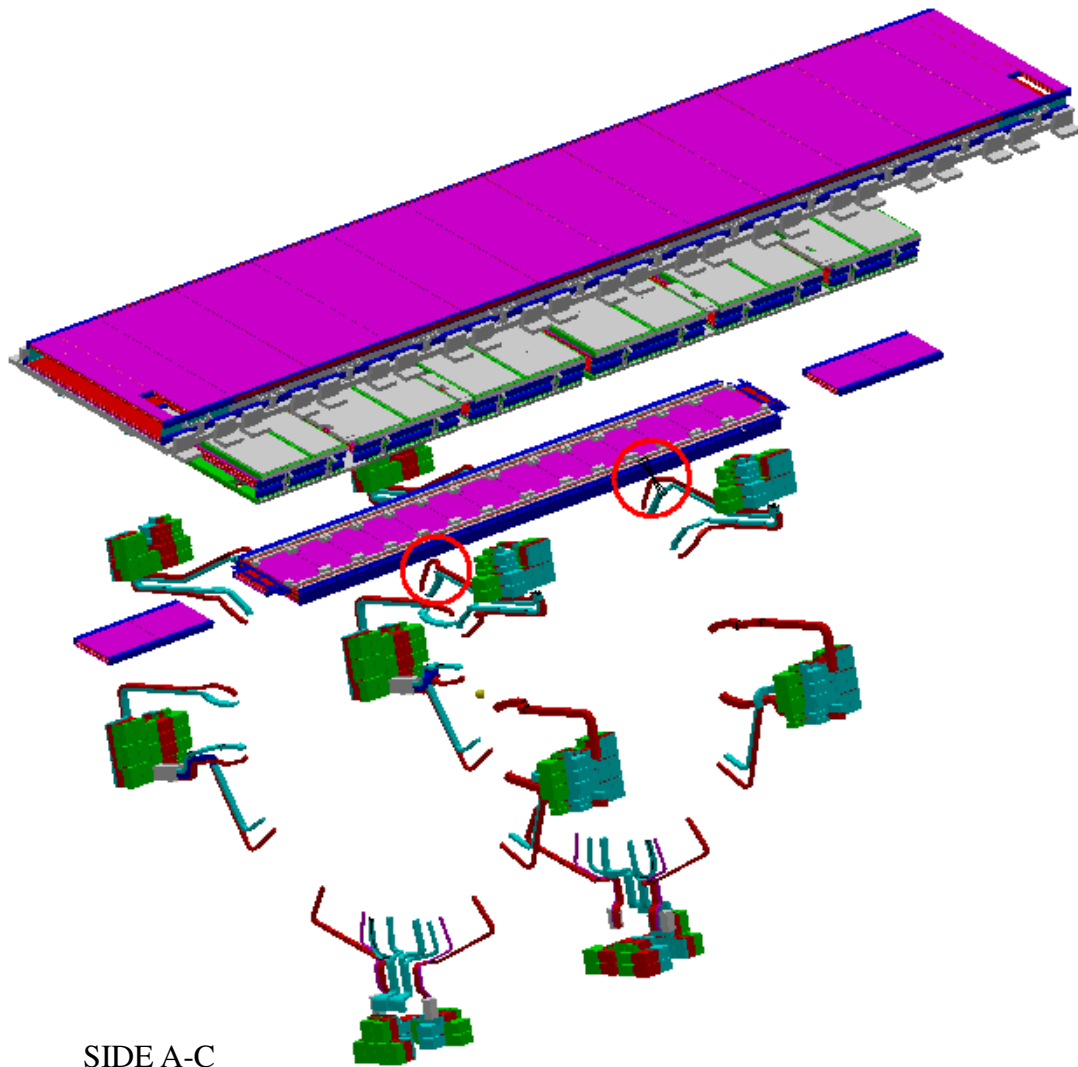

SIDE A-C
Sector 6

AT392112MQ - INNER DETECTOR PP2 + SERVICES	AT602154MQ - MUON BARREL CHAMBERS DETAILED, SECTOR 2	Clearance	21.8 mm			Not inspected
			$\Delta X \approx 5.2$	$\Delta Y \approx 21$	$\Delta Z \approx 0$	

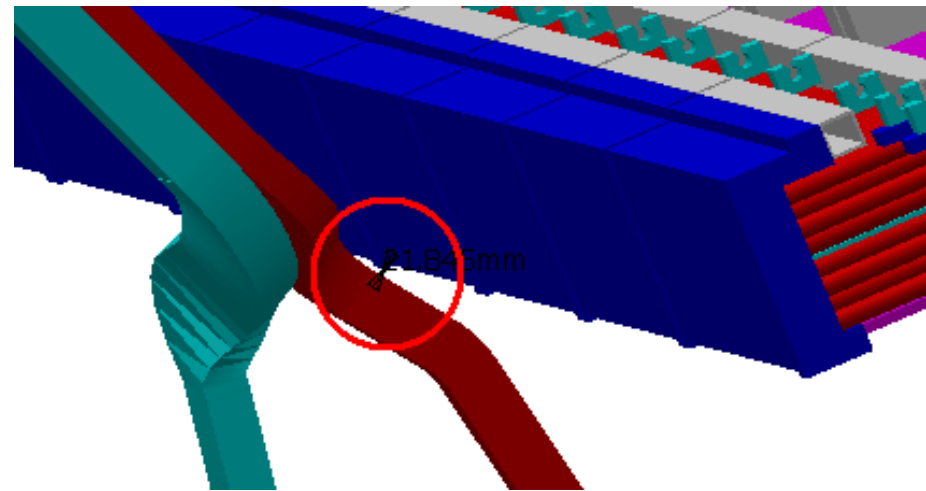
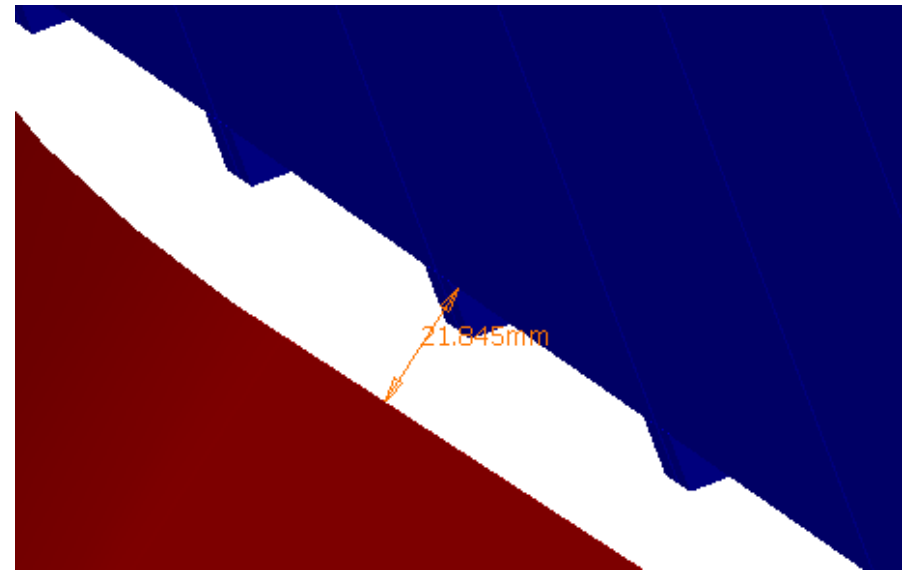
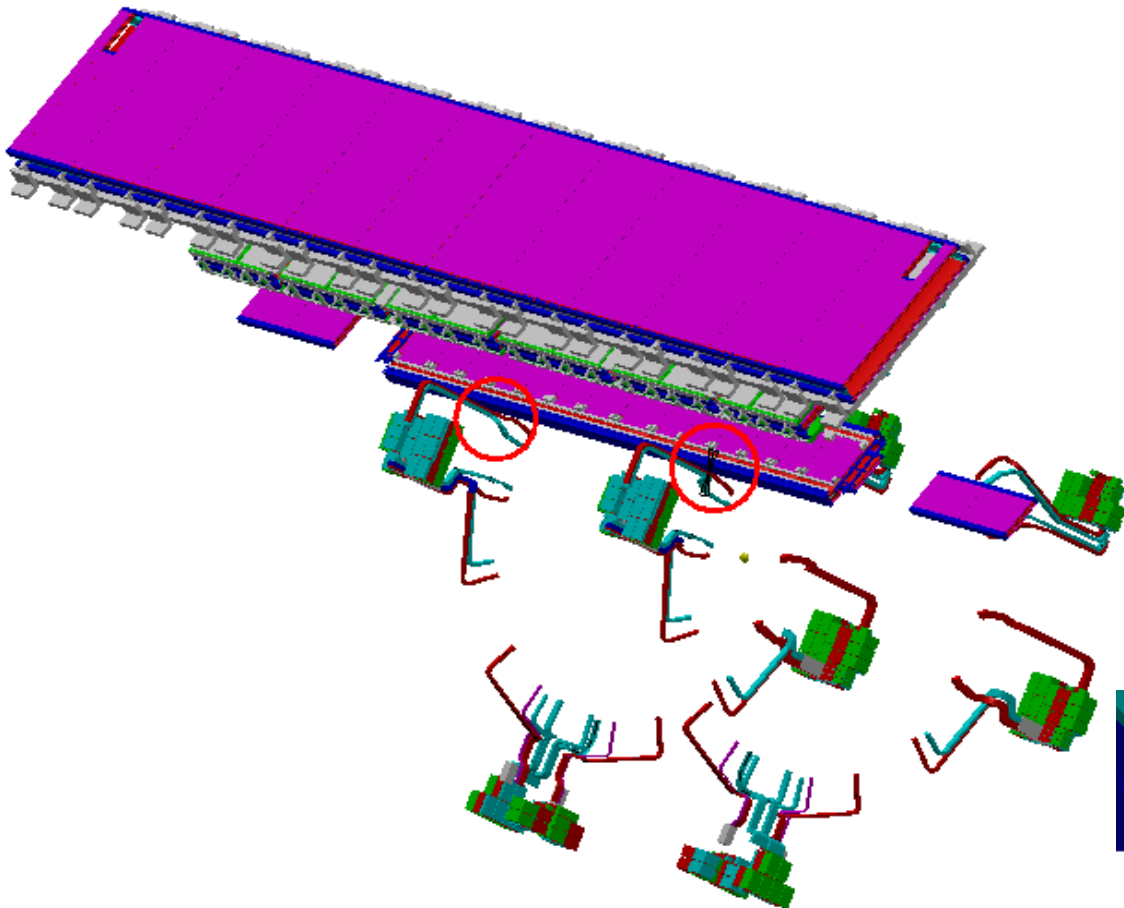

SIDE A-C
Sector 2

AT392112MQ - INNER DETECTOR PP2 + SERVICES	AT602155MQ - MUON BARREL CHAMBERS DETAILED, SECTOR 1	Clearance	4.3 mm			Not inspected
			$\Delta X \approx 0$	$\Delta Y \approx 0$	$\Delta Z \approx 4.3$	

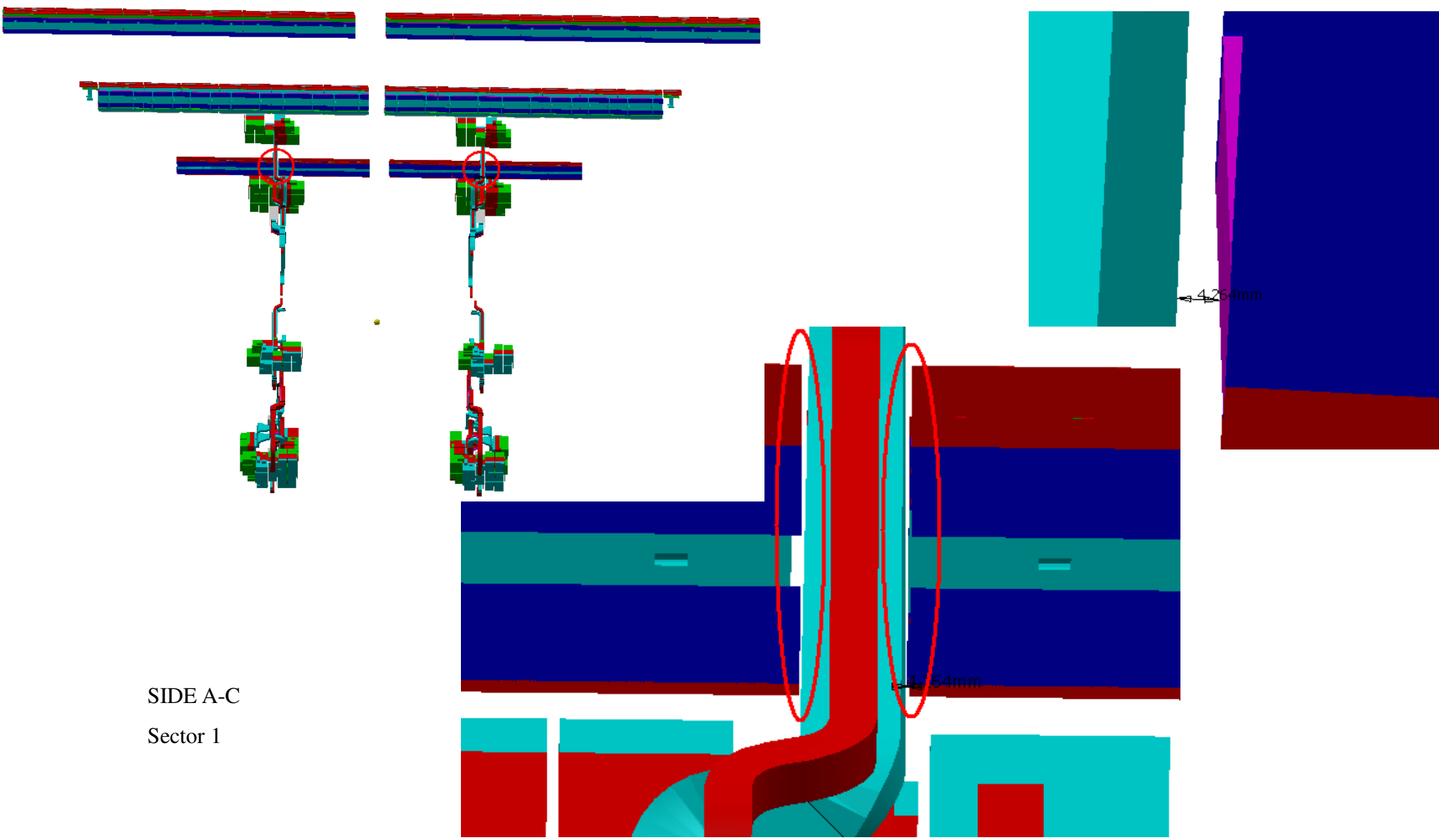

SIDE A-C
Sector 1

AT392112MQ - INNER DETECTOR PP2 + SERVICES	AT602159MQ - MUON BARREL CHAMBERS DETAILED, SECTOR 8	Clearance	3.3 mm			Not inspected
			$\Delta X \approx 1$	$\Delta Y \approx 2.4$	$\Delta Z \approx -2$	

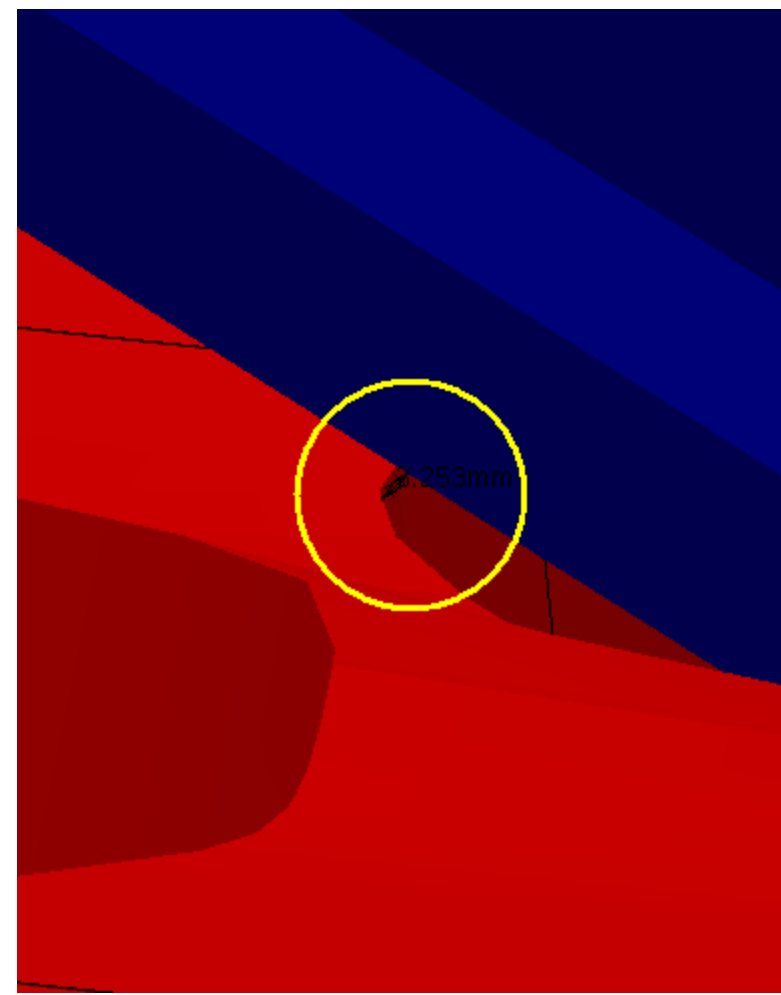
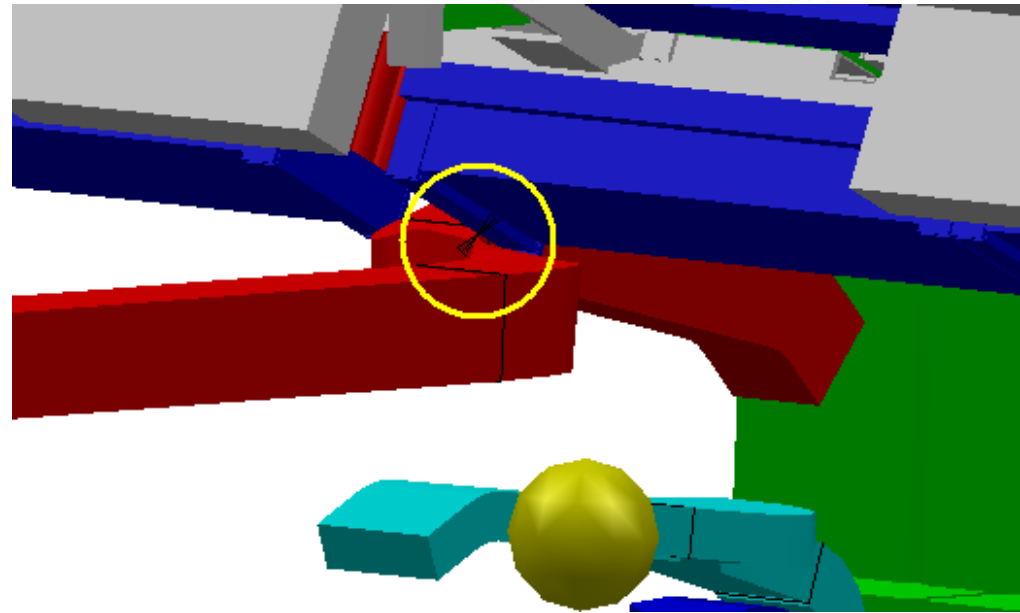
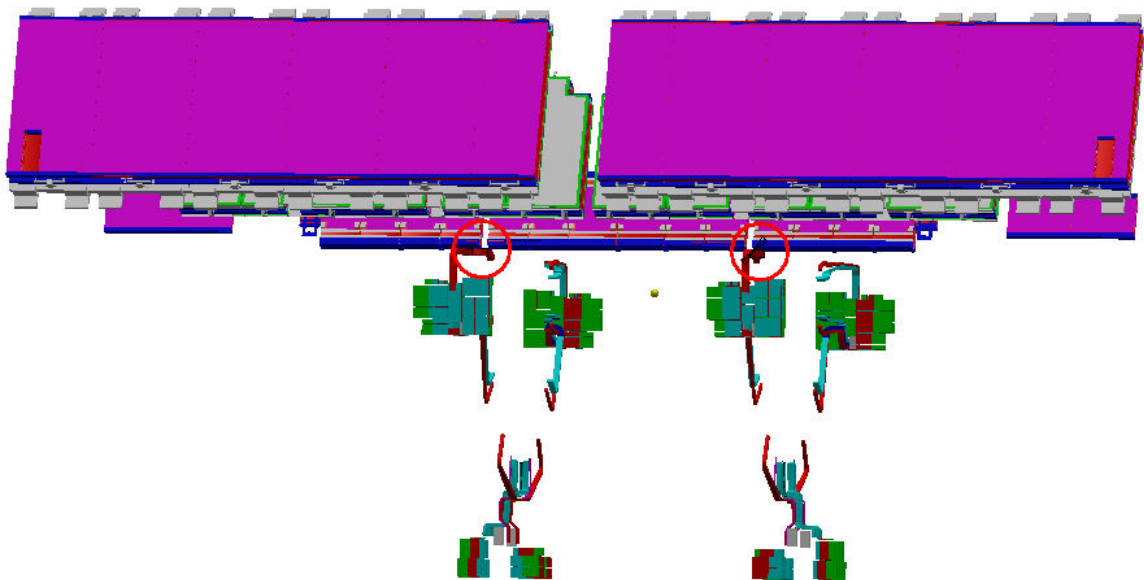

SIDE A-C
Sector 8

AT392112MQ - INNER DETECTOR PP2 + SERVICES	AT602160MQ - MUON BARREL CHAMBERS DETAILED, SECTOR 9	Clearance	16.1mm			Not inspected
			$\Delta X \approx 0$	$\Delta Y \approx 0$	$\Delta Z \approx 16.1$	

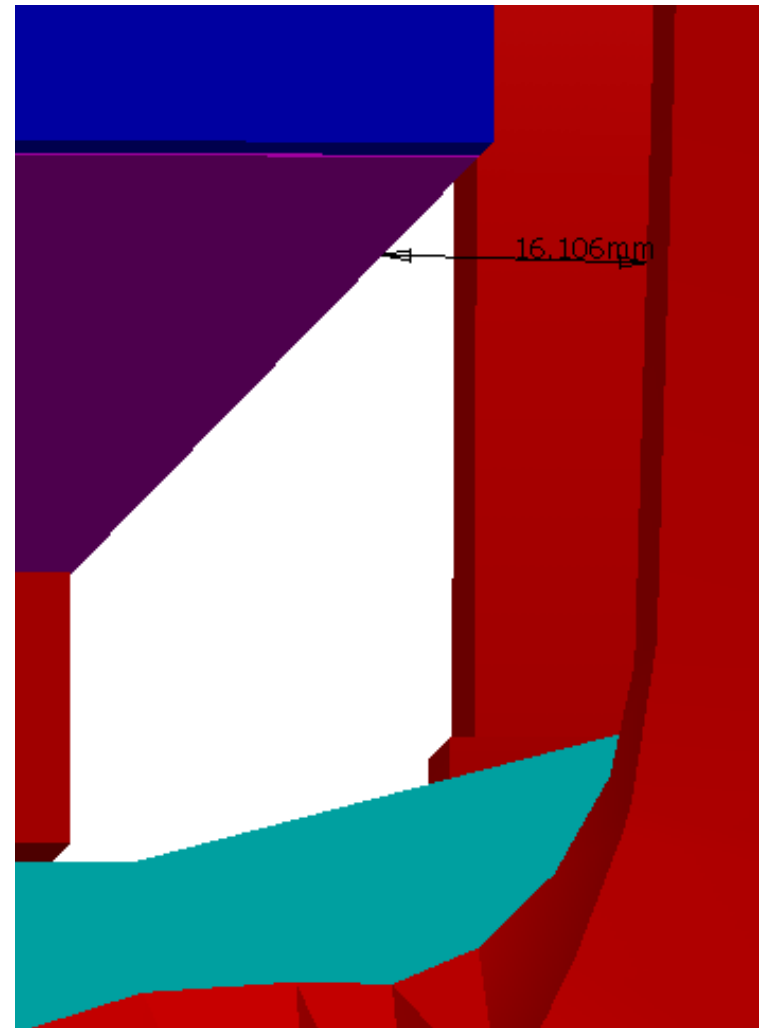
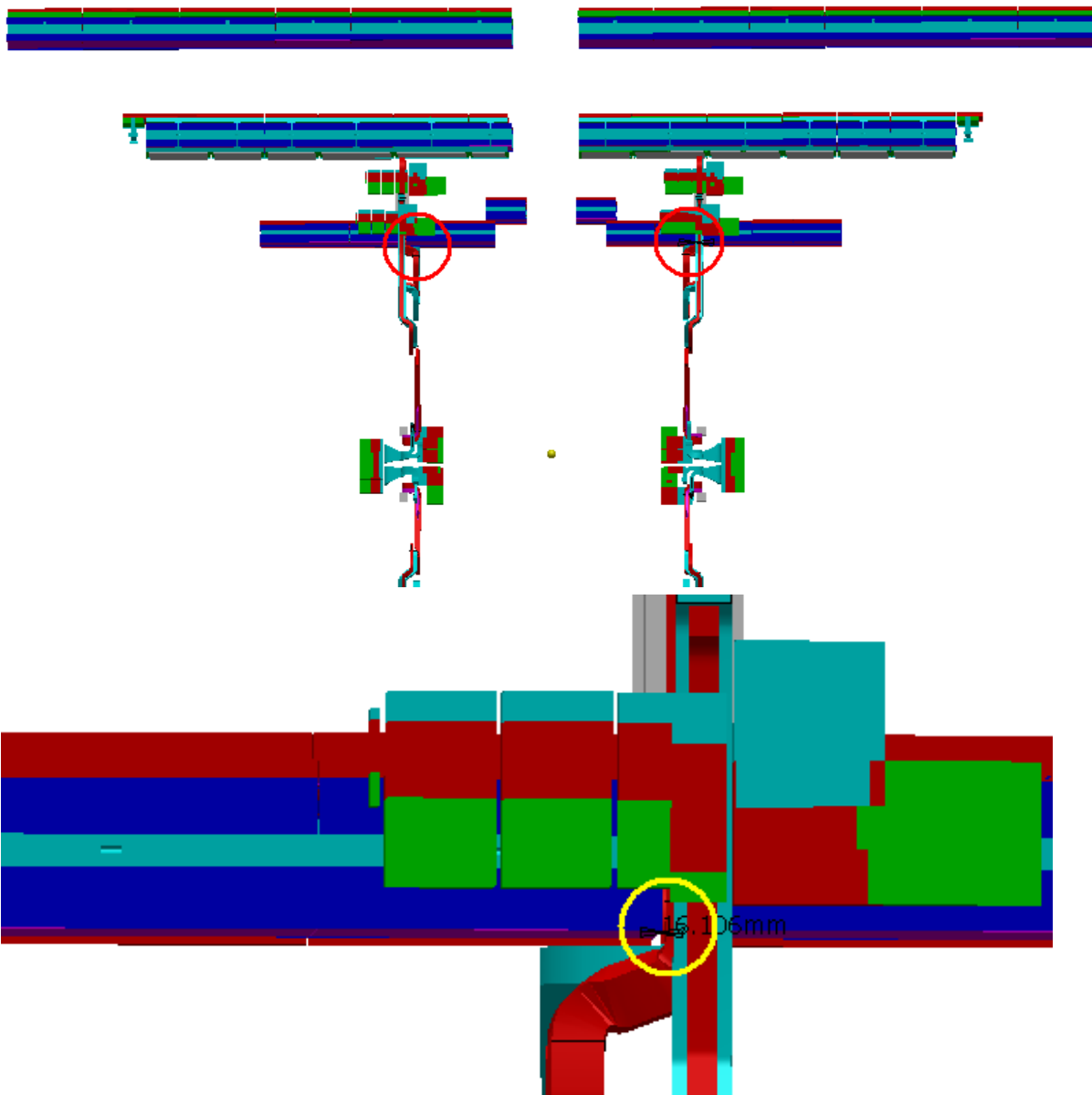

SIDE A-C
Sector 9

AT392112MQ - INNER DETECTOR PP2 + SERVICES	AT602164MQ - MUON BARREL CHAMBERS DETAILED, SECTOR 12	Clearance	4 mm			Not inspected
			$\Delta X \approx 0$	$\Delta Y \approx 0$	$\Delta Z \approx 4$	

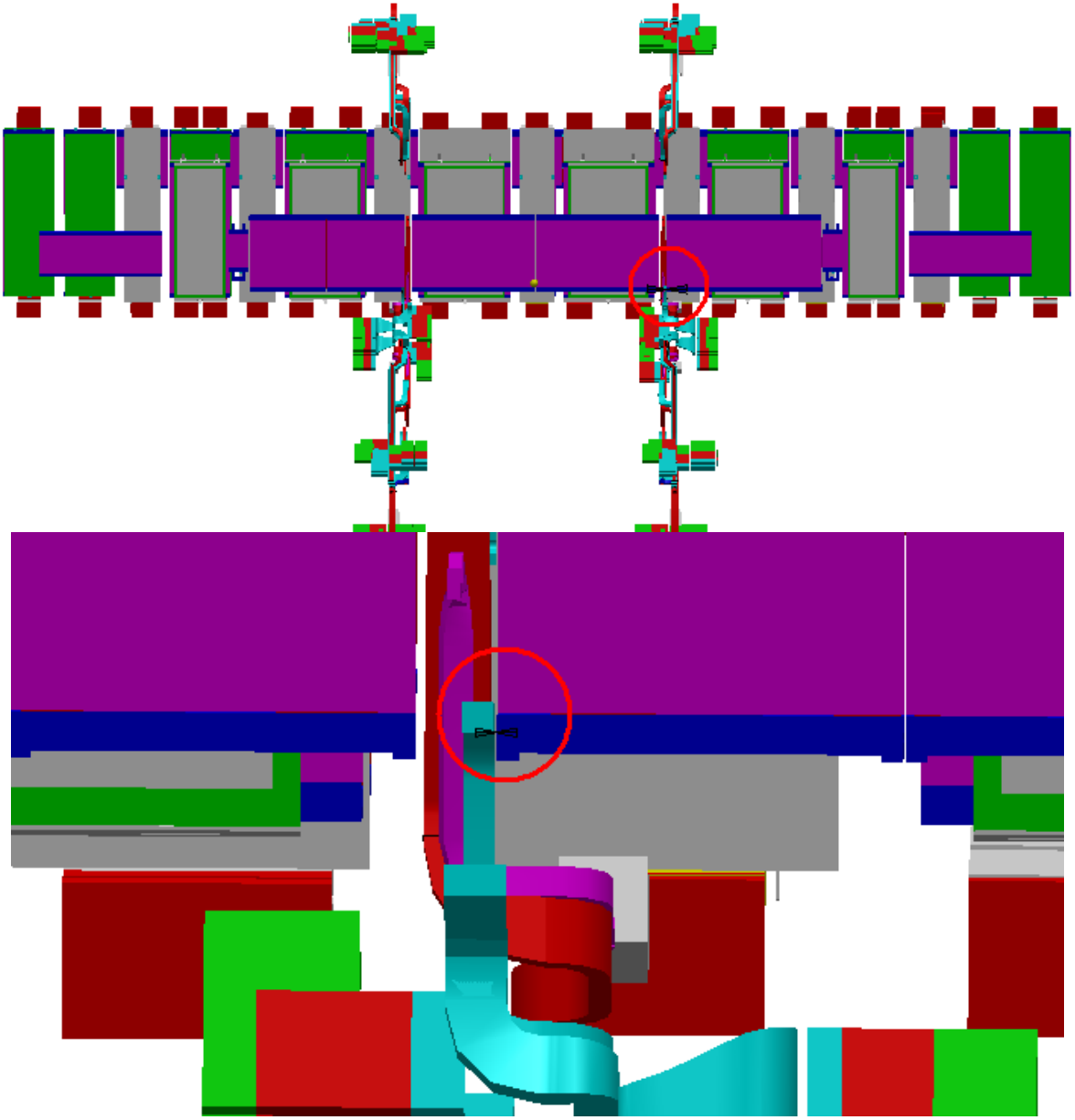

SIDE C
Sector 12

AT392112MQ - INNER DETECTOR PP2 + SERVICES	AT602166MQ - MUON BARREL CHAMBERS DETAILED, SECTOR 13	Clearance	4 mm			Not inspected
			$\Delta X \approx 0$	$\Delta Y \approx 0$	$\Delta Z \approx -4$	

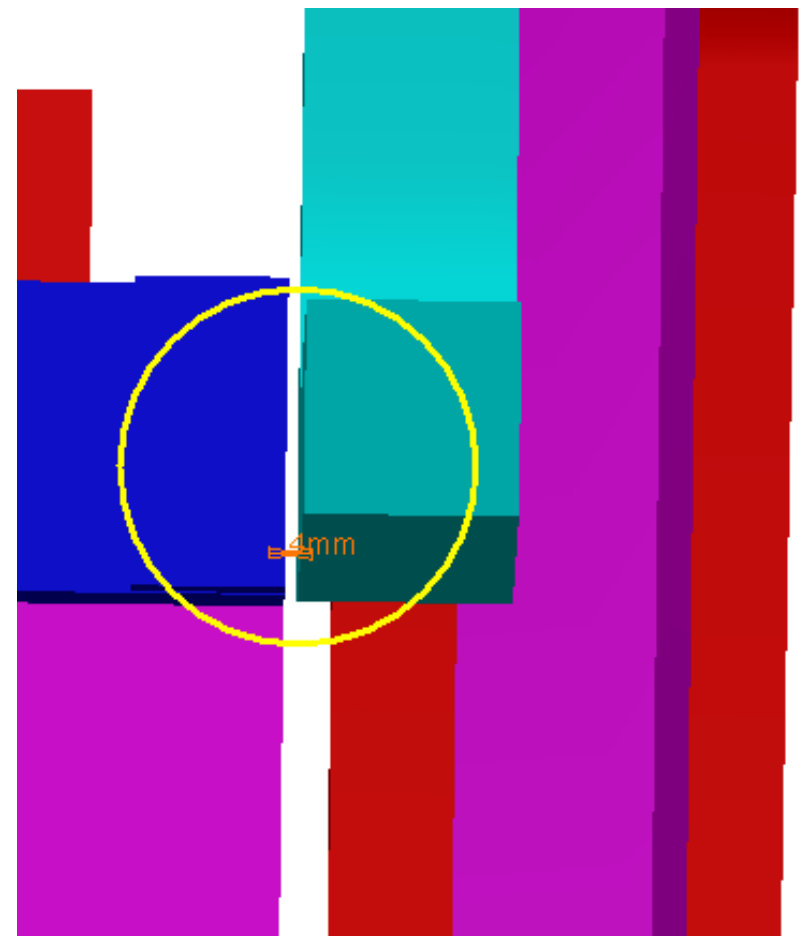
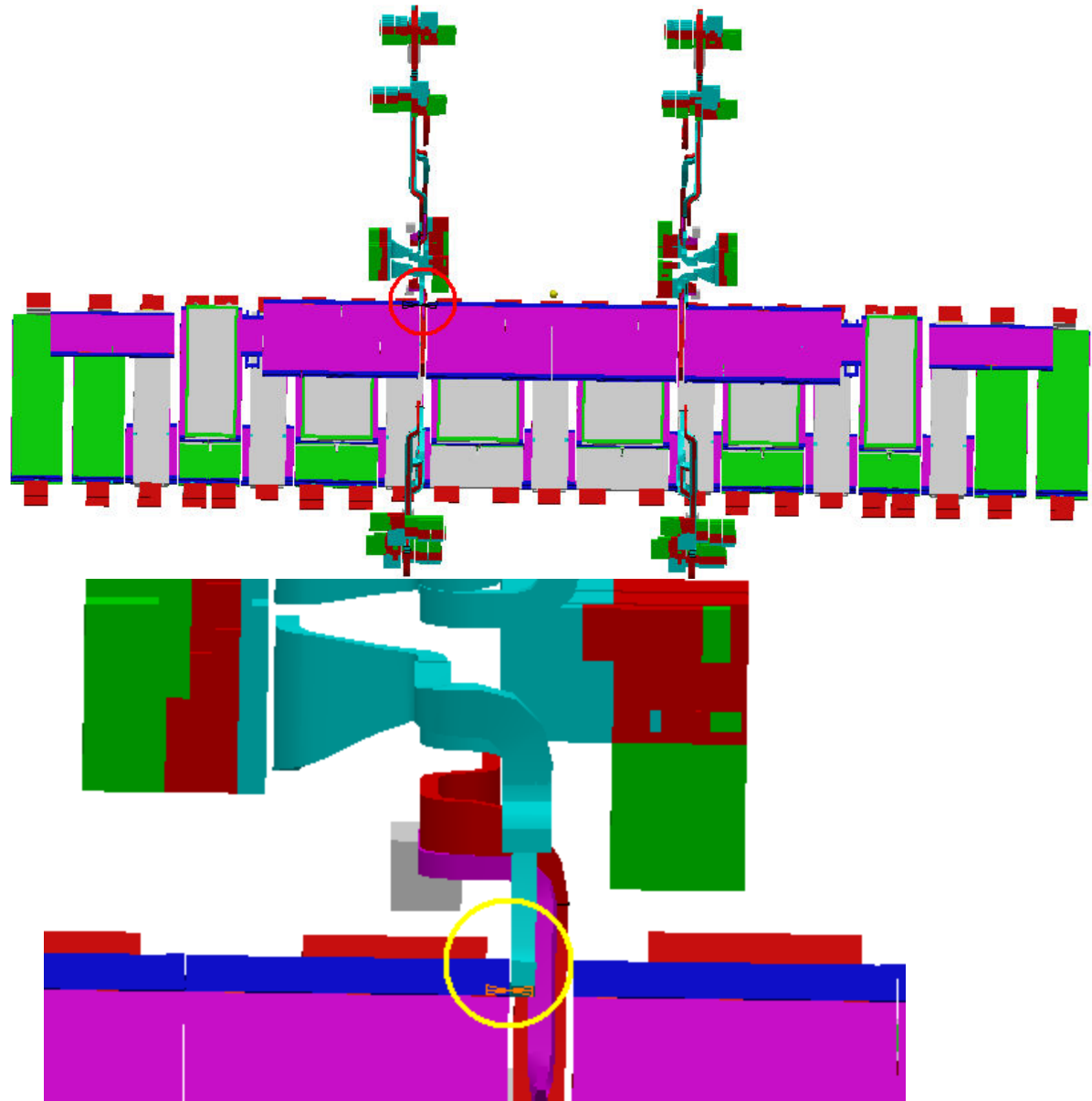

SIDE A
Sector 13

AT392112MQ - INNER DETECTOR PP2 + SERVICES	AT602168MQ - MUON BARREL CHAMBERS DETAILED, SECTOR 10	Clearance	1.6 mm			Not inspected
			$\Delta X \approx 0$	$\Delta Y \approx -1$	$\Delta Z \approx -1.3$	

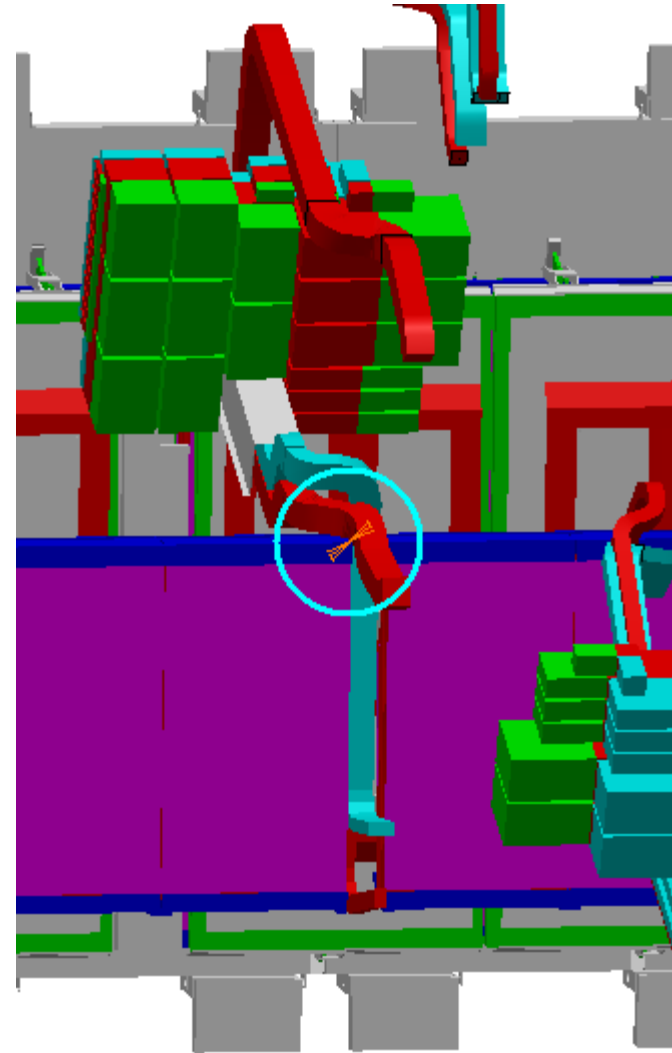
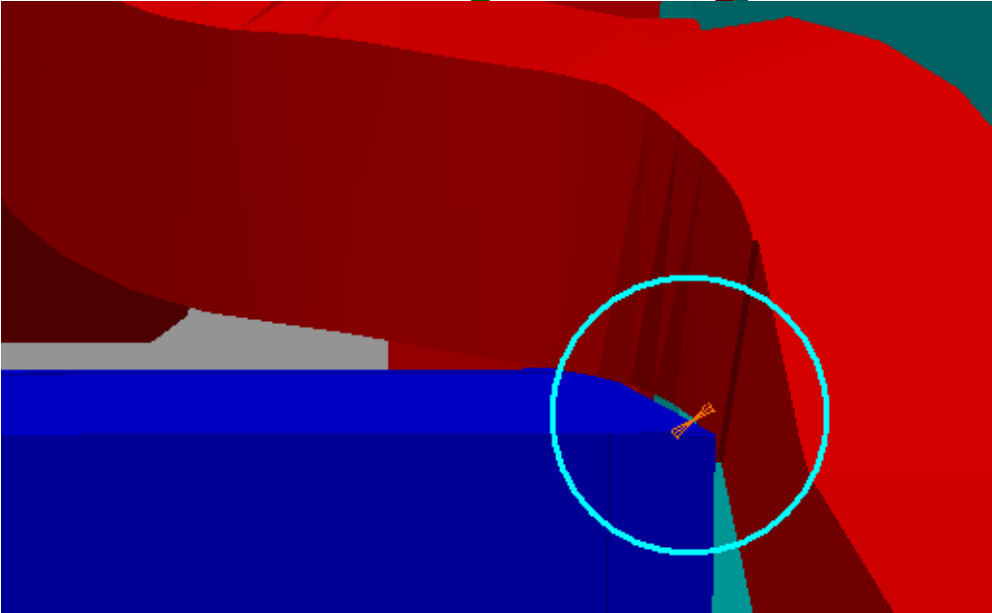
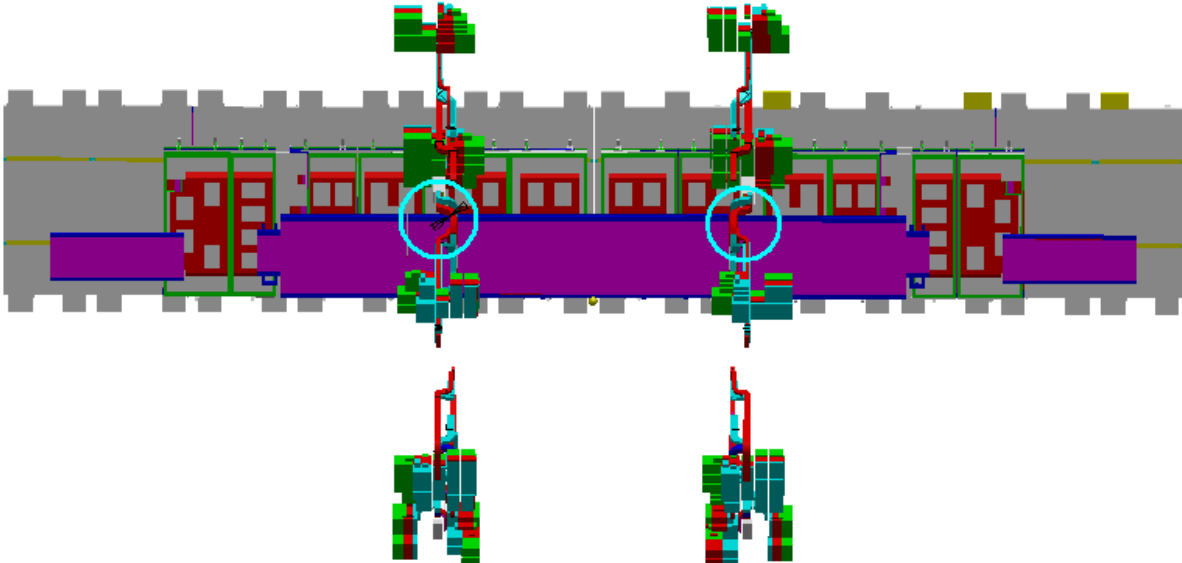

SIDE A-C
Sector 10

AT392112MQ - INNER DETECTOR PP2 + SERVICES	AT602342MQ - MUON BARREL CHAMBERS DETAILED, SECTOR 16	Clearance	16.3 mm			Not inspected
			$\Delta X \approx 0$	$\Delta Y \approx 0$	$\Delta Z \approx 16.3$	

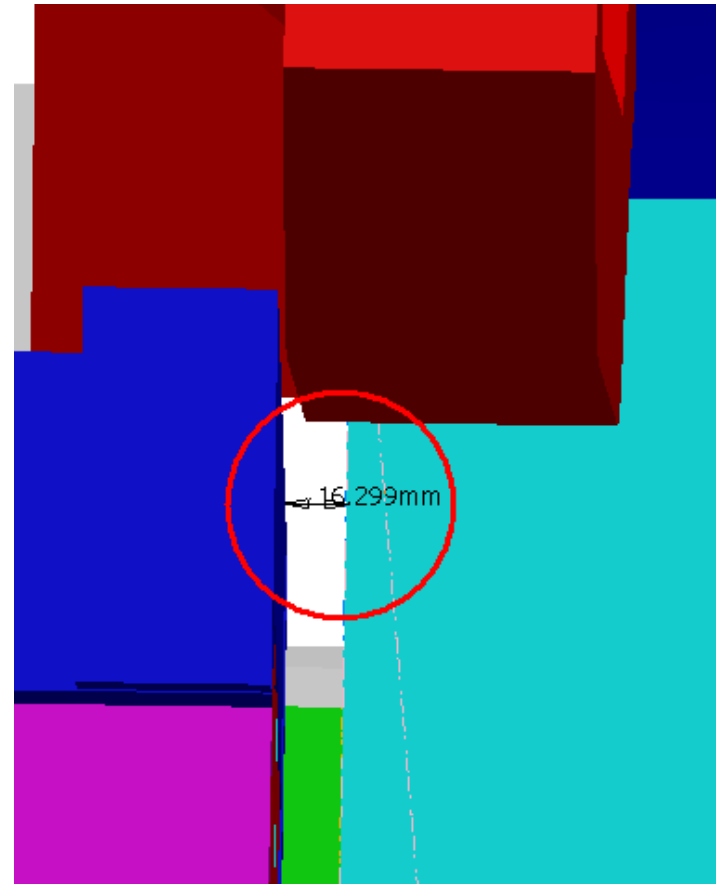
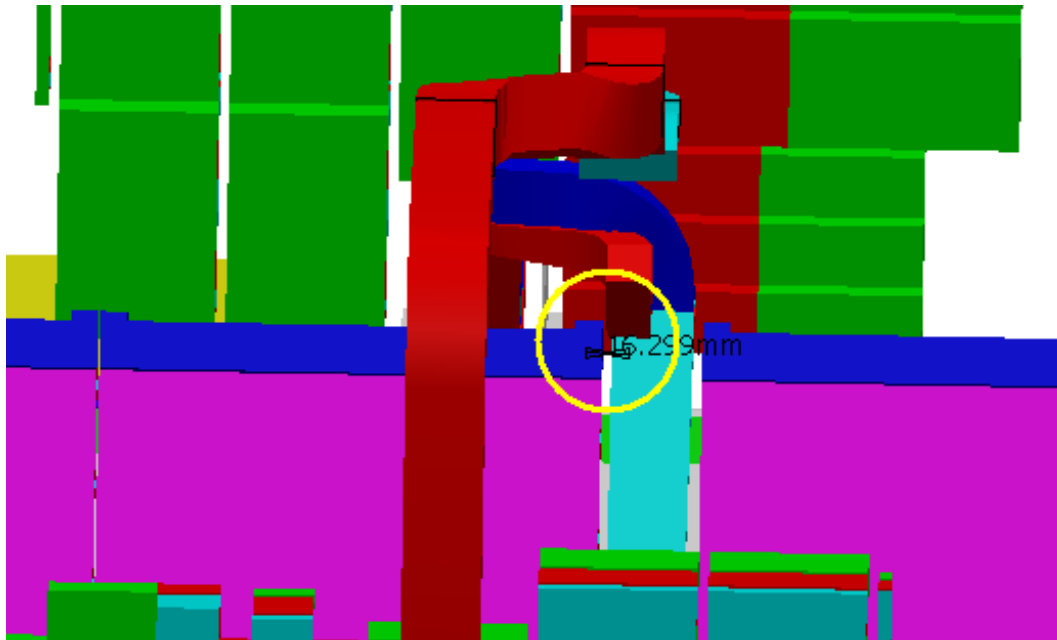
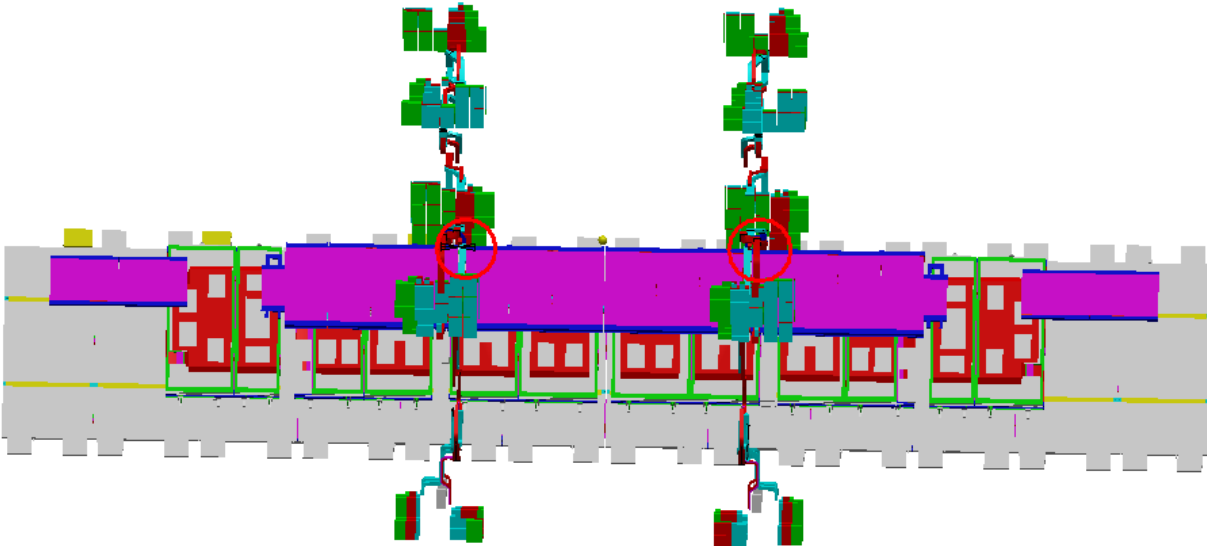

SIDE A-C
Sector 16

AT392112MQ - INNER DETECTOR PP2 + SERVICES	NMA_0014 - SECTOR 08 SIDE C (A) - REFERENCE ALIGNMENT SYSTEM AND	Clearance	34.7 mm			Not inspected
			$\Delta X \approx -34.7$	$\Delta Y \approx 0$	$\Delta Z \approx 0$	

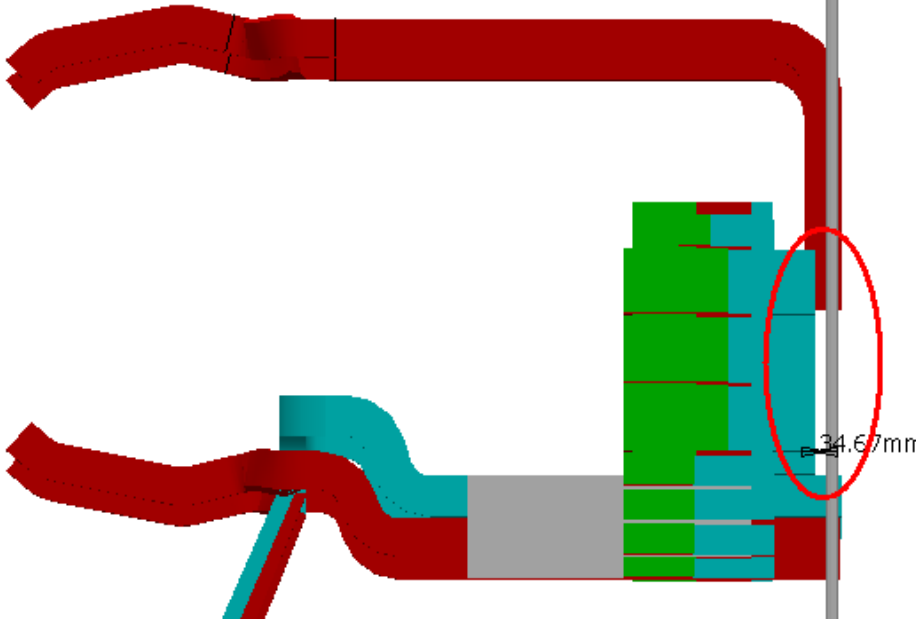
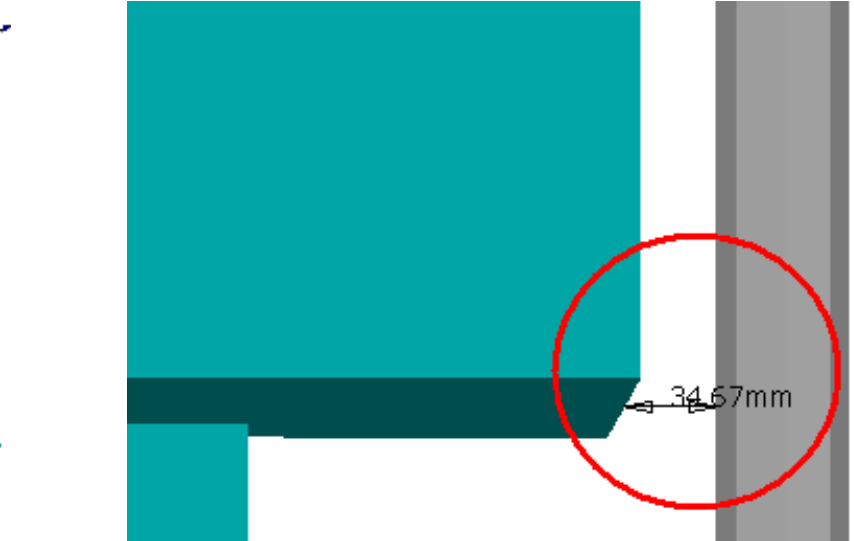
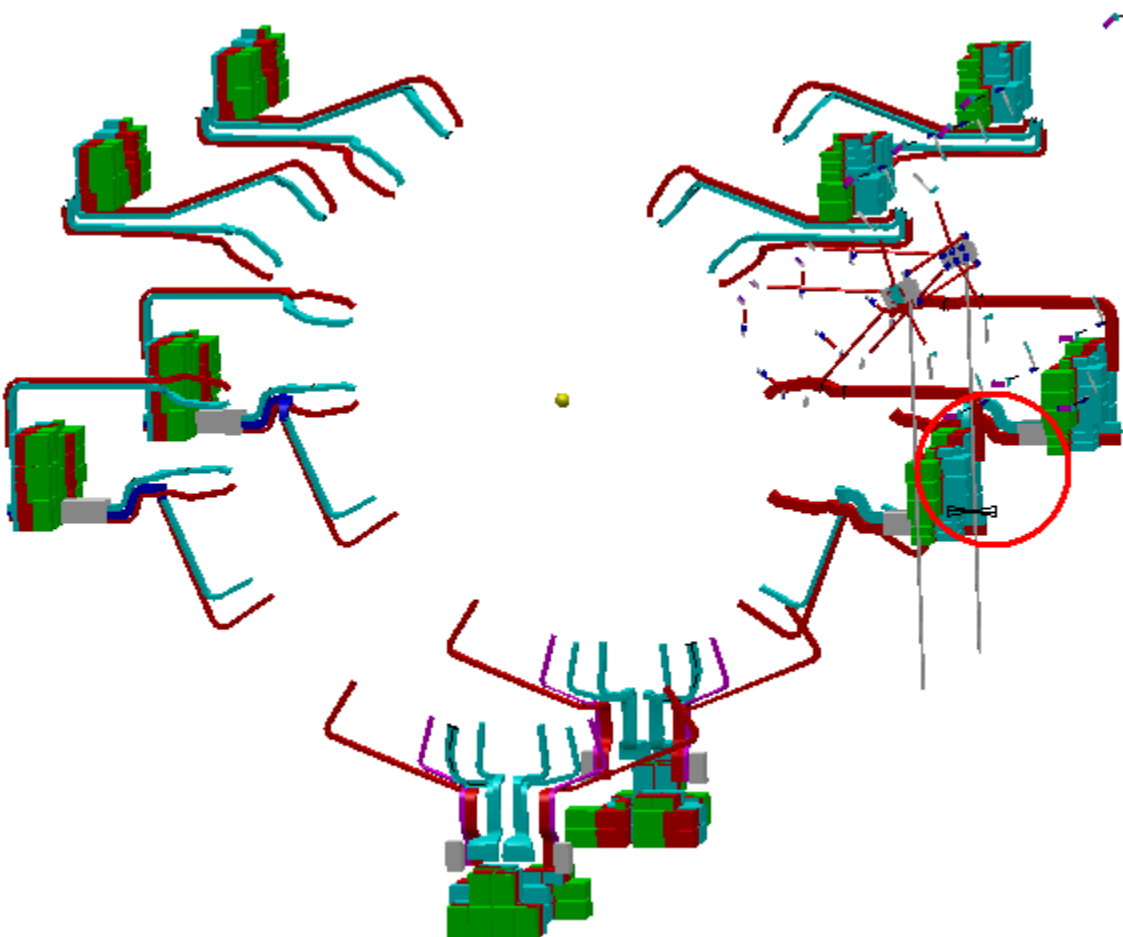

SIDE C
Sector 9

AT392112MQ - INNER DETECTOR PP2 + SERVICES	NMA_0015 - SECTOR 10 SIDE C (A) - REFERENCE ALIGNMENT SYSTEM AND	Clearance	34.3 mm			Not inspected
			$\Delta X \approx 0$	$\Delta Y \approx 0$	$\Delta Z \approx 34.3$	

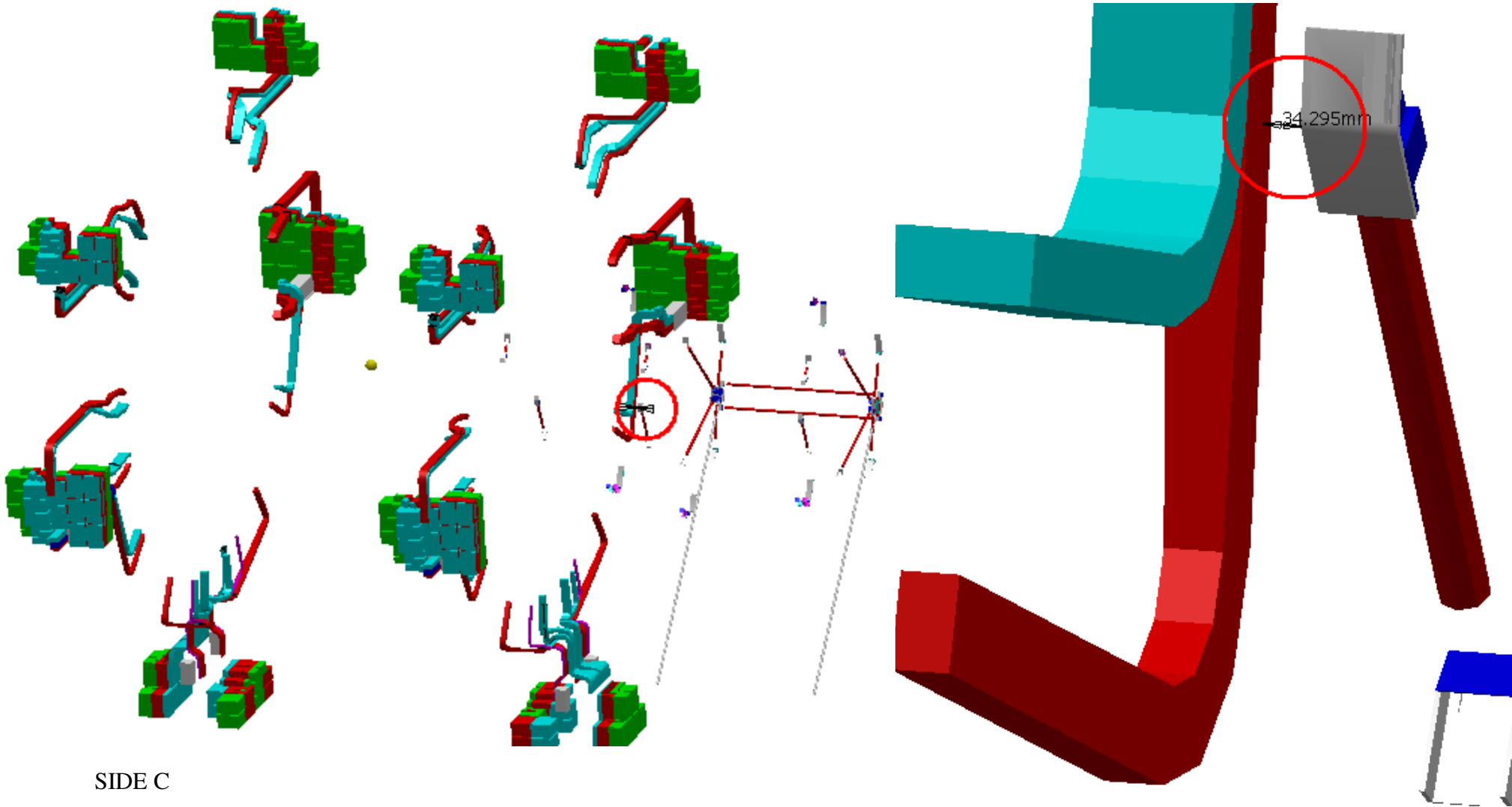

SIDE C
Sector 10

AT392112MQ - INNER DETECTOR PP2 + SERVICES	NMA_0018 - SECTOR 16 SIDE C (A) - REFERENCE ALIGNMENT SYSTEM AND	Clearance	37.6 mm			Not inspected
			$\Delta X \approx 0$	$\Delta Y \approx 0$	$\Delta Z \approx 37.6$	

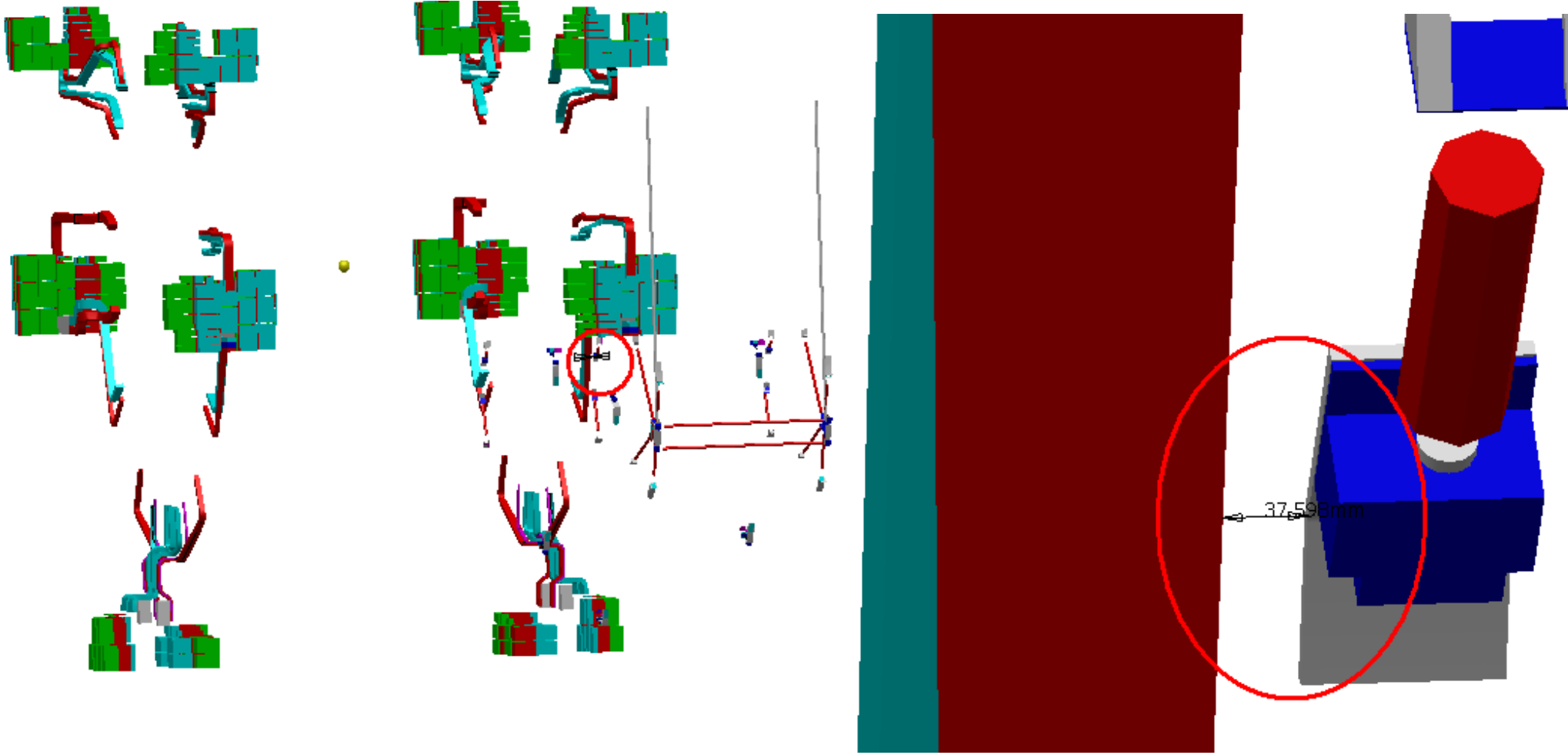

SIDE C
Sector 16

AT392112MQ - INNER DETECTOR PP2 + SERVICES	NSB_0002 - BARREL PROJECTIVE ALIGNMENT. - SIMPLE 3-D MODEL. SECTOR 3	Clearance	4.6 mm			Not inspected
			$\Delta X \approx 0$	$\Delta Y \approx 0$	$\Delta Z \approx -4.6$	

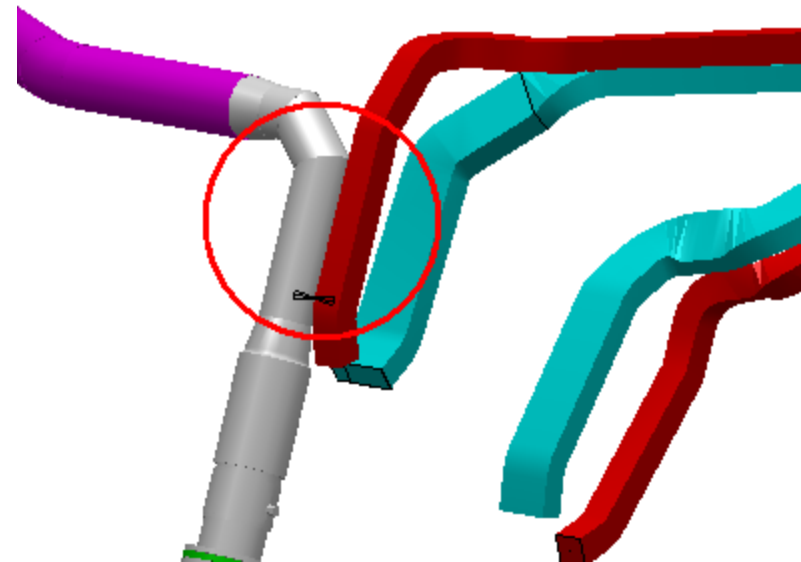
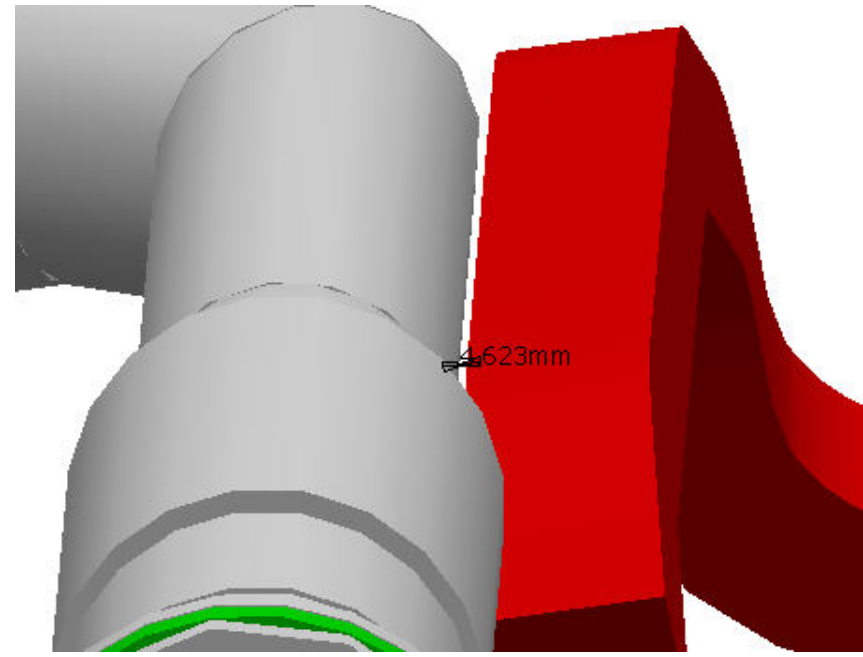
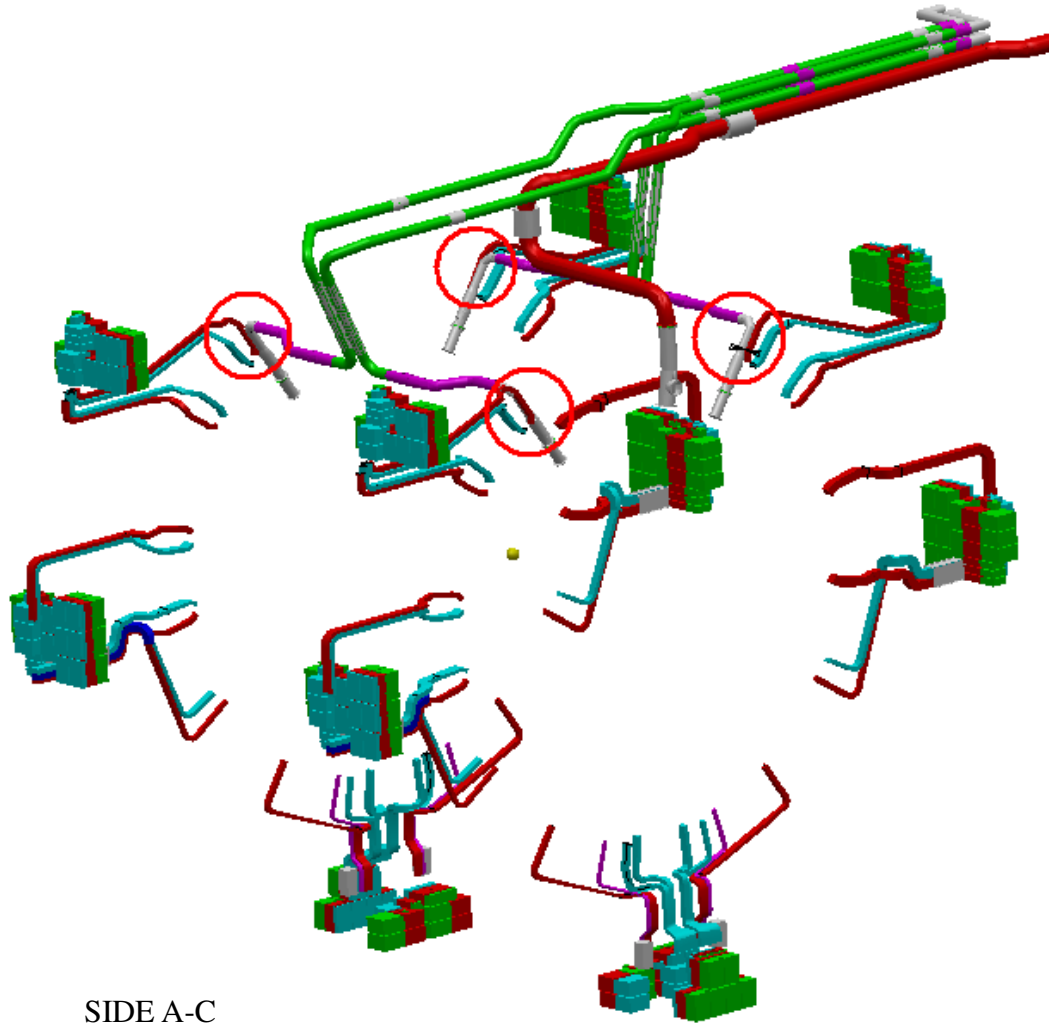

SIDE A-C
Sectors 3, 7

AT392112MQ - INNER DETECTOR PP2 + SERVICES	NSB_0007 - BARREL PROJECTIVE ALIGNMENT. - SIMPLE 3-D MODEL. SECTOR 13	Clearance	12.5 mm			Not inspected
			$\Delta X \approx 6.2$	$\Delta Y \approx -9$	$\Delta Z \approx -6.2$	

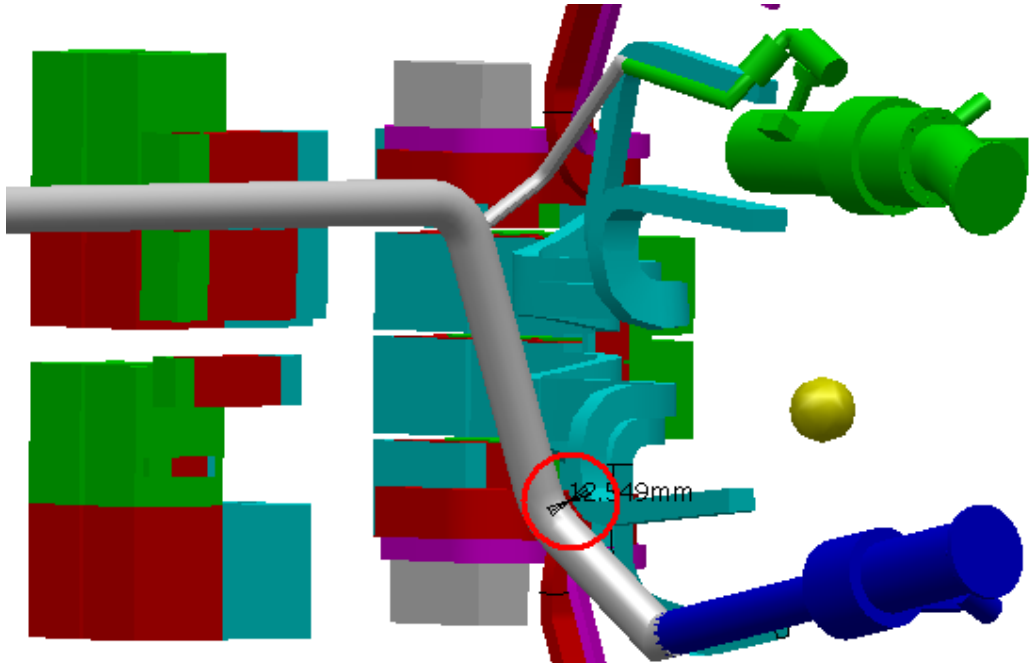
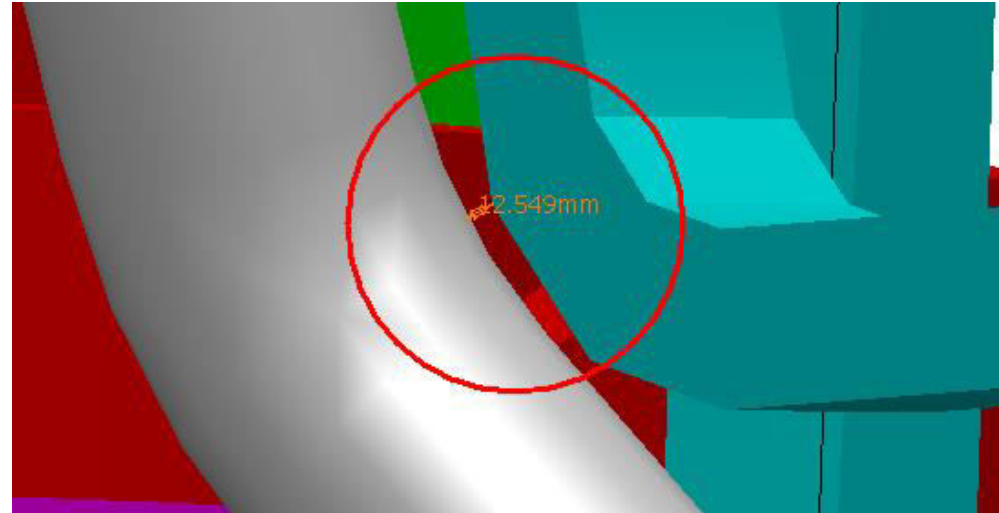
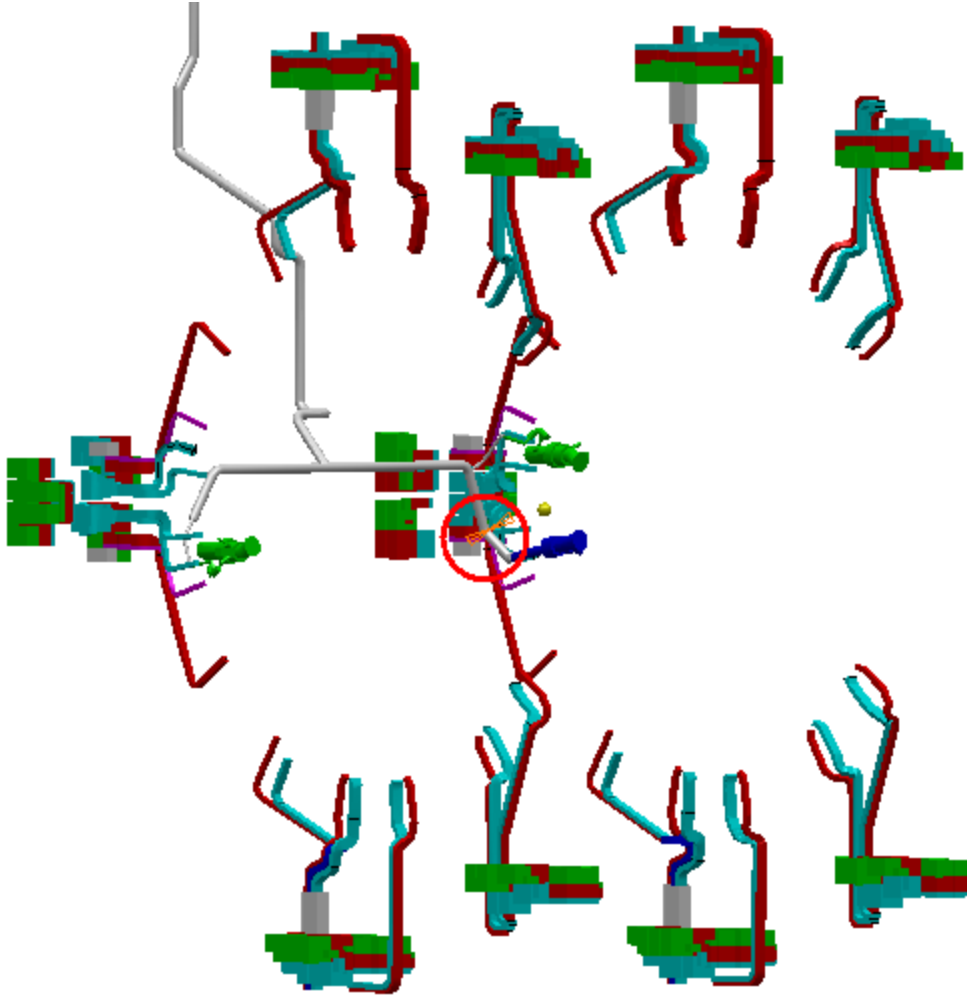

SIDE
Sector 13

AT392112MQ - INNER DETECTOR PP2 + SERVICES	NTB_0001 BT2 - TB STANDARD COIL - SECTOR 2	Clearance	42.6 mm			Not inspected
			$\Delta X \approx 0$	$\Delta Y \approx -42.6$	$\Delta Z \approx 0$	

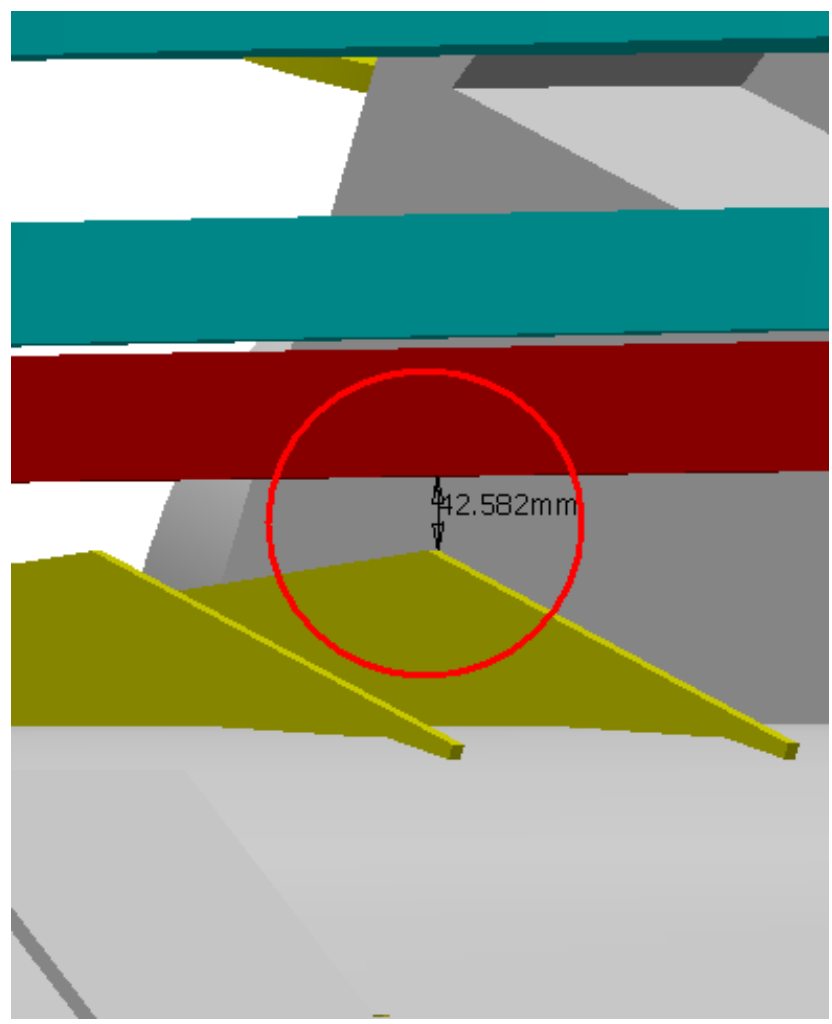
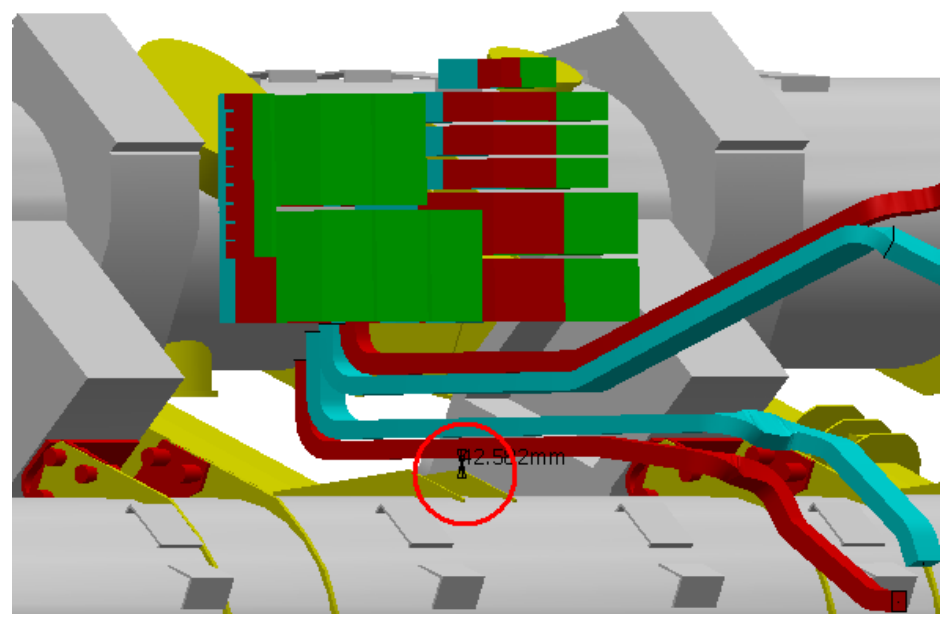
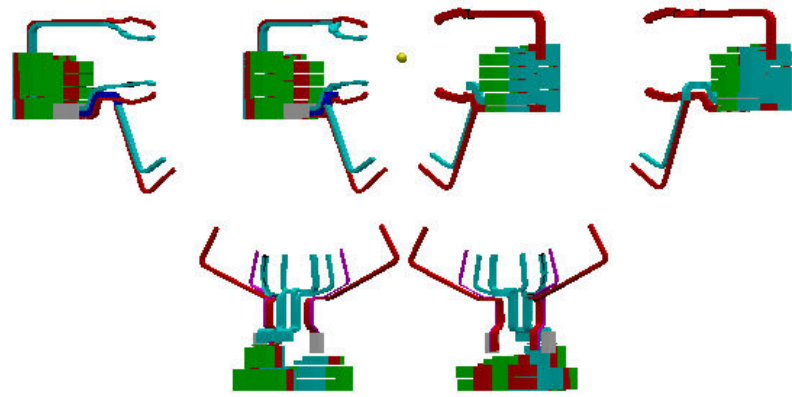
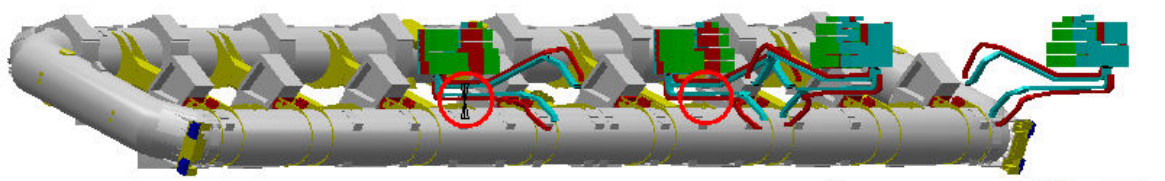

SIDE A-C
Sector 2

AT392112MQ - INNER DETECTOR PP2 + SERVICES	NTB_0001 BT8 - TB STANDARD COIL - SECTOR 8	Clearance	42.6 mm			Not inspected
			$\Delta X \approx 0$	$\Delta Y \approx -42.6$	$\Delta Z \approx 0$	

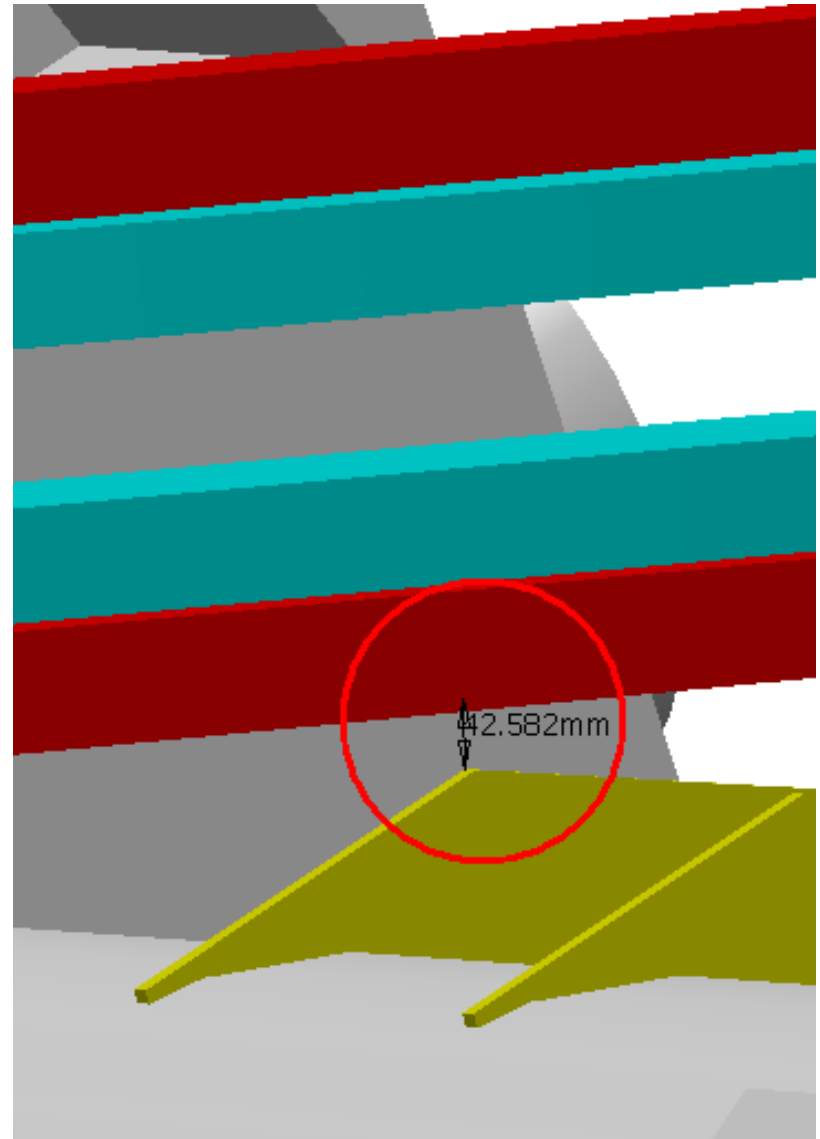
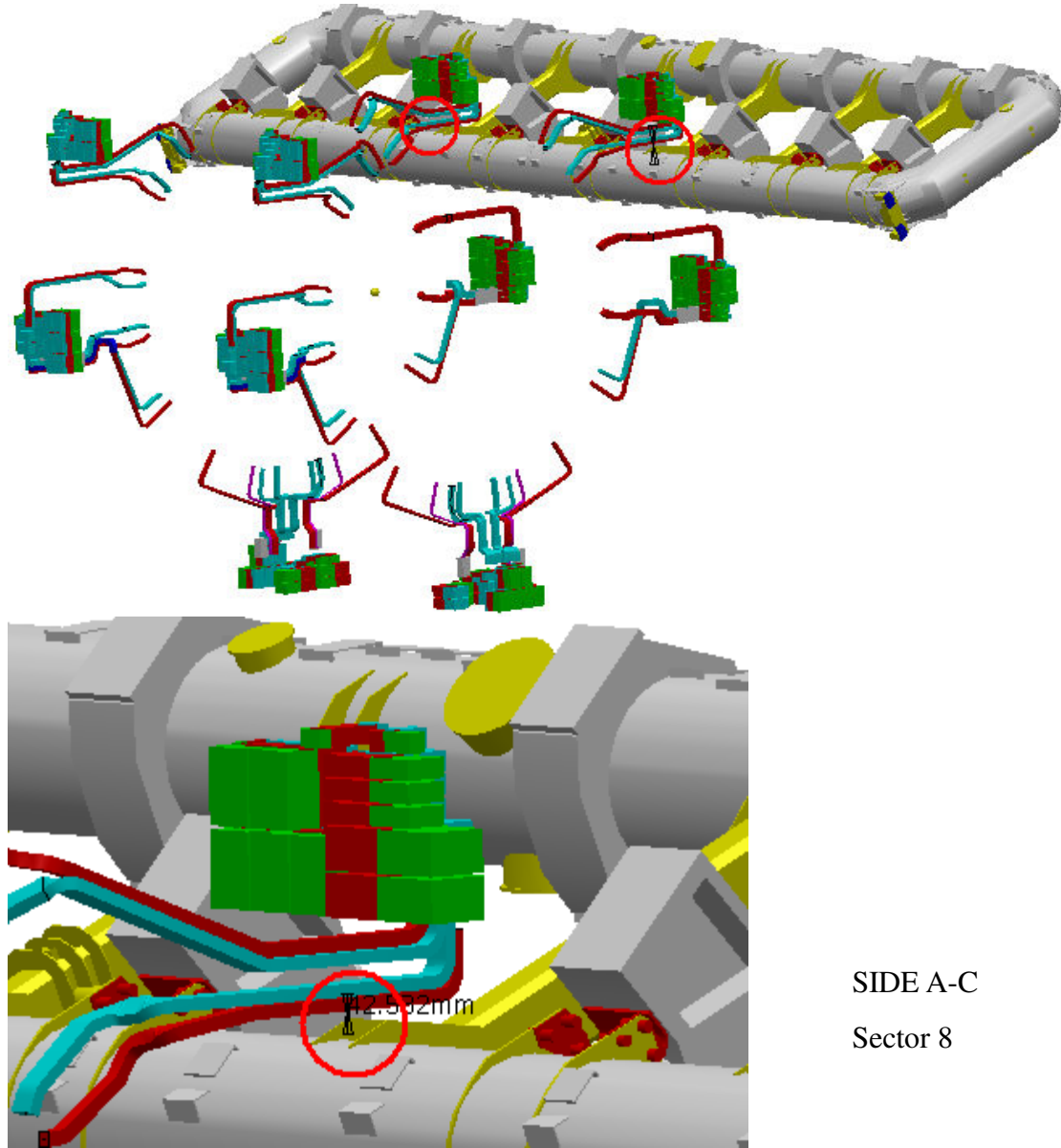

SIDE A-C
Sector 8

AT392112MQ - INNER DETECTOR PP2 + SERVICES	NTB_0001 BT10 - TB STANDARD COIL - SECTOR 10	Clearance	41.4 mm			Not inspected
			$\Delta X \approx -38.4$	$\Delta Y \approx -15.4$	$\Delta Z \approx 0$	

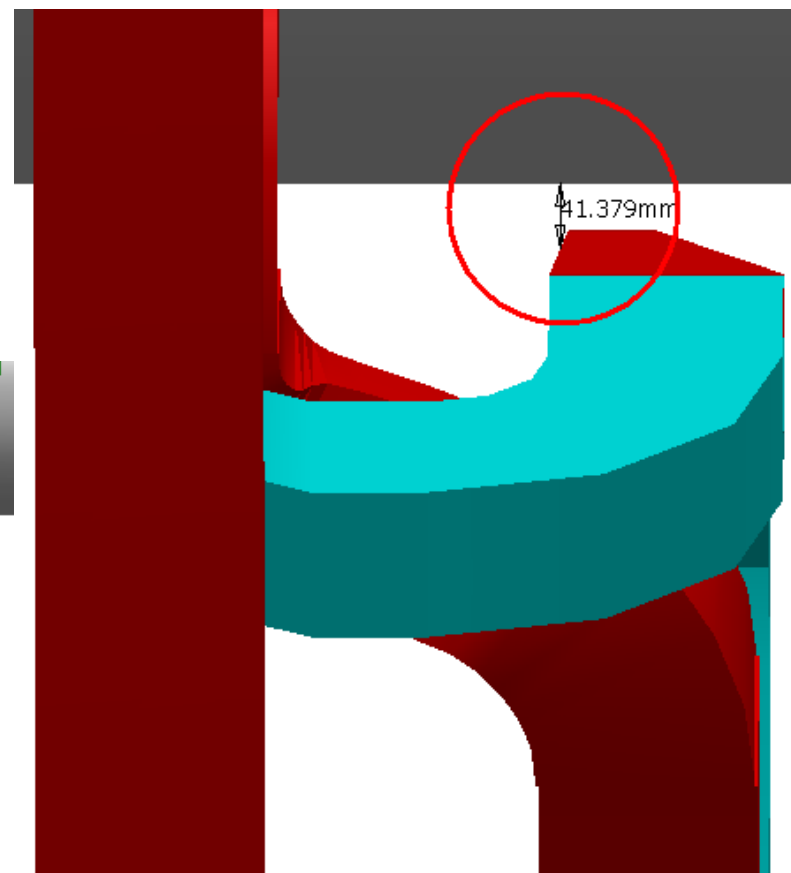
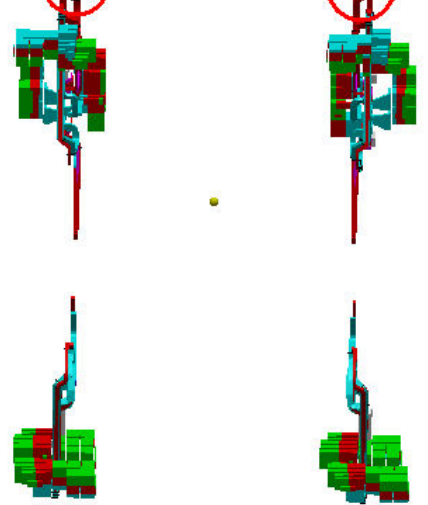
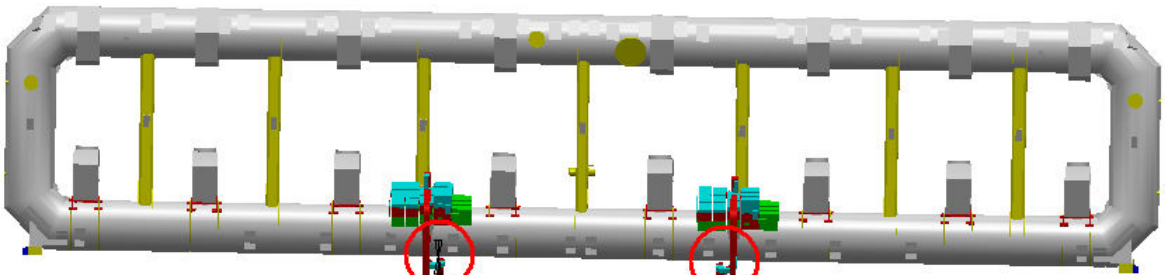

SIDE A-C
Sector 10